

**THE BOROUGH COUNCIL OF BOLTON**  
**ADOPTION OF ROADS INTO THE PUBLIC HIGHWAY**  
**HIGHWAYS ACT 1980 - SECTION 38**

**DECLARATION**

I, Dwayne Lowe, Assistant Director of Highways & Planning, pursuant to the powers delegated to me for and on behalf of the Borough Council of Bolton, hereby declare the street(s) named below, having been made up to the appropriate standard, to be highway(s) maintainable at the public expense and to be recorded as such in the register of adopted streets.

This adoption is pursuant to Section 38 of the Highways Act 1980.

**SCHEDULE**

<i>Name of Street</i>	<i>Description</i>	<i>Approximate Length</i>
<b>ACADEMY WAY (PART), LOSTOCK</b> USRN: 3406501	From its junction with the existing adopted section of Academy Way, for an approximate distance of 293 metres in an easterly direction. As shown in drawing: 28158-AD1	293.0 metres
<b>HARRIER CLOSE, LOSTOCK</b> USRN: 3406502	From its junction with Academy Way, northbound for an approximate distance of 85 metres and then 34.5 metres westbound and 235 metres eastbound, including 3 cul-de-sac side streets, 2 footpaths to Academy Way and the emergency access path to Hawkers Lane. As shown in drawing: 28158-AD2	498.0 metres
<b>HAWKERS LANE, LOSTOCK</b> USRN: 3406504	From its junction with Academy Way, north-eastbound for an approximate distance of 112 metres. As shown in drawing: 28158-AD3	112.0 metres
<b>SKY LARK CLOSE, LOSTOCK</b> USRN: 3406505	From its junction with Academy Way, northbound for an approximate distance of 88.5 metres and then 110 metres eastbound to its turning head/cul-de-sac end. As shown in drawing: 28158-AD4	198.5 metres

<b>FOXHUNTER CLOSE, LOSTOCK</b> USRN: 3406506	From its junction with Sky Lark Close, eastbound for an approximate distance of 114 metres to its turning head/cul-de-sac end. As shown in drawing: 28158-AD5	114.0 metres
--	---	--------------

SIGNED:



DATE:

**15 April 2025**

.....  
Dwayne Lowe CEng FCIHT FIHE  
Assistant Director – Highways and Planning

Highways & Engineering Division  
Paderborn House  
Civic Centre  
Bolton BL1 1UA

**Bolton  
Council**

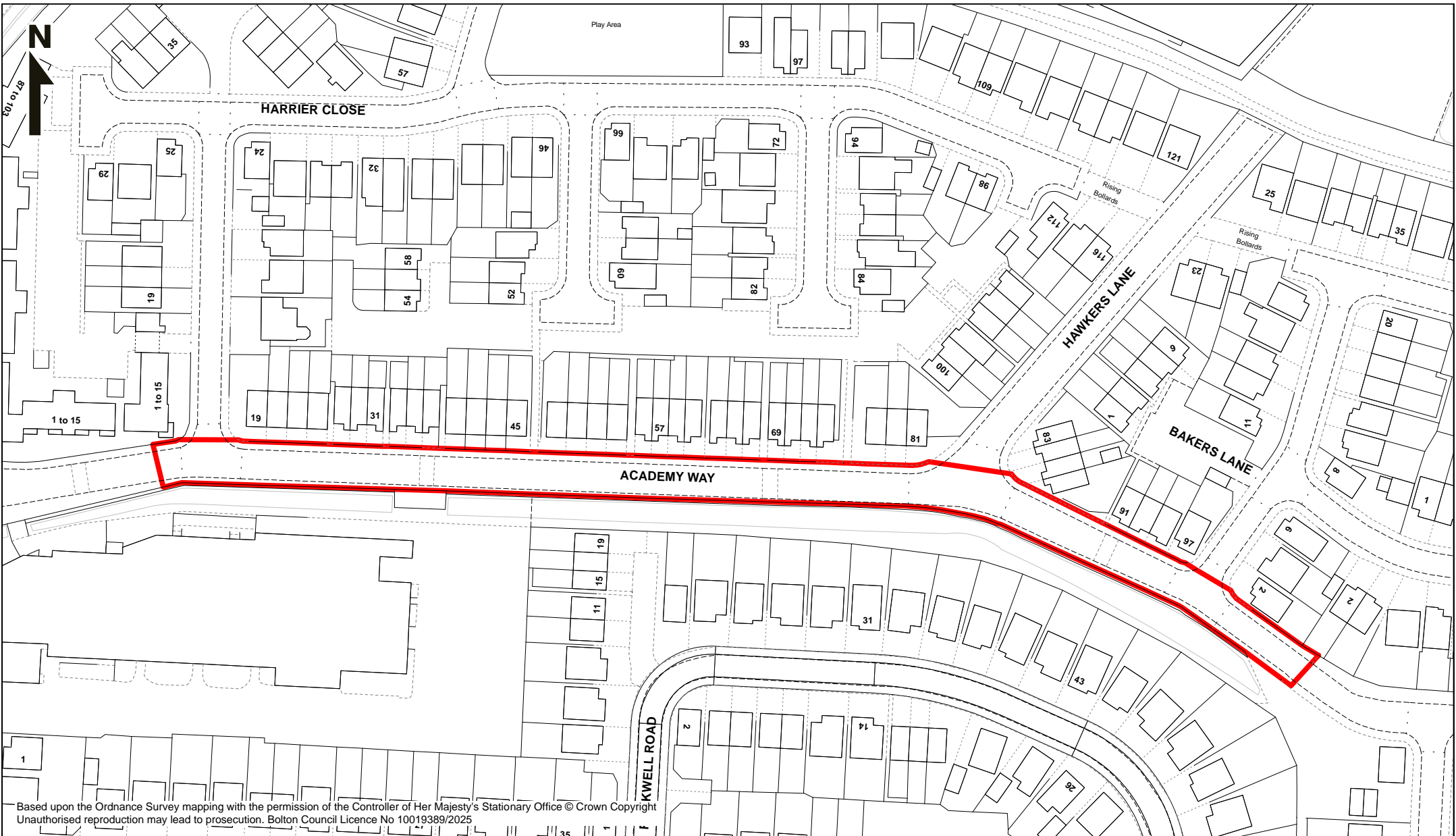

Based upon the Ordnance Survey mapping with the permission of the Controller of Her Majesty's Stationary Office © Crown Copyright  
 Unauthorised reproduction may lead to prosecution. Bolton Council Licence No 10019389/2025

**Bolton Council**

Highways & Engineering  
 Bolton Council  
 Paderborn House  
 Civic Centre  
 Bolton BL1 1UA

Jon Dyson  
 Director of Place

**ADOPTION OF ROADS INTO  
 THE PUBLIC HIGHWAY  
 HIGHWAYS ACT 1980 - SECTION 38**

**Academy Way, Lostock  
 (Part)**

 HIGHWAY TO BE ADOPTED

Scale 1:1250 at A4

Drawn By PDHouse

Date 14 APR 2025

Dwg No. 28158-AD1

COACHFIELD DRIVE

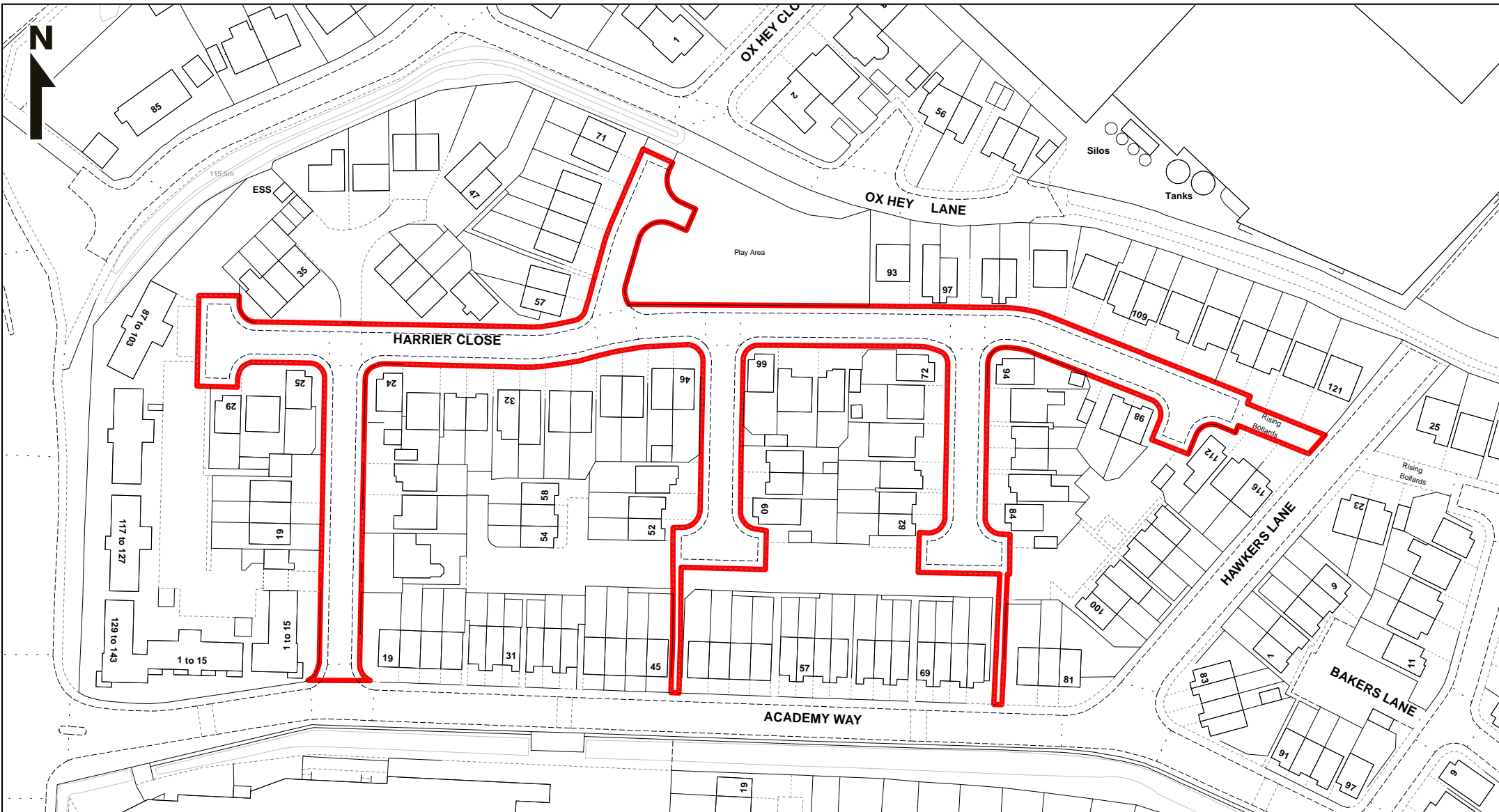

Based upon the Ordnance Survey mapping with the permission of the Controller of Her Majesty's Stationary Office © Crown Copyright  
 Unauthorised reproduction may lead to prosecution. Bolton Council Licence No 10019389/2025

**Bolton Council**

Highways & Engineering  
 Bolton Council  
 Paderborn House  
 Civic Centre  
 Bolton BL1 1UA

Jon Dyson  
 Director of Place

**ADOPTION OF ROADS INTO  
 THE PUBLIC HIGHWAY  
 HIGHWAYS ACT 1980 - SECTION 38**

**Harrier Close, Lostock**

 HIGHWAY TO BE ADOPTED

Scale 1:1250 at A4

Drawn By PDHouse

Date 14 APR 2025

Dwg No. 28158-AD2

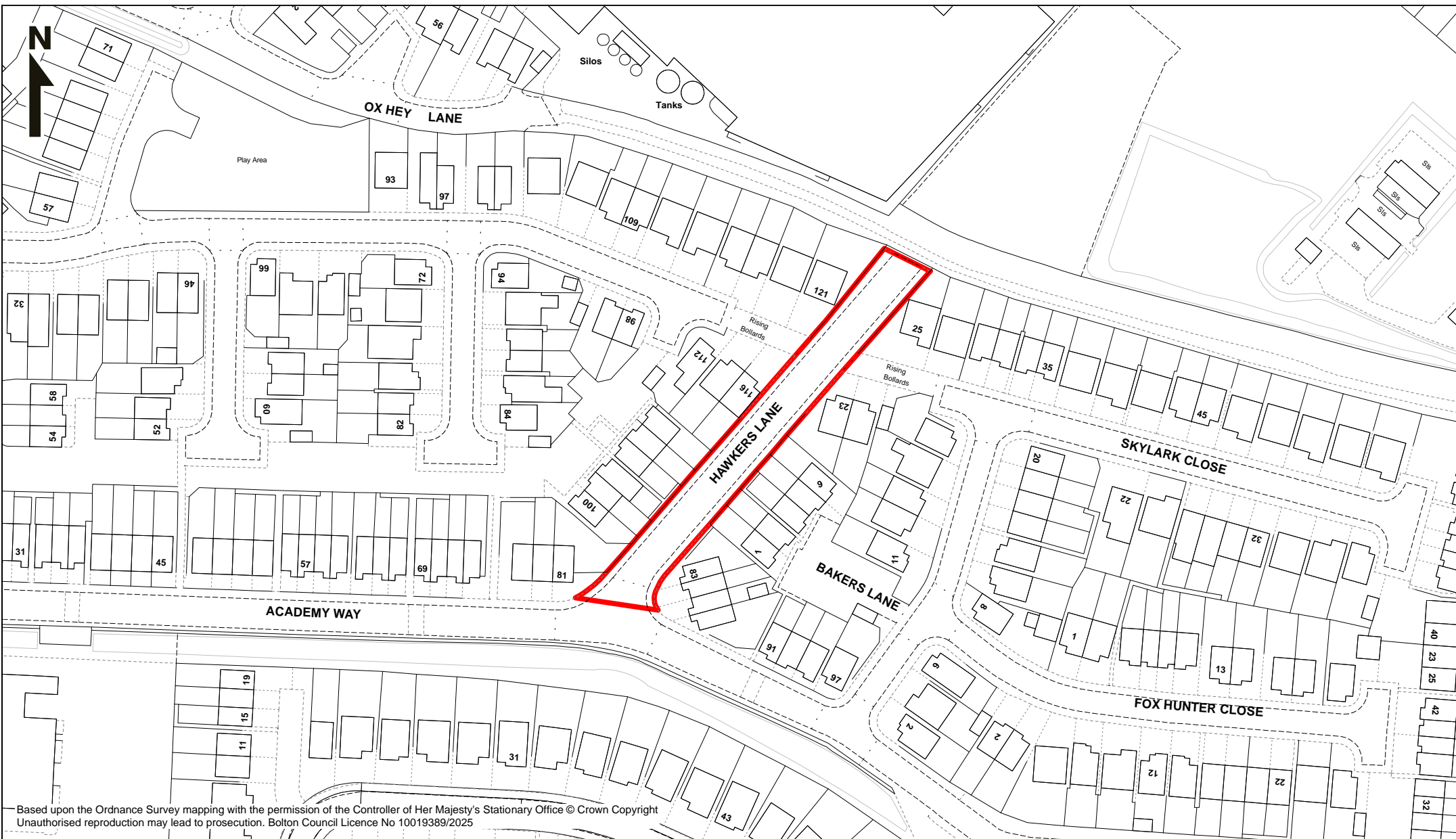

Based upon the Ordnance Survey mapping with the permission of the Controller of Her Majesty's Stationary Office © Crown Copyright  
 Unauthorised reproduction may lead to prosecution. Bolton Council Licence No 10019389/2025

**Bolton Council**

Highways & Engineering  
 Bolton Council  
 Paderborn House  
 Civic Centre  
 Bolton BL1 1UA

Jon Dyson  
 Director of Place

**ADOPTION OF ROADS INTO  
 THE PUBLIC HIGHWAY  
 HIGHWAYS ACT 1980 - SECTION 38**

**Hawkers Lane, Lostock**

 HIGHWAY TO BE ADOPTED

Scale	1:1250 at A4
Drawn By	PDHouse
Date	14 APR 2025
Dwg No.	28158-AD3

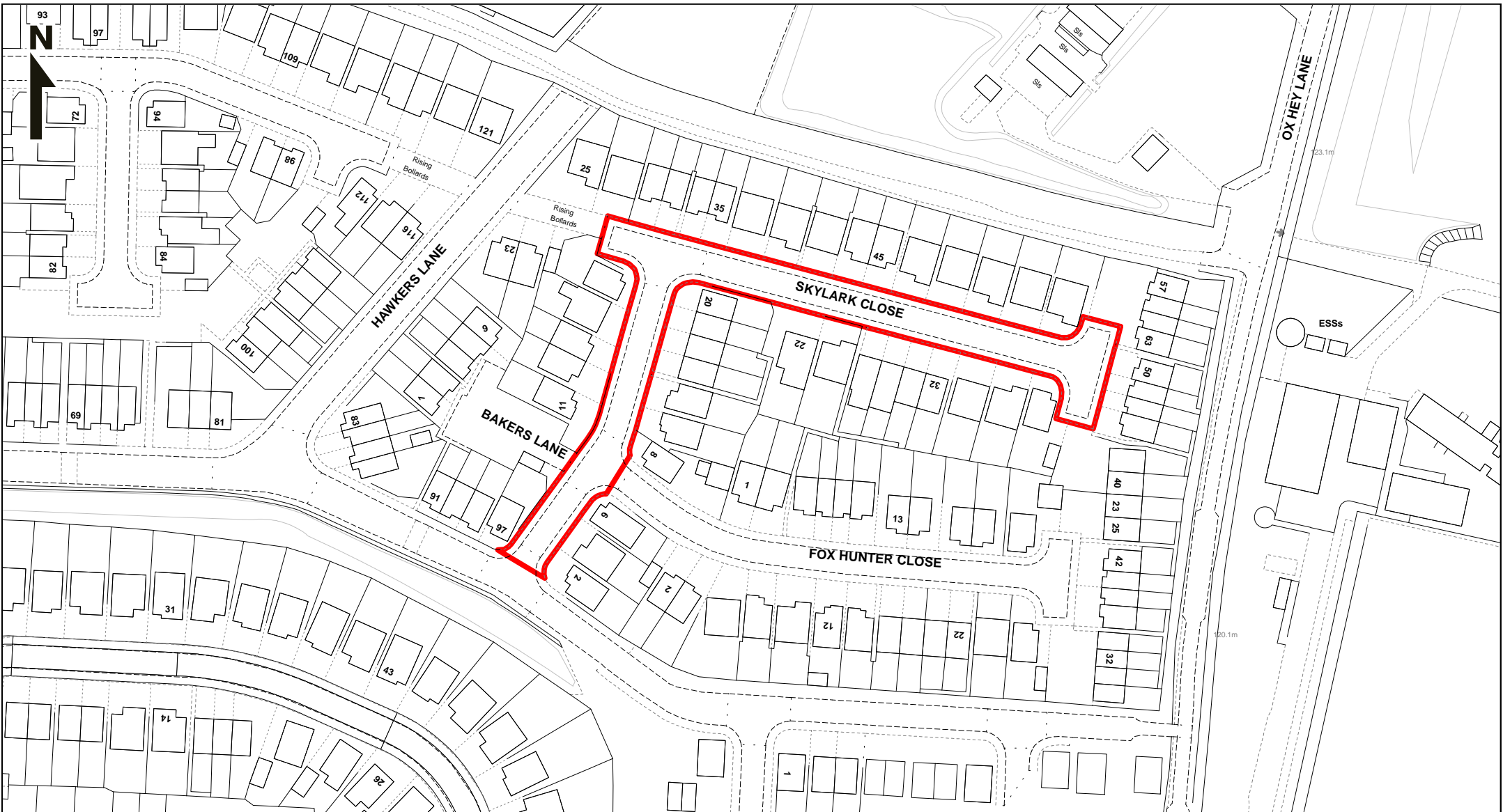

Based upon the Ordnance Survey mapping with the permission of the Controller of Her Majesty's Stationary Office © Crown Copyright  
 Unauthorised reproduction may lead to prosecution. Bolton Council Licence No 10019389/2025

Bolton Wanderers  
 Eddie Davies  
 Football Academy

**Bolton Council**

Highways & Engineering  
 Bolton Council  
 Paderborn House  
 Civic Centre  
 Bolton BL1 1UA

Jon Dyson  
 Director of Place

**ADOPTION OF ROADS INTO  
 THE PUBLIC HIGHWAY  
 HIGHWAYS ACT 1980 - SECTION 38**

**Sky Lark Close, Lostock**

 HIGHWAY TO BE ADOPTED

Scale 1:1250 at A4

Drawn By PDHouse

Date 14 APR 2025

Dwg No. 28158-AD4

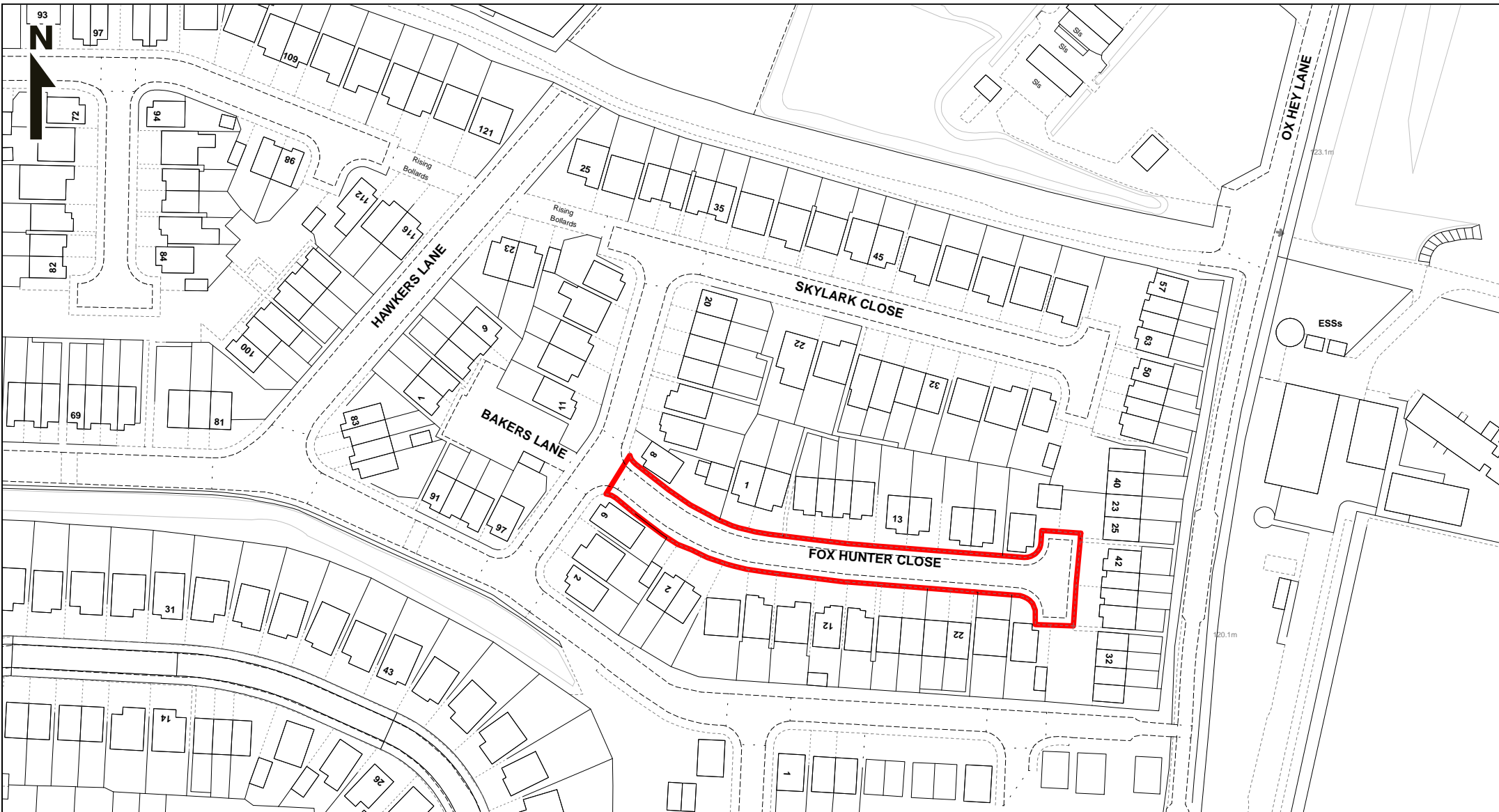

Based upon the Ordnance Survey mapping with the permission of the Controller of Her Majesty's Stationary Office © Crown Copyright  
 Unauthorised reproduction may lead to prosecution. Bolton Council Licence No 10019389/2025

Bolton Wanderers  
 Eddie Davies  
 Football Academy

**Bolton Council**

Highways & Engineering  
 Bolton Council  
 Paderborn House  
 Civic Centre  
 Bolton BL1 1UA

Jon Dyson  
 Director of Place

**ADOPTION OF ROADS INTO  
 THE PUBLIC HIGHWAY  
 HIGHWAYS ACT 1980 - SECTION 38**

**Foxhunter Close, Lostock**

 HIGHWAY TO BE ADOPTED

Scale 1:1250 at A4

Drawn By PDHouse

Date 14 APR 2025

Dwg No. 28158-AD5