

ROAD CLOSURE

**Bolton
Council**

NOTIFICATION OF TEMPORARY ROAD CLOSURE ROAD TRAFFIC REGULATION ACT 1984

STREET

Plodder Lane

DATES

28 APR 2025 for 1 week approx

(end date and duration are subject to change)

REASON / WORKS

Resurfacing

**Advertised public notice below
Diversion plans (if available) are attached**

THE BOROUGH COUNCIL OF BOLTON
ROAD TRAFFIC REGULATION ACT 1984 S.14

The Council intends to make an order, operative from 28 April 2025 for 1 week approx, the effect of which will be to prohibit all traffic proceeding on Plodder Lane from St Helens Rd to Smethurst Lane, to allow resurfacing works to take place. Alternate route for traffic will be signed. The Order will end after 18 months or on completion of the works whichever first occurs.

Bolton Council. 7 April 2025.



If your waste or recycling bins are due to be emptied during road or resurfacing works, please present them at the nearest accessible point. This will ensure that your bins can be emptied on the usual collection day.

closures online at bolton.gov.uk/trafficorders

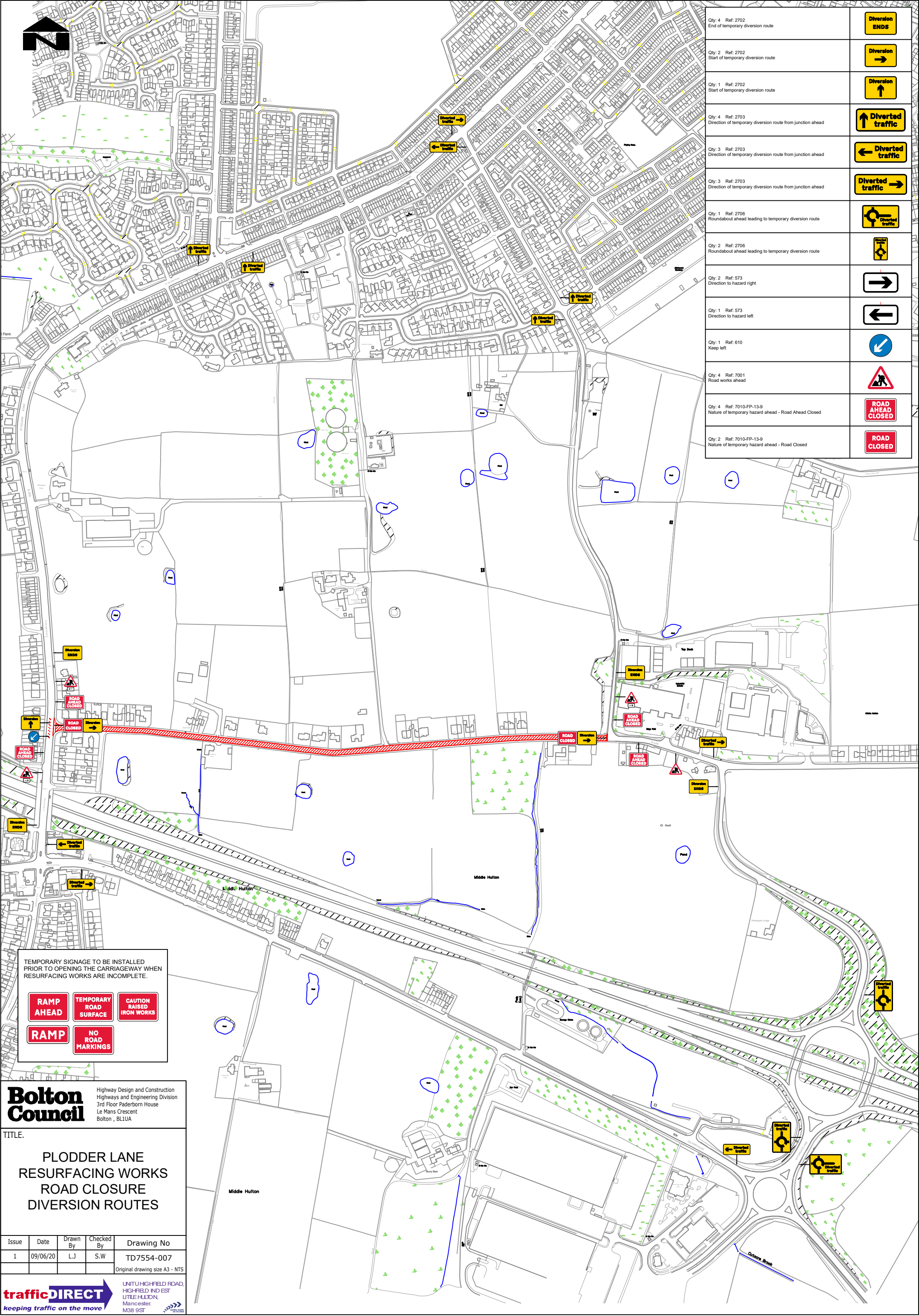

Qty: 4 Ref: 2702 End of temporary diversion route	<div>Diversion ENDS</div>
Qty: 2 Ref: 2702 Start of temporary diversion route	<div>Diversion →</div>
Qty: 1 Ref: 2702 Start of temporary diversion route	<div>Diversion ↑</div>
Qty: 4 Ref: 2703 Direction of temporary diversion route from junction ahead	<div>↑ Diverted traffic</div>
Qty: 3 Ref: 2703 Direction of temporary diversion route from junction ahead	<div>← Diverted traffic</div>
Qty: 3 Ref: 2703 Direction of temporary diversion route from junction ahead	<div>Diverted traffic →</div>
Qty: 1 Ref: 2706 Roundabout ahead leading to temporary diversion route	<div>Roundabout Diverted traffic</div>
Qty: 2 Ref: 2706 Roundabout ahead leading to temporary diversion route	<div>Roundabout Diverted traffic</div>
Qty: 2 Ref: 573 Direction to hazard right	<div>→</div>
Qty: 1 Ref: 573 Direction to hazard left	<div>←</div>
Qty: 1 Ref: 610 Keep left	<div>Keep left</div>
Qty: 4 Ref: 7001 Road works ahead	<div>Road works ahead</div>
Qty: 4 Ref: 7010-FP-13-9 Nature of temporary hazard ahead - Road Ahead Closed	<div>ROAD AHEAD CLOSED</div>
Qty: 2 Ref: 7010-FP-13-9 Nature of temporary hazard ahead - Road Closed	<div>ROAD CLOSED</div>

TEMPORARY SIGNAGE TO BE INSTALLED PRIOR TO OPENING THE CARRIAGEWAY WHEN RESURFACING WORKS ARE INCOMPLETE.

- RAMP AHEAD

TEMPORARY ROAD SURFACE

CAUTION RAISED IRON WORKS

RAMP

NO ROAD MARKINGS

Bolton Council

Highway Design and Construction
Highways and Engineering Division
3rd Floor Paderborn House
Le Mans Crescent
Bolton , BL1UA

TITLE.

PLODDER LANE
RESURFACING WORKS
ROAD CLOSURE
DIVERSION ROUTES

Issue	Date	Drawn By	Checked By	Drawing No
1	09/06/20	L.J	S.W	TD7554-007

Original drawing size A3 - NTS

trafficDIRECT

keeping traffic on the move

UNIT 1 HIGHFIELD ROAD,
HIGHFIELD IND EST
LITTLE HULTON,
Manchester.
M38 9ST