

ROAD CLOSURE

**Bolton
Council**

NOTIFICATION OF TEMPORARY ROAD CLOSURE ROAD TRAFFIC REGULATION ACT 1984

STREET

Back Hilden Street

DATES

12 MAR 2025 for 2 days approx

(end date and duration are subject to change)

REASON / WORKS

Highway repair works

**Advertised public notice below
Diversion plans (if available) are attached**

THE BOROUGH COUNCIL OF BOLTON
ROAD TRAFFIC REGULATION ACT 1984 S.14

The Council intends to make an order, operative from 12 March 2025 for 2 days approx, the effect of which will be to prohibit all traffic proceeding on Back Hilden Street from Selwyn St to Birch St, to allow carriageway repair works to take place. The Order will end after 18 months or on completion of the works whichever first occurs.

Bolton Council. 19 February 2025.



If your waste or recycling bins are due to be emptied during road or resurfacing works, please present them at the nearest accessible point. This will ensure that your bins can be emptied on the usual collection day.

closures online at bolton.gov.uk/trafficorders

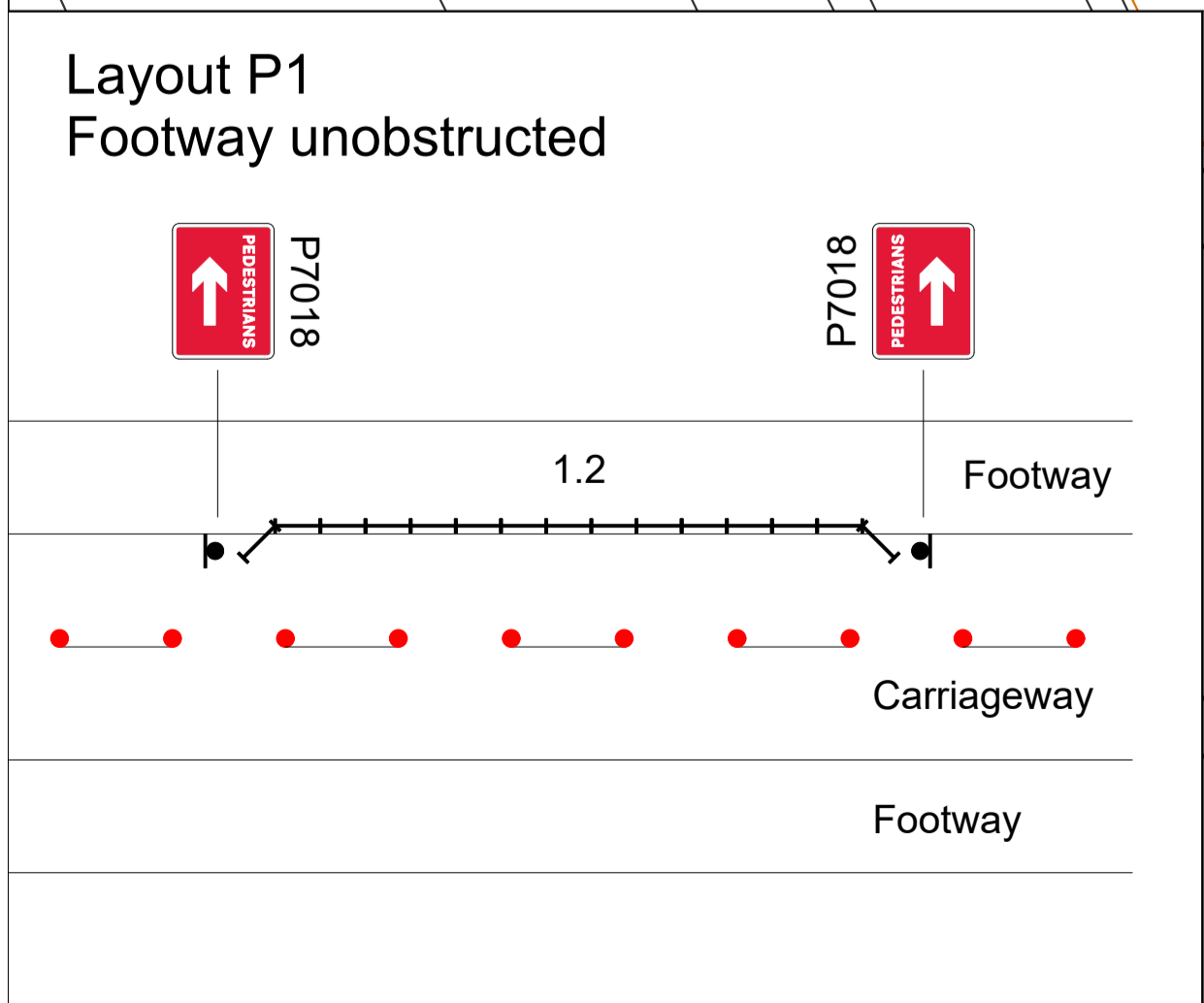
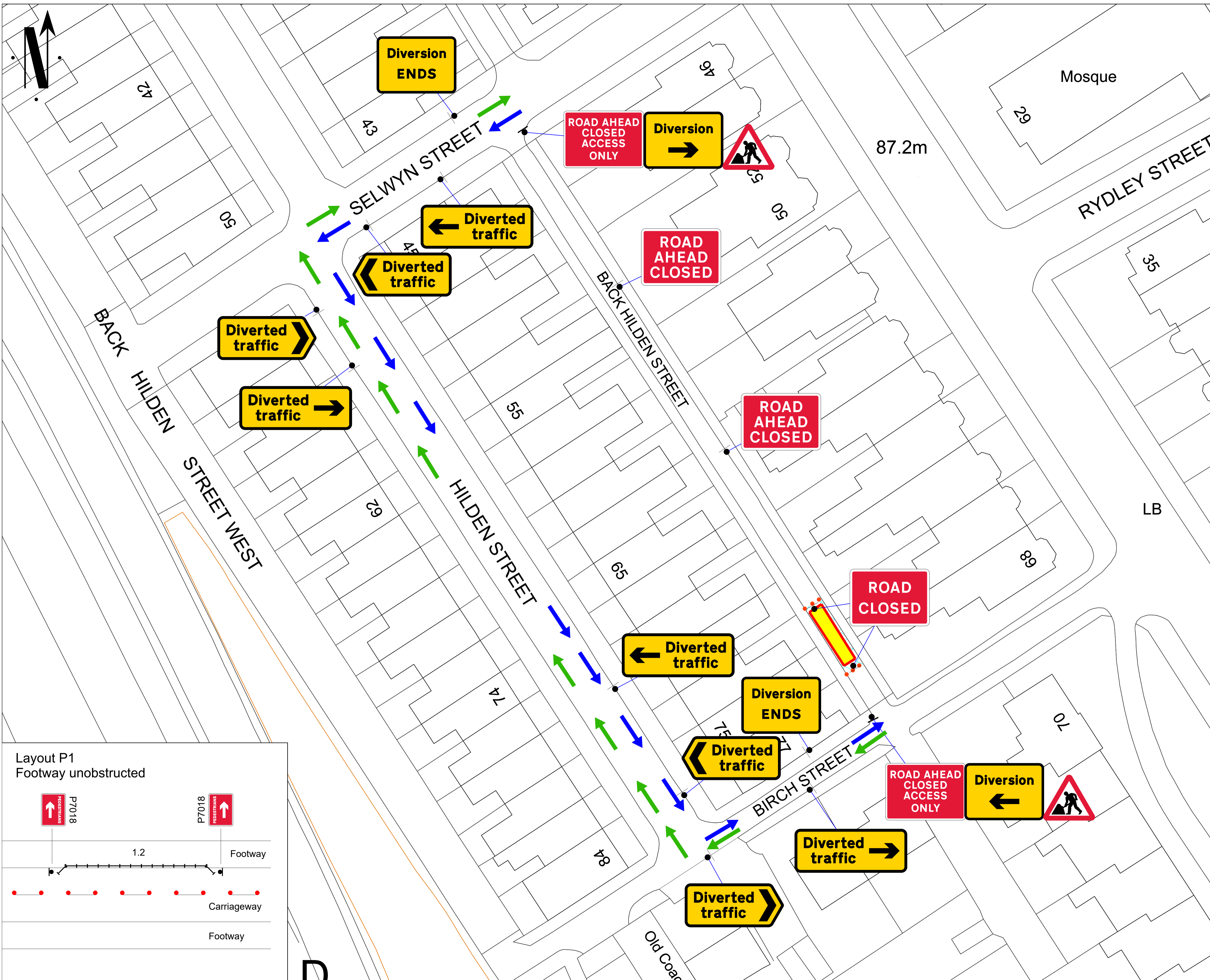

Go Traffic Management

This drawing has been produced for a specific client & project identified below and is not intended for use by any other person or for any other purpose. © Go Traffic Management

Risks

- Design completed from information provided + google maps desktop risk assessment
- Cone lamps must be used on all road with A speed limit of 40mph or more.

Notes

- All signs as per Chapter 8. Distances between cones to be 9m maximum unless otherwise noted.
- Distances between signs NOT to scale for purpose of clarity.
- All sign placement subject to available safe working space.
- The purpose of the Traffic Management Plan is for it to be used only as a guide and all traffic management equipment should be put out according to the 'Safety at Street Works and Road Works - Code of Practice', i.e. Red Book & the 'Traffic Signs Manual Chapter 8', i.e. Yellow Book.
- Signs must be placed in accordance with TSM and the scheme RAMS pack.
- Site conditions may have changed since the design of the drawing any changes which subsequently affect the design need to be reported by the Traffic Management Operative & any changes implemented must comply with Chapter 8.

Key

- Sign position and aspect of vision
- Working Space
- Working Area
- Diversion Route 1
- Diversion Route 2

Traffic Management must comply with The Safety at Street Works and Road Works Code of Practice

WRITTEN DIVERSION ROUTE:
Back Hilden Street Closed. Traffic Diverted Via Selwyn Street <-> Hilden Street <-> Birch Street.

WRITTEN DIVERSION ROUTE:
Back Hilden Street Closed. Traffic Diverted Via Birch Street <-> Hilden Street <-> Selwyn Street.

ROAD SPEED

30

CROSS SECTION

ROAD CLOSURE

DO NOT SCALE FROM THIS DRAWING.	ROAD CLOSURE	
A	18/06/24	AS DRAWN
REV.	DATE	DESCRIPTION

GTM
Go Traffic Management

Head Office: Go Traffic Management,
Chaddock Lane, Worsley, Manchester, M28 1XW
Tel: 0161 351 5370
www.gtm.co.uk

TRAFFIC MANAGEMENT PLAN

Client: **Network Plus**

Drawing Number: 1014262

Drawing Title: 75 Hilden Street, Bolton, BL2 1JD

	Design:	Technical Officer:	REV:
Name:	A.Bolan	L.Corcoran	
Signature:			
Date:	18/06/24	18/06/24	