

ROAD CLOSURE

**Bolton
Council**

NOTIFICATION OF TEMPORARY ROAD CLOSURE ROAD TRAFFIC REGULATION ACT 1984

STREET

Lords Stile Lane

DATES

10 MAR 2025 for 5 days approx

(end date and duration are subject to change)

REASON / WORKS

Electricity works

**Advertised public notice below
Diversion plans (if available) are attached**

THE BOROUGH COUNCIL OF BOLTON
ROAD TRAFFIC REGULATION ACT 1984 S.14

The Council intends to make an order, operative from 10 March 2025 for 5 days approx, the effect of which will be to prohibit all traffic from proceeding on Lords Stile Lane from Bromley Cross Rd to The Crescent to allow for electricity works. Alternate route for traffic will be via Windsor Rd, Darwen Rd. The Order will end after 18 months or on completion of the works whichever first occurs.

Bolton Council. 17 February 2025.



If your waste or recycling bins are due to be emptied during road or resurfacing works, please present them at the nearest accessible point. This will ensure that your bins can be emptied on the usual collection day.

closures online at bolton.gov.uk/trafficorders

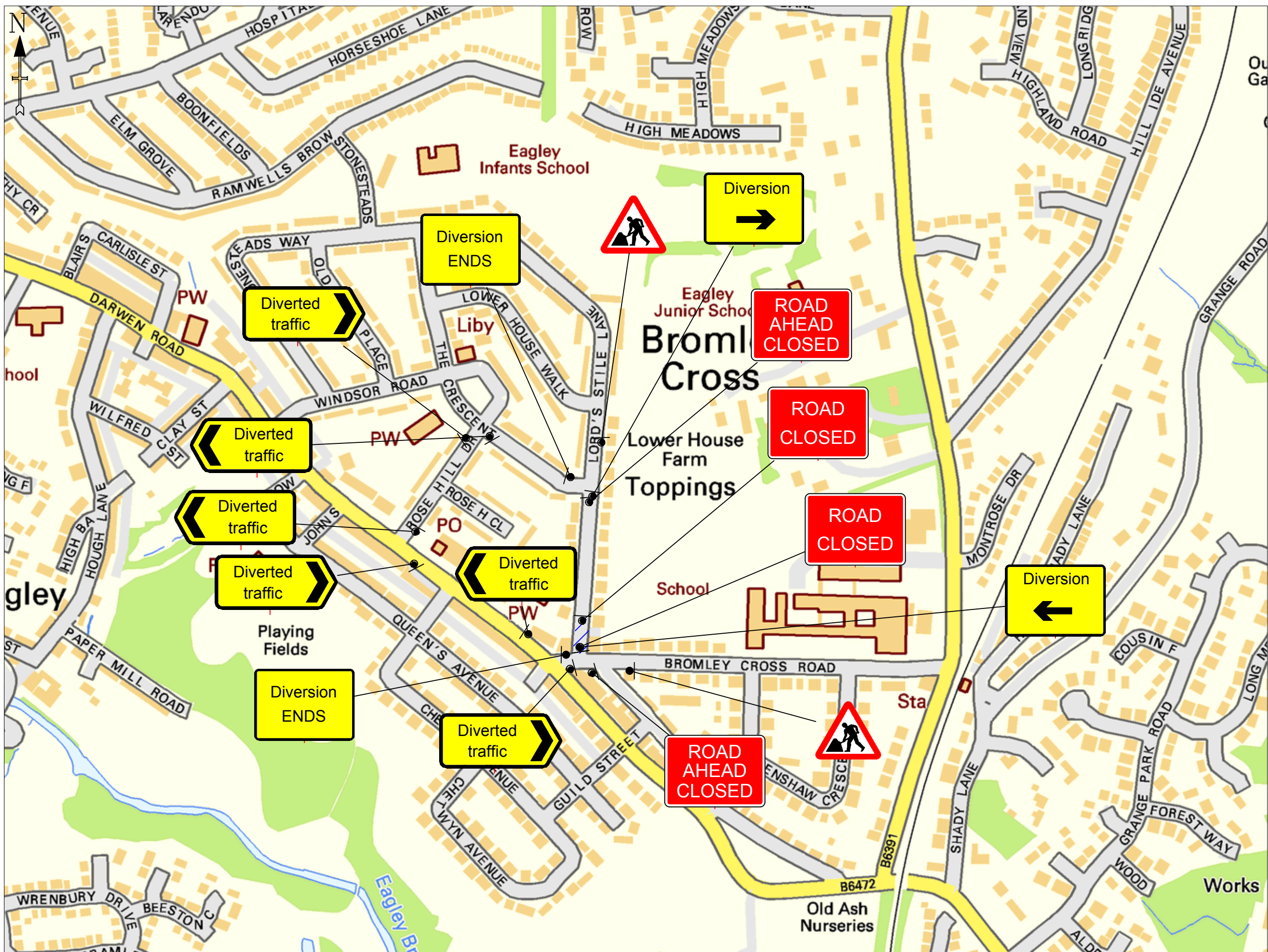

DETAIL B (B)

Single/Dual carriageway 40mph or less - 450mm traffic cones, spacing 1.5m.
 Single/Dual carriageway 50mph or more - 750mm traffic cones, spacing 1.5m.
 Dual carriageway national speed limit - 750mm traffic cones, spacing 1.5m, relaxation 3m.

Notes:
 1) During darkness, warning lights to BS EN 12352:2006 should be provided in accordance with Table A1.3 (Appendix 1).
 2) 45° tapers have 1.5m spacing, no relaxations.
 3) On motorways and NSL AP duals with hard shoulders, 1m cones will be required for both standard and relaxation works for lead tapers and the facing wall of lane changes.

DETAIL D (D)

Single/Dual carriageway 40mph or less - 450mm traffic cones.
 Single/Dual carriageway 50mph or more - 750mm traffic cones.

Notes:
 1) During darkness, warning lights to BS EN 12352:2006 should be provided in accordance with Table A1.3 (Appendix 1).
 2) Detail D applies only to relaxation cases.

	Standard: Normal traffic including buses and HGVs	Restricted: Cars and light vehicles only
Two-way working	6.75 m minimum	5.5 m minimum
Shuttle working	3.25-3.50 m desirable width range	3.25 m desirable minimum width
	3.0 m absolute minimum	2.5 m absolute minimum

Specials -



Notes -

DIVERSION ROUTE - THE CRESCENT, ROSE HILL DRIVE, DARWEN ROAD

KEY

- Traffic sign
- Traffic cone
- Traffic signals to Diagram 3000.1
- Working Space
- Pedestrian Barrier

TEMPORARY
TRAFFIC MANAGEMENT
30 MPH

Issue	Date
1	10.12.24
Drawn By	MM

ROAD CLOSURE + DIVERSION
BROMLEY CROSS ROAD BL7 9LS

Original drawing size A3 - NTS

Drawing Ref: 5500291918