

# ROAD CLOSURE

**Bolton  
Council**

## NOTIFICATION OF TEMPORARY ROAD CLOSURE ROAD TRAFFIC REGULATION ACT 1984

STREET

**Back Mason Street**

DATES

**03 MAR 2025 for 2 days approx**

(end date and duration are subject to change)

REASON / WORKS

**Manhole repair works**

**Advertised public notice below  
Diversion plans (if available) are attached**

THE BOROUGH COUNCIL OF BOLTON  
ROAD TRAFFIC REGULATION ACT 1984 S.14

The Council intends to make an order, operative from 3 March 2025 for 2 days approx, the effect of which will be to prohibit all traffic from proceeding on Back Mason Street from Richmond St to Queen St to allow manhole repair works to take place. The Order will end after 18 months or on completion of the works whichever first occurs.

Bolton Council. 10 February 2025.



If your waste or recycling bins are due to be emptied during road or resurfacing works, please present them at the nearest accessible point. This will ensure that your bins can be emptied on the usual collection day.

**closures online at [bolton.gov.uk/trafficorders](https://bolton.gov.uk/trafficorders)**

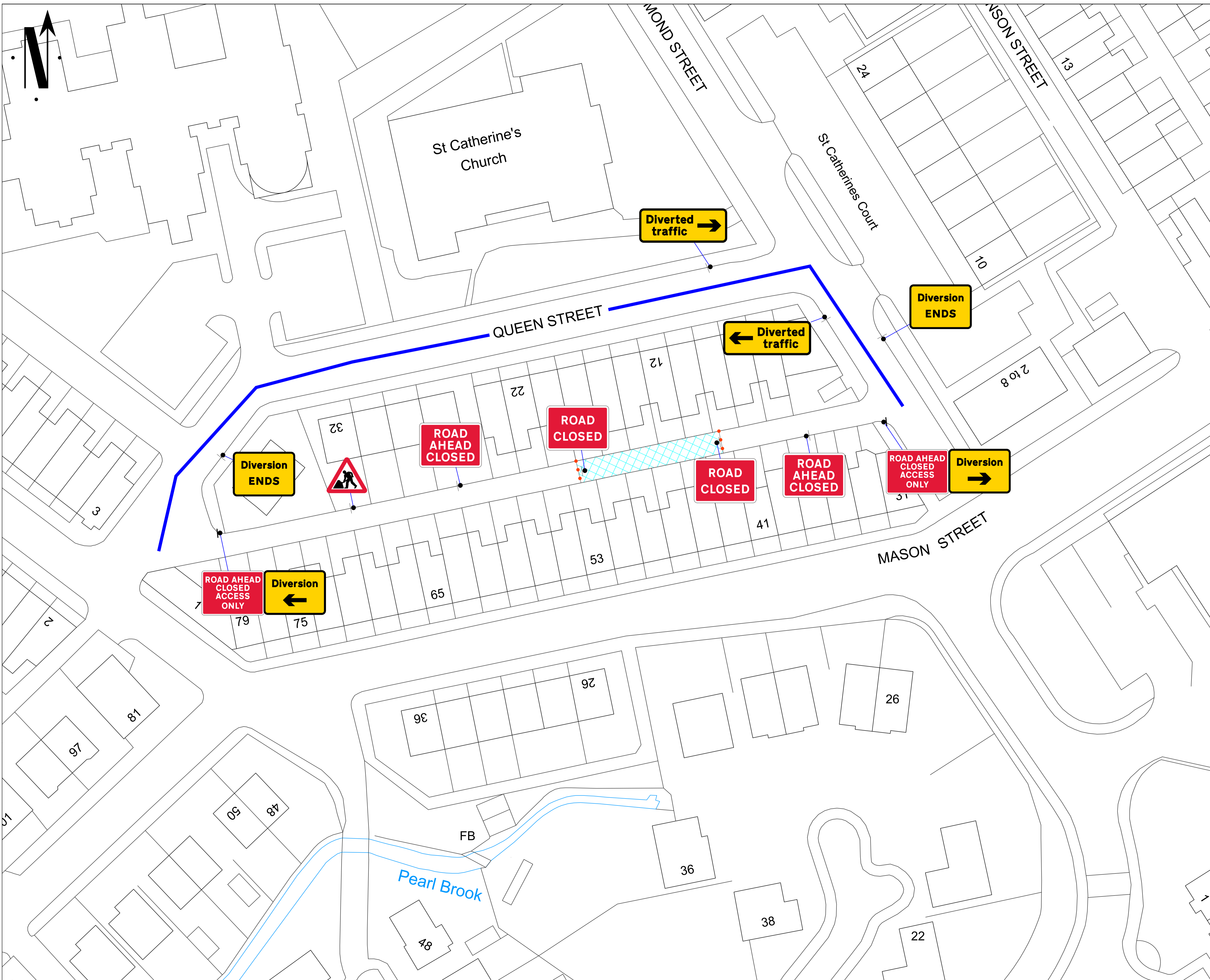

**Go Traffic Management**

This drawing has been produced for a specific client & project identified below and is not intended for use by any other person or for any other purpose. © Go Traffic Management

**Risks:**

- Design completed from information provided + google maps desktop risk assessment
- Cone lamps must be used on all road with A speed limit of 40mph or more.

**Notes:**

- All signs as per Chapter 8. Distances between cones to be 9m maximum unless otherwise noted.
- Distances between signs NOT to scale for purpose of clarity.
- All sign placement subject to available safe working space.
- The purpose of the Traffic Management Plan is for it to be used only as a guide and all traffic management equipment should be put out according to the 'Safety at Street Works and Road Works - Code of Practice', i.e. Red Book & the 'Traffic Signs Manual Chapter 8', i.e. Yellow Book.
- Signs must be placed in accordance with TSM and the scheme RAMS pack.
- Site conditions may have changed since the design of the drawing any changes which subsequently affect the design need to be reported by the Traffic Management Operative & any changes implemented must comply with Chapter 8.

**Key**

- Sign position and aspect of vision
- Work area
- Diversion Route 1

**Traffic Management must comply with The Safety at Street Works and Road Works Code of Practice**

**WRITTEN DIVERSION ROUTE:**

Rear Of 14 Queen Street Closed. Traffic Diverted Via Richmond Street and Queen Street.

**ROAD SPEED**

**30**

**ROAD CLOSURE**

REV	DATE	DESCRIPTION
A	04/03/24	AS DRAWN

**GTM**  
Go Traffic Management

Head Office: Go Traffic Management,  
Chaddock Lane, Worsley, Manchester, M28 1XW  
Tel: 0161 351 5370  
www.gtm.co.uk

**TRAFFIC MANAGEMENT PLAN**

Client: **Network Plus**

Drawing Number: 937689

Drawing Title: Queen Street, Bolton, BL6 5QU

Design:	Technical Officer:	REV:
Name: R. Thomas	M. Gardiner	—
Signature:		
Date: 04/03/24	04/03/24	