

**ROAD TRAFFIC REGULATION ACT 1984 SECTION 14(1)**

**THE BOLTON (PUBLIC FOOTPATH WESTHOUGHTON 144)  
(TEMPORARY CLOSURE) (NO.97) ORDER 2025**

The Borough Council of Bolton has made an Order, which will be operative from 27<sup>th</sup> January 2025, which will prohibit all pedestrian traffic from using Public Footpath Westhoughton 144 commencing from Manchester Road point A at grid reference SD 66722 06297 in a generally south-southwest direction to point B Manley Crescent at grid reference SD 66679 06216: as shown by the bold black line on the Order plan 1Wes144 over a total distance of approximately 94 metres.

An alternative route will be available commencing Manchester Road point A at grid reference SD 66722 06297 then Public Right of Way Wes 143 to point B Manley Crescent at grid reference SD 66679 06216.

The Order is necessary to facilitate excavation works and to install and joint cable and will continue for a period of 5 days, or until the works are completed, whichever is the earlier.

Dated: 27<sup>th</sup> January 2025

J Dyson, Director of Place, Town Hall, Bolton, BL1 1RU  
LS/RST/096015

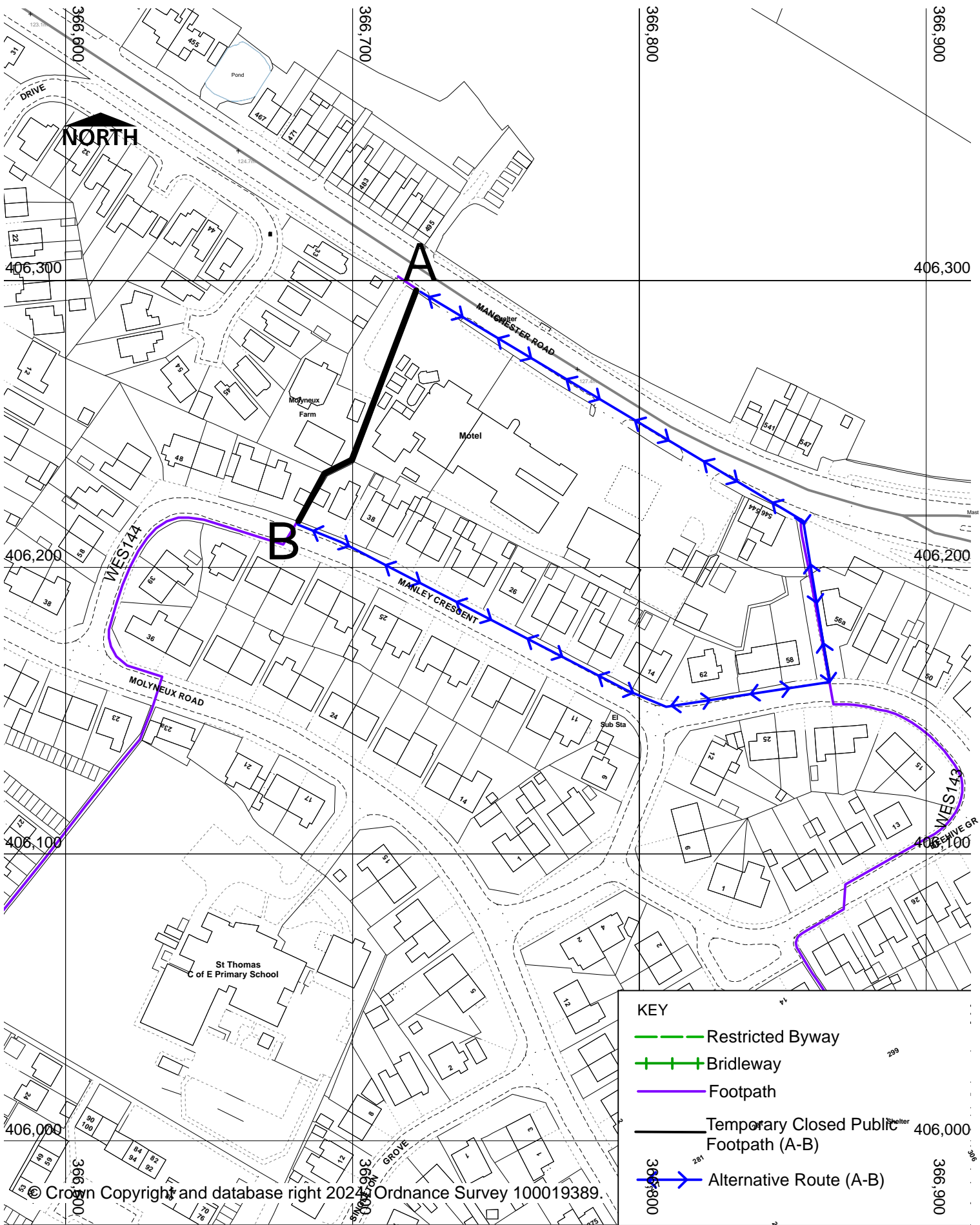

**KEY**

- Restricted Byway
- + + Bridleway
- Footpath
- Temporary Closed Public Footpath (A-B)
- > Alternative Route (A-B)



**HIGHWAY AND ENGINEERING DIVISION**  
**PUBLIC RIGHTS OF WAY**

**THE BOROUGH COUNCIL OF BOLTON**  
**Public Footpath Westthoughton 144**  
**Temporary Closure Order Section 14 RTA 1984**

**DIRECTORATE OF PLACE**  
Jon Dyson  
Director of Place  
Town Hall, Victoria Square, Bolton, BL1 1RU

Date  
**06/12/2024**

Scale  
1:1700

Drawn  
AS

Drg. No.  
1Wes144