

# ROAD CLOSURE

**Bolton  
Council**

## NOTIFICATION OF TEMPORARY ROAD CLOSURE ROAD TRAFFIC REGULATION ACT 1984

STREET

**Kildare Street**

DATES

**11 JAN 2025 for 9 days approx**

(end date and duration are subject to change)

REASON / WORKS

**Electricity works**

**Advertised public notice below  
Diversion plans (if available) are attached**

THE BOROUGH COUNCIL OF BOLTON  
ROAD TRAFFIC REGULATION ACT 1984 S.14  
KILDARE STREET - TEMPORARY ONE-WAY TRAFFIC

The Council intends to make an order, operative from 11 February 2025 for 9 days approx, the effect of which will be to implement a one-way traffic restriction on Kildare Street from Albert Rd to Langdale St (permitted direction eastbound), to allow electricity works to take place. Alternative route is via Balmoral Rd, Leinster St. The Order will end after 18 months or on completion of the works whichever first occurs.

Bolton Council. 21 January 2025.



If your waste or recycling bins are due to be emptied during road or resurfacing works, please present them at the nearest accessible point. This will ensure that your bins can be emptied on the usual collection day.

**closures online at [bolton.gov.uk/trafficorders](https://bolton.gov.uk/trafficorders)**

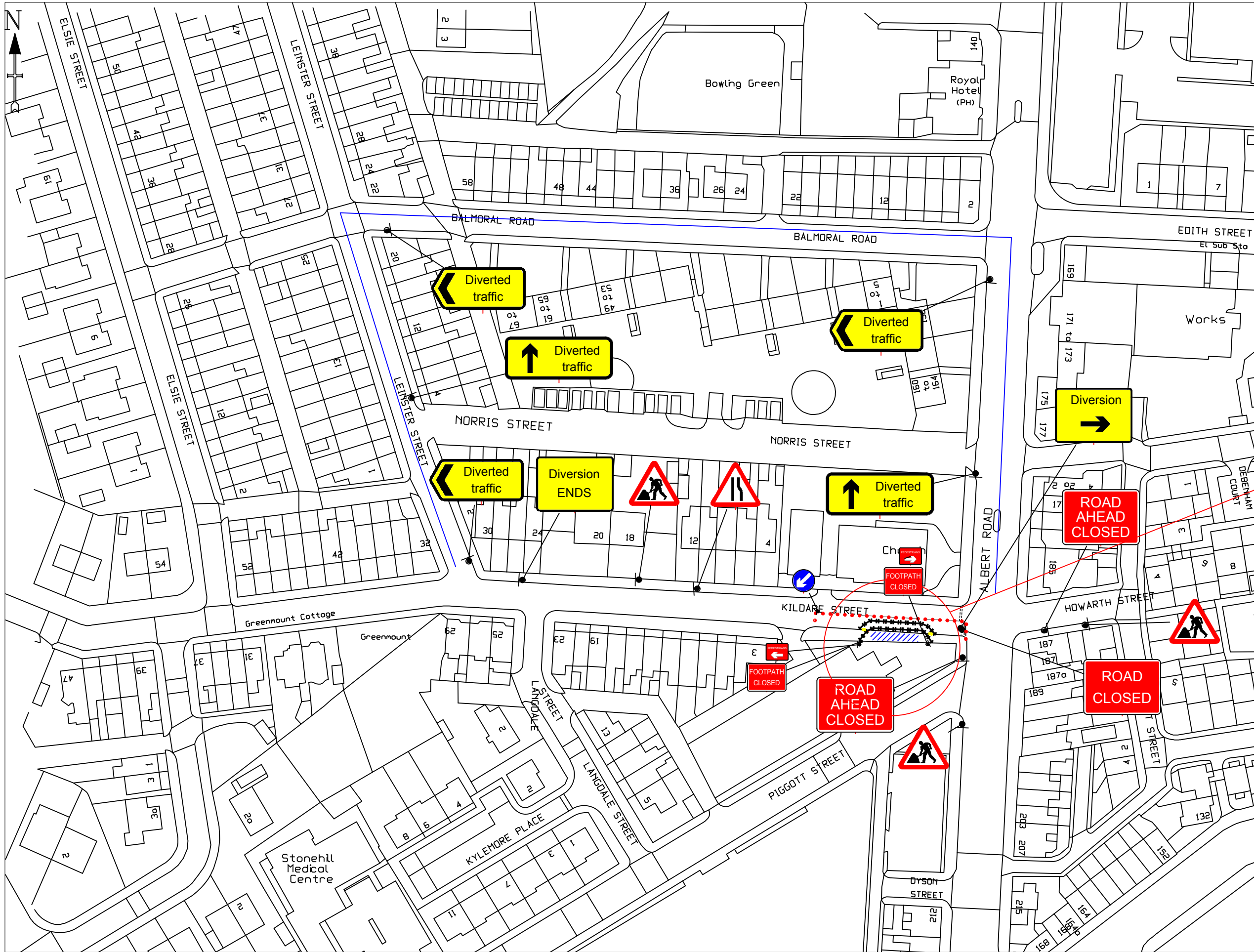

**DETAIL B (B)**

Single/Dual carriageway 40mph or less - 450mm traffic cones, spacing 1.5m.  
 Single/Dual carriageway 50mph or more - 750mm traffic cones, spacing 1.5m.  
 Dual carriageway national speed limit - 750mm traffic cones, spacing 1.5m, relaxation 3m.

Notes:  
 1) During darkness, warning lights to BS EN 12352:2006 should be provided in accordance with Table A1.3 (Appendix 1).  
 2) 45° tapers have 1.5m spacing, no relaxations.  
 3) On motorways and NSL AP duals with hard shoulders, 1m cones will be required for both standard and relaxation works for lead tapers and the facing wall of lane changes.

**DETAIL D (D)**

Single/Dual carriageway 40mph or less - 450mm traffic cones.  
 Single/Dual carriageway 50mph or more - 750mm traffic cones.

Notes:  
 1) During darkness, warning lights to BS EN 12352:2006 should be provided in accordance with Table A1.3 (Appendix 1).  
 2) Detail D applies only to relaxation cases.

	Standard: Normal traffic including buses and HGVs	Restricted: Cars and light vehicles only
Two-way working	6.75 m minimum	5.5 m minimum
Shuttle working	3.25-3.00 m desirable width range 3.0 m absolute minimum	3.25 m desirable minimum width 2.5 m absolute minimum

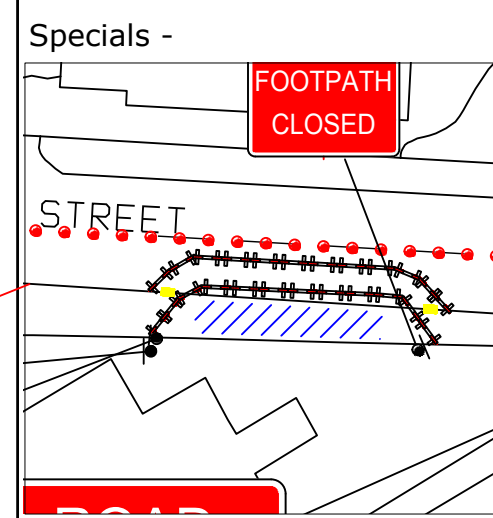

**Notes -**

**DIVERSION ROUTE - ALBERT ROAD, BALMORAL ROAD, LEINSTER STREET**

**KEY**

	Traffic sign
	Traffic cone
	Traffic signals to Diagram 3000.1
	Working Space
	Pedestrian Barrier

<b>TEMPORARY TRAFFIC MANAGEMENT</b> <b>30 MPH</b>	Issue	Date
	1	30.10.24
	Drawn By	MM

**ROAD CLOSURE + DIVERSION**  
**187 ALBERT ROAD BL4 9HZ**

Original drawing size A3 - NTS

Drawing Ref: **1474451**