

**THE BOROUGH COUNCIL OF BOLTON  
ADOPTION OF ROADS INTO THE PUBLIC HIGHWAY  
HIGHWAYS ACT 1980 - SECTION 38**

**DECLARATION**

I, Dwayne Lowe, Assistant Director of Highways & Planning, pursuant to the powers delegated to me for and on behalf of the Borough Council of Bolton, hereby declare the street(s) named below, having been made up to the appropriate standard, to be highway(s) maintainable at the public expense and to be recorded as such in the register of adopted streets.

This adoption is pursuant to Section 38 of the Highways Act 1980.

**SCHEDULE**

<i>Name of Street &amp; USRN</i>	<i>Description</i>	<i>Approximate Length</i>
<b>BRIDGEWATER AVENUE, BOLTON</b>  USRN: 3406567	From its junction with Salford Road, for an approximate distance of 846 metres in a south-westerly direction. An area as shown on drawing number 311101-ADP1	846 metres
<b>LEA FIELD WAY, BOLTON</b>  USRN: 3406570	From its junction with Bridgewater Avenue, for an approximate distance of 265 metres in a westerly direction. An area as shown on drawing number 311101-ADP2	265 metres
<b>HULTON HEYS WAY, BOLTON</b>  USRN: 3406569	From its junction with Bridgewater Avenue, for an approximate distance of 176 metres in a westerly direction. An area as shown on drawing number 311101-ADP3	176 metres
<b>WHARTON HALL AVENUE, BOLTON</b>  USRN: 3406568	From its junction with Bridgewater Avenue, for an approximate distance of 995 metres in an easterly direction, to the borough boundary. An area as shown on drawing number 311101-ADP4	995 metres

<b>LOMAX WAY, BOLTON</b>  USRN: 3406609	From its junction with Wharton Hall Avenue, for an approximate distance of 180 metres in a north-easterly direction. An area as shown on drawing number 311101-ADP5	
---	--	--

SIGNED:



DATE:

**3 December 2024**

.....  
Dwayne Lowe CEng FCiHT FIHE  
Assistant Director – Highways and Planning

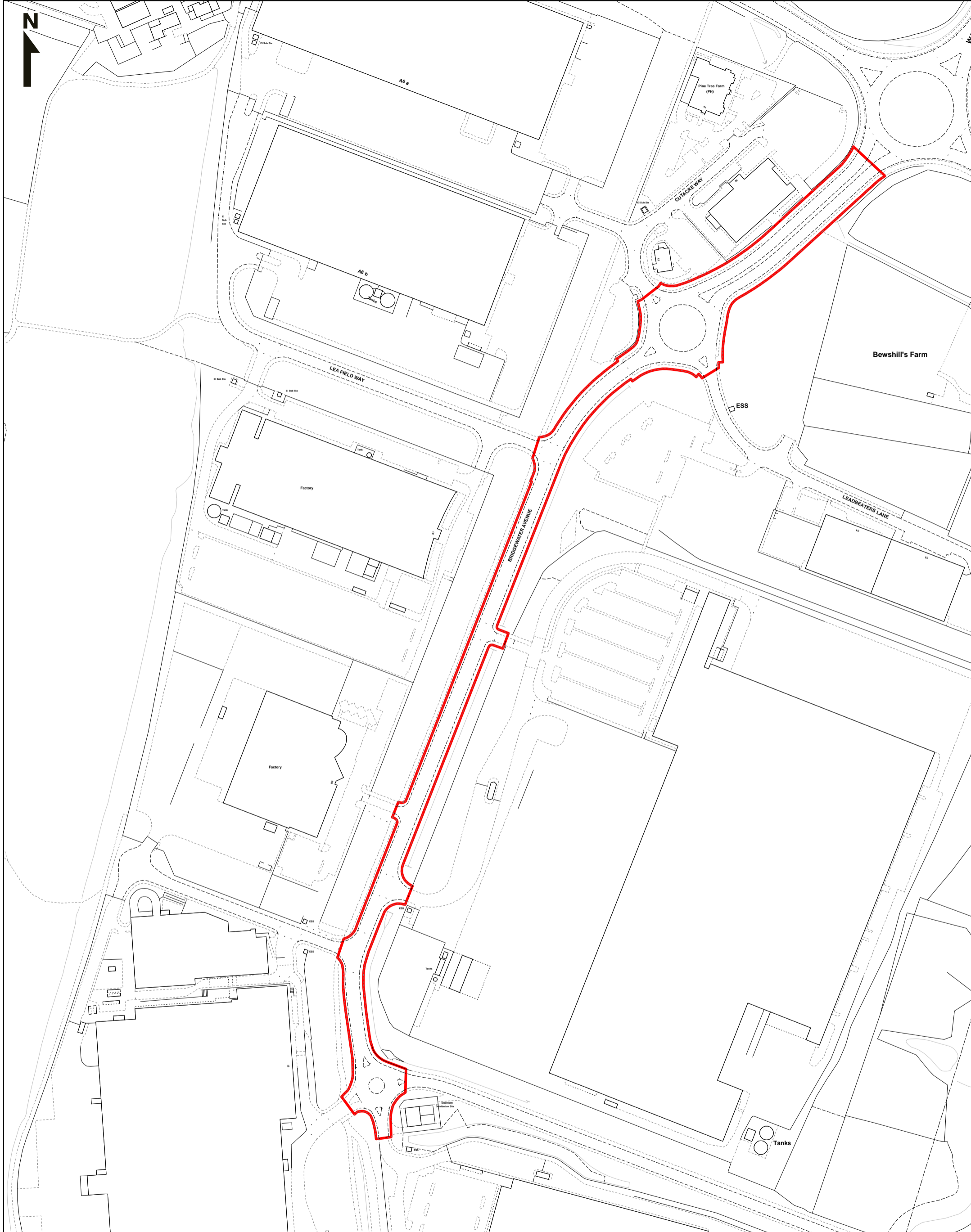

Based upon the Ordnance Survey mapping with the permission of the Controller of Her Majesty's Stationary Office © Crown Copyright  
 Unauthorised reproduction may lead to prosecution. Bolton Council Licence No 10019389/2024

**Bolton Council**

Highways & Engineering  
 Bolton Council  
 Paderborn House  
 Civic Centre  
 Bolton BL1 1UA

Jon Dyson  
 Director of Place

**ADOPTION OF ROADS INTO THE PUBLIC HIGHWAY  
 HIGHWAYS ACT 1980 - SECTION 38**

**Bridgewater Avenue, Bolton**

 HIGHWAY TO BE ADOPTED

Scale 1:2500 at A3

Drawn By PDHouse

Date 29 NOV 2024

Drawing No. 311101-ADP1

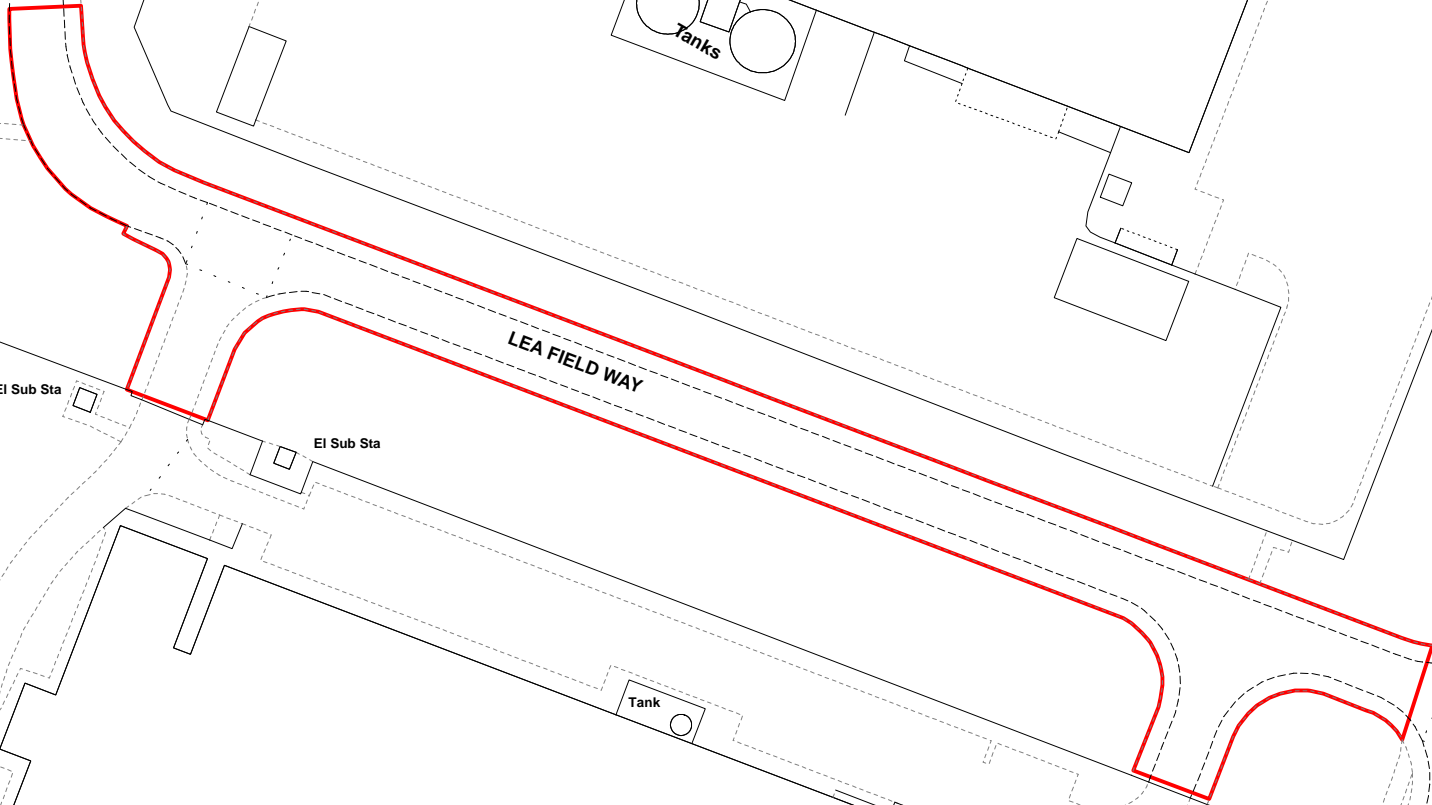

Based upon the Ordnance Survey mapping with the permission of the Controller of Her Majesty's Stationary Office © Crown Copyright  
Unauthorised reproduction may lead to prosecution. Bolton Council Licence No 10019389/2024

**Bolton Council**

Highways & Engineering  
Bolton Council  
Paderborn House  
Civic Centre  
Bolton BL1 1UA

Jon Dyson  
Director of Place

**ADOPTION OF ROADS INTO  
THE PUBLIC HIGHWAY  
HIGHWAYS ACT 1980 - SECTION 38**

**Lea Field Way, Bolton**

 HIGHWAY TO BE ADOPTED

Scale 1:1250 at A4

Drawn By PDHouse

Date 29 NOV 2024

Dwg No. 311101-ADP2

BRIDGEWATER AVENUE



Factory

B2

Drain

Middle  
Hulton

HULTON HEYS WAY

ESS

ESS

ESS

Tanks

FB

Drain

Drain

Based upon the Ordnance Survey mapping with the permission of the Controller of Her Majesty's Stationary Office © Crown Copyright  
Unauthorised reproduction may lead to prosecution. Bolton Council Licence No 10019389/2024

**Bolton  
Council**

Highways & Engineering  
Bolton Council  
Paderborn House  
Civic Centre  
Bolton BL1 1UA

Jon Dyson  
Director of Place

**ADOPTION OF ROADS INTO  
THE PUBLIC HIGHWAY  
HIGHWAYS ACT 1980 - SECTION 38**

**Hulton Heys Way, Bolton**



HIGHWAY TO BE ADOPTED

Scale 1:1250 at A4

Drawn By PDHouse

Date 29 NOV 2024

Dwg No. 311101-ADP3



Based upon the Ordnance Survey mapping with the permission of the Controller of Her Majesty's Stationary Office © Crown Copyright  
 Unauthorised reproduction may lead to prosecution. Bolton Council Licence No 10019389/2024

**Bolton Council**

Highways & Engineering  
 Bolton Council  
 Paderborn House  
 Civic Centre  
 Bolton BL1 1UA

Jon Dyson  
 Director of Place

**ADOPTION OF ROADS INTO THE PUBLIC HIGHWAY  
 HIGHWAYS ACT 1980 - SECTION 38**

**Wharton Hall Avenue, Bolton**

 HIGHWAY TO BE ADOPTED

Scale 1:2500 at A3

Drawn By PDHouse

Date 29 NOV 2024

Drawing No. 311101-ADP4

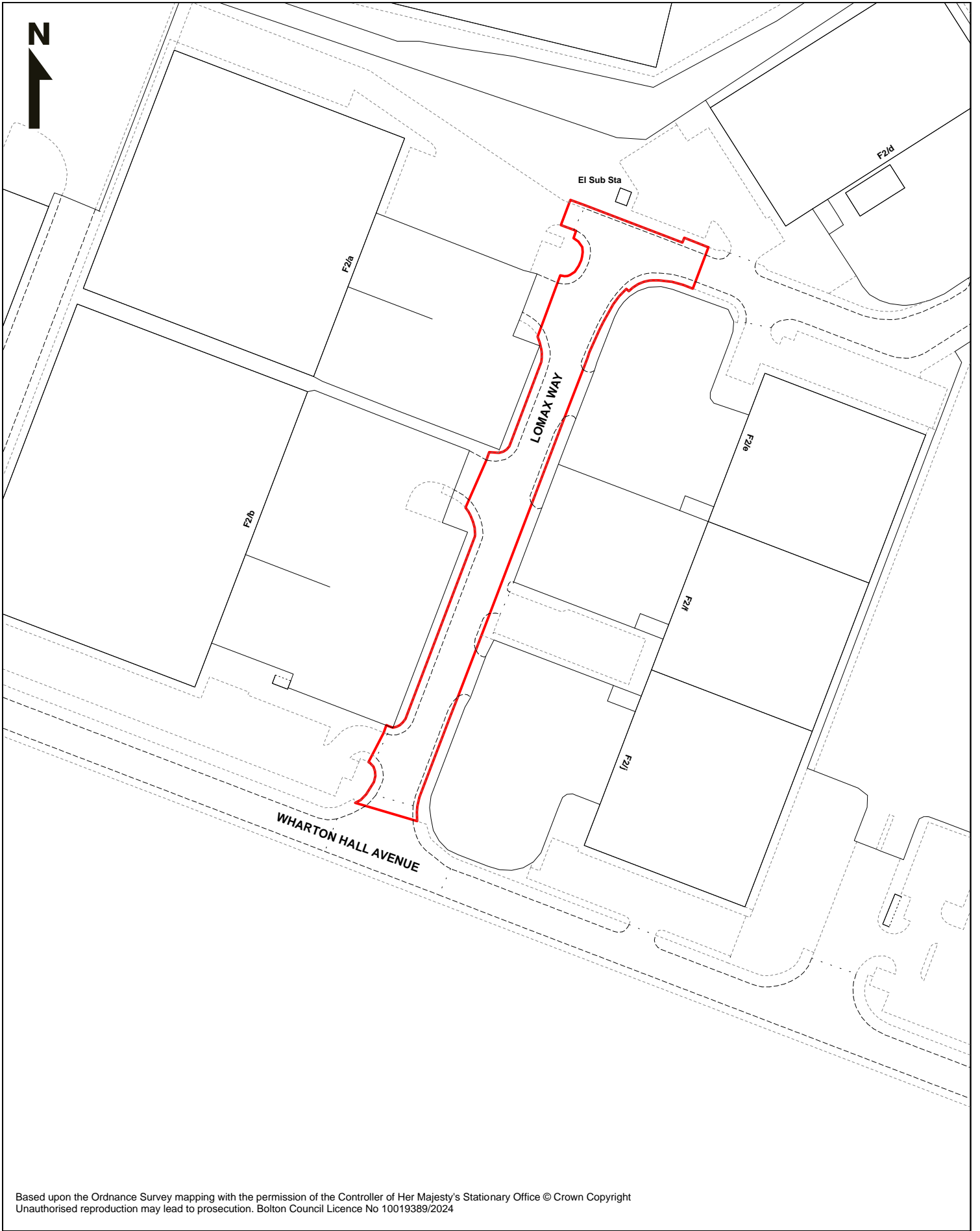

Based upon the Ordnance Survey mapping with the permission of the Controller of Her Majesty's Stationary Office © Crown Copyright  
 Unauthorised reproduction may lead to prosecution. Bolton Council Licence No 10019389/2024

**Bolton Council**

Highways & Engineering  
 Bolton Council  
 Paderborn House  
 Civic Centre  
 Bolton BL1 1UA

Jon Dyson  
 Director of Place

**ADOPTION OF ROADS INTO  
 THE PUBLIC HIGHWAY  
 HIGHWAYS ACT 1980 - SECTION 38**

**Lomax Way, Bolton**

 HIGHWAY TO BE ADOPTED

Scale 1:1250 at A4

Drawn By PDHouse

Date 29 NOV 2024

Dwg No. 311101-ADP5

**THE BOROUGH COUNCIL OF BOLTON  
ADOPTION OF CULVERTS INTO THE PUBLIC HIGHWAY  
HIGHWAYS ACT 1980 - SECTION 38**

**DECLARATION**

I, Dwayne Lowe, Assistant Director of Highways & Planning, pursuant to the powers delegated to me for and on behalf of the Borough Council of Bolton, hereby declare the culverts(s) named below, having been made up to the appropriate standard, to be maintainable at the public expense and to be recorded as such in the register of adopted culverts.

This adoption is pursuant to Section 38 of the Highways Act 1980.

**SCHEDULE**

<i>Name/Reference of Culvert</i>	<i>Description</i>
<b>1008 LOGISTICS NORTH BRIDGEWATER AVENUE CULVERT</b>	a) 54m long, pre cast concrete culvert, 1.8m x 1.8m internal diameter. b) Upstream masonry headwall and key klamp safety rail to back of footway. c) Downstream key klamp to top of culvert section.  As shown on drawing number 311101-ADC1
<b>1009 LOGISTICS NORTH WHARTON HALL AVENUE CULVERT</b>	a) 12.3m long, 1.5m diameter reinforced concrete culvert pipe b) 2 x 12.3m long, 1.05m diameter mammal runs. c) Masonry clad reinforced concrete headwalls with N2 containment parapets.  As shown on drawing number 311101-ADC1

The adoption shall be limited to those elements listed above and shall therefore exclude any river training walls, gabion baskets or drainage outfalls that may be present on the adjacent watercourse.

SIGNED:



DATE:

**3 December 2024**

.....

.....

Dwayne Lowe CEng FCIHT FIHE  
Assistant Director – Highways and Planning



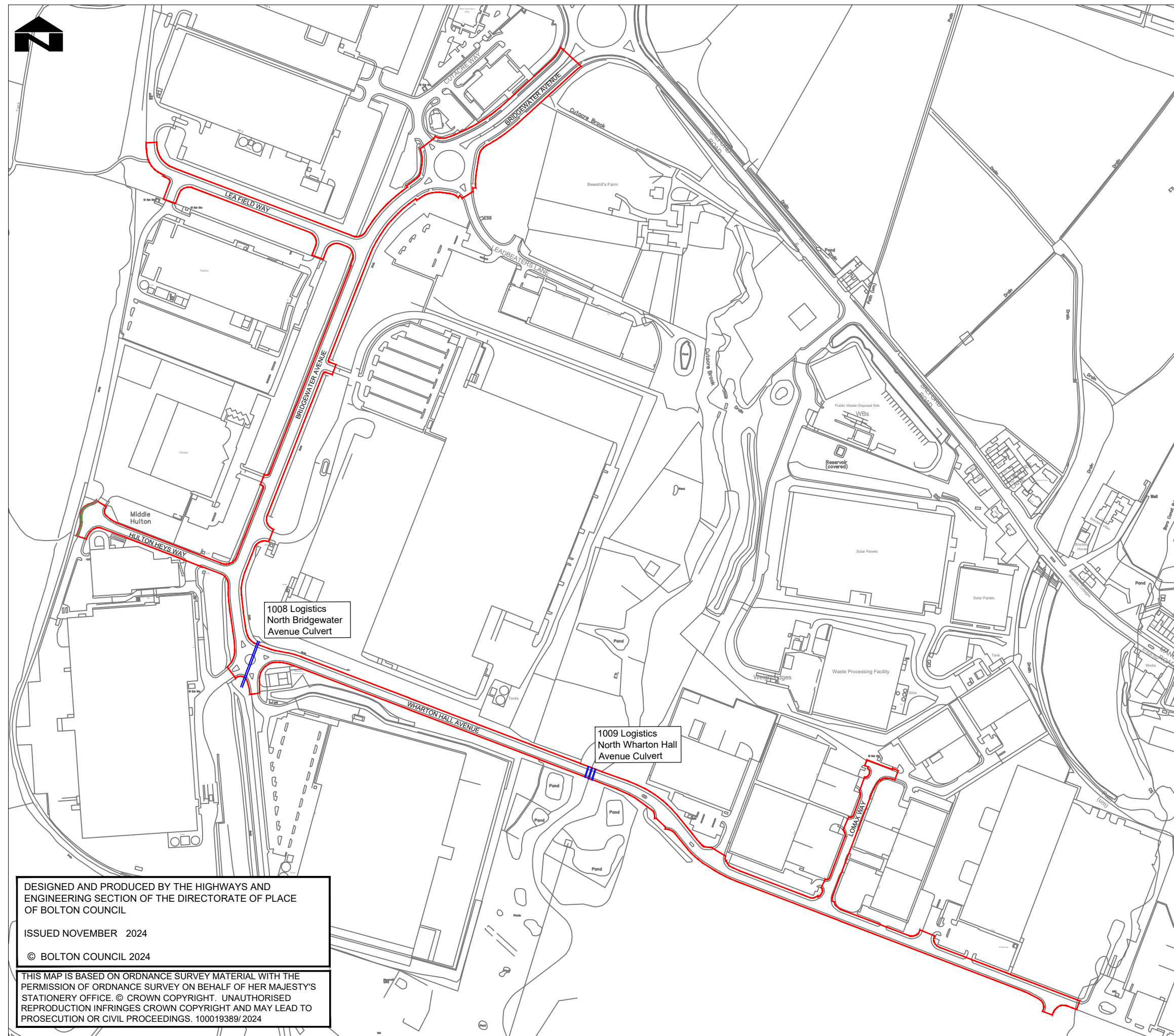

KEY

1008 Logistics North Bridgewater Avenue Culvert

- a) 54m long, pre cast concrete culvert, 1.8m x 1.8m internal diameter.
- b) Upstream masonry headwall and key klamp safety rail to back of footway.
- c) Downstream key klamp to top of culvert section.

1009 Logistics North Wharton Hall Avenue Culvert

- a) 12.3m long, 1.5m diameter reinforced concrete culvert pipe
- b) 2 x 12.3m long, 1.05m diameter mammal runs.
- c) Masonry clad reinforced concrete headwalls with N2 containment parapets.

The adoption shall be limited to those elements listed above and shall therefore exclude any river training walls, gabion baskets or drainage outfalls that may be present on the adjacent watercourse.

DESIGNED AND PRODUCED BY THE HIGHWAYS AND ENGINEERING SECTION OF THE DIRECTORATE OF PLACE OF BOLTON COUNCIL

ISSUED NOVEMBER 2024

© BOLTON COUNCIL 2024

THIS MAP IS BASED ON ORDNANCE SURVEY MATERIAL WITH THE PERMISSION OF ORDNANCE SURVEY ON BEHALF OF HER MAJESTY'S STATIONERY OFFICE. © CROWN COPYRIGHT. UNAUTHORISED REPRODUCTION INFRINGES CROWN COPYRIGHT AND MAY LEAD TO PROSECUTION OR CIVIL PROCEEDINGS. 100019389/ 2024

Rev.	Amendments	By	Date	Chkd.

**Bolton Council** HIGHWAYS AND ENGINEERING DIVISION  
 'KEEPING PEOPLE MOVING SAFELY'  
 DIRECTORATE OF PLACE  
 Director: Jon Dyson

CUTACRE, LOGISTICS NORTH  
ADOPTION OF 1008 LOGISTICS NORTH BRIDGEWATER AVENUE CULVERT AND 1009 LOGISTICS NORTH WHARTON HALL AVENUE CULVERT

Status INFORMATION

Date	NOVEMBER 2024	Drawn-by	S MYKOLAJOWSKI
Scale	NTS	Checked by	M ROWLES
Drawing Size	A3	Independent check	
		CAD ref.	311101/CULVERT ADOPTION/1008 AND 1009

Drawing No.	<b>311101-ADC1</b>	Revision	
-------------	--------------------	----------	--