

ROAD CLOSURE

**Bolton
Council**

NOTIFICATION OF TEMPORARY ROAD CLOSURE ROAD TRAFFIC REGULATION ACT 1984

STREET

Coe Street

DATES

06 JAN 2025 for 1 day approx

(end date and duration are subject to change)

REASON / WORKS

Telecom works

**Advertised public notice below
Diversion plans (if available) are attached**

THE BOROUGH COUNCIL OF BOLTON
ROAD TRAFFIC REGULATION ACT 1984 S.14
COE STREET - TEMPORARY CLOSURE

The Council intends to make an order, operative from 6 January 2025 between the hours of 8am and 4:30pm approx, the effect of which will be to prohibit all traffic from proceeding on Coe Street from St Marks St to Cochrane St to allow telecoms works to take place. Alternative route is via Lever St, Fletcher St, Bridgeman St, Thynne St. The Order will end after 18 months or on completion of the works whichever first occurs.

Bolton Council. 16 December 2024.



If your waste or recycling bins are due to be emptied during road or resurfacing works, please present them at the nearest accessible point. This will ensure that your bins can be emptied on the usual collection day.

closures online at bolton.gov.uk/trafficorders

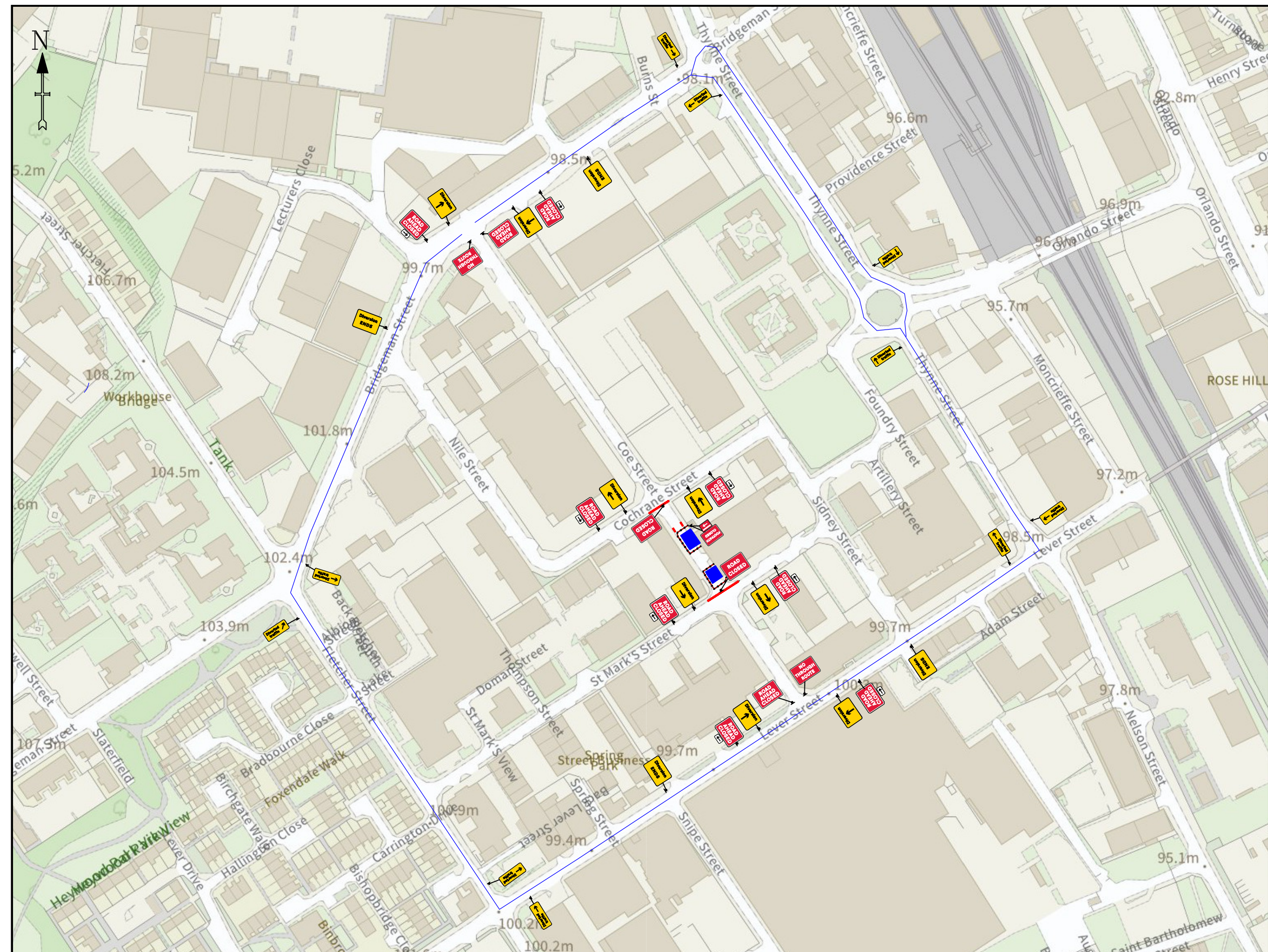

DETAIL B (B)

Single/Dual carriageway 40mph or less - 450mm traffic cones, spacing 1.5m.
 Single/Dual carriageway 50mph or more - 750mm traffic cones, spacing 1.5m.
 Dual carriageway national speed limit - 750mm traffic cones, spacing 1.5m, relaxation 3m.

Notes:
 1) During darkness, warning lights to BS EN 12352:2006 should be provided in accordance with Table A1.3 (Appendix 1).
 2) 45° tapers have 1.5m spacing, no relaxations.
 3) On motorways and NSL AP duals with hard shoulders, 1m cones will be required for both standard and relaxation works for lead tapers and the facing wall of lane changes.

DETAIL D (D)

Single/Dual carriageway 40mph or less - 450mm traffic cones.
 Single/Dual carriageway 50mph or more - 750mm traffic cones.

Notes:
 1) During darkness, warning lights to BS EN 12352:2006 should be provided in accordance with Table A1.3 (Appendix 1).
 2) Detail D applies only to relaxation cases.

	Standard: Normal traffic including buses and HGVs	Restricted: Cars and light vehicles only
Two-way working	6.75 m minimum	5.5 m minimum
Shuttle working	3.25-3.50 m desirable width range	3.25 m desirable minimum width
	3.0 m absolute minimum	2.5 m absolute minimum

City 2 Ref: 2102 Start of temporary diversion route	
City 2 Ref: 2102 Start of temporary diversion route	
City 4 Ref: 2102 Start of temporary diversion route	
City 4 Ref: 2102 End of temporary diversion route	
City 3 Ref: 2103 Direction of temporary diversion route from junction ahead	
City 4 Ref: 2103 Direction of temporary diversion route from junction ahead	
City 2 Ref: 2103 Direction of temporary diversion route from junction ahead	
City 1 Ref: 2103 Direction of temporary diversion route from junction ahead	
City 4 Ref: 013 Direction to hazard left	
City 4 Ref: 013 Direction to hazard right	
City 2 Ref: 7010-PP-13.9 Nature of temporary hazard ahead - Road Closed	
City 2 Ref: 7010-PP-13.9 Nature of temporary hazard ahead - Road Ahead Closed	
City 1 Ref: 7010-PP-13.9 Nature of temporary hazard ahead - Footpath Closed	
City 8 Ref: 7010.1 Nature of temporary hazard ahead - Road Ahead Closed	
City 1 Ref: 7018 Prohibition: Diversion Right	
City 2 Ref: TEL 13.9 QJAC Cycle lane ahead closed	

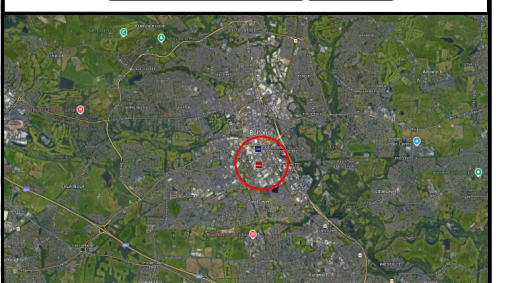

Notes -

PED RAMPS TO BE USED FOR TEMP PED WALKWAY

DIVERSION ROUTE

KEY

- Traffic sign
- Traffic cone
- Traffic signals to Diagram 3000.1
- Working Space
- Pedestrian Barrier



TEMPORARY TRAFFIC MANAGEMENT
30 MPH

Issue	Date
1	25/09/24
Drawn By	JB

ROAD CLOSURE + DIVERSION
COE STREET
BOLTON, BL3 6BL

Original drawing size A3 - NTS
Drawing Ref: COMMHOIST