

# ROAD CLOSURE

**Bolton  
Council**

## NOTIFICATION OF TEMPORARY ROAD CLOSURE ROAD TRAFFIC REGULATION ACT 1984

STREET

**Lee Lane, Horwich**

DATES

**28 NOV 2024 for 2 days approx**

(end date and duration are subject to change)

REASON / WORKS

**Telecom works**

**Advertised public notice below  
Diversion plans (if available) are attached**

THE BOROUGH COUNCIL OF BOLTON  
ROAD TRAFFIC REGULATION ACT 1984 S.14  
LEE LANE, HORWICH - TEMPORARY CLOSURE

The Council intends to make an order, operative from 28 November 2024 for 2 days approx, the effect of which will be to prohibit all traffic from proceeding on Lee Lane from Beaumont Rd to Longworth Rd to allow telecoms works to take place. Alternative route is via Winter Hey Ln, Chorley New Rd. The Order will end after 18 months or on completion of the works whichever first occurs.

Bolton Council. 7 November 2024.



If your waste or recycling bins are due to be emptied during road or resurfacing works, please present them at the nearest accessible point. This will ensure that your bins can be emptied on the usual collection day.

**closures online at [bolton.gov.uk/trafficorders](https://bolton.gov.uk/trafficorders)**

**Drawing Notes**

Cone lights spaced minimum 9m, cones to be 750 mm or 1m  
All works to be carried out as per safety at streetworks and roadworks "A Code of Practice" October 2013.  
CPA conditions apply unless otherwise agreed.

**Traffic Management Key**

 Road Closure

**Site Details**

Traffic Management	Diversion
Speed of road (mph)	
Minimum sideways safety zone (S)	N/A
Minimum longways safety zone (L)	N/A

Additional Notes:

 **LEE ROAD CLOSED FOLLOW DIVERSION**

**Drawing Office**

DRAWING NUMBER	CF3483
CONTRACT NUMBER	169354
PHASE NUMBER	1 of 1
PAGE NUMBER	1 of 2
SURVEYED BY / DATE	N/A N/A
DRAWN BY / DATE	CF 17/06/24
CHECKED BY / DATE	AE 17/06/24
APPROVED BY / DATE	CH 17/06/24
CLIENT REF	96011
SCALE @ A3	NTS

REV	BY	DATE
A	CF	17/06/24

**Client**

**Nationwide Platforms**  
A LOXAM Company

**Site Address**

Uno Hairdressers,  
Lee Lane,  
Bolton,  
BL6 7AE

**Co-ordinates, Latitude - Longitude**

53.599724969, -2.5459478240

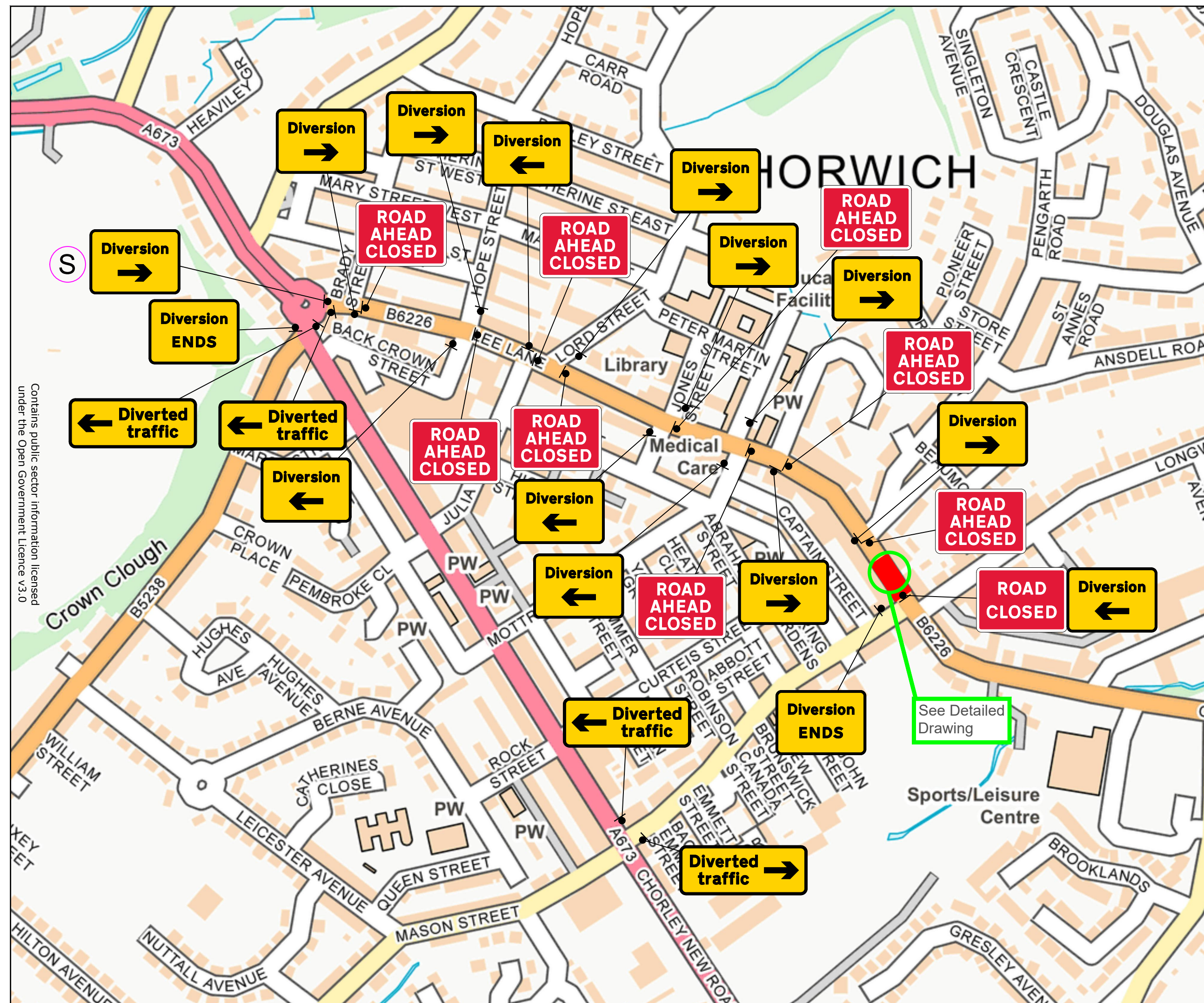

Contains public sector information licensed under the Open Government Licence v3.0

**Drawing Notes**  
Cone lights spaced minimum 9m, cones to be 750 mm or 1m

All works to be carried out as per safety at streetworks and roadworks "A Code of Practice" October 2013. CPA conditions apply unless otherwise agreed.

**Traffic Management Key**

	Area of Works
	Safety Zones
	Road Signs
	Road Cones
	Pedestrian Barrier
	Ramps

**Site Details**

Traffic Management	Detailed Drawing
Speed of road (mph)	
Minimum sideways safety zone (S)	N/A
Minimum longways safety zone (L)	N/A

Additional Notes:

**Drawing Office**

DRAWING NUMBER	CF3484
CONTRACT NUMBER	169354
PHASE NUMBER	1 of 1
PAGE NUMBER	2 of 2
SURVEYED BY / DATE	N/A / N/A
DRAWN BY / DATE	CF / 17/06/24
CHECKED BY / DATE	AE / 17/06/24
APPROVED BY / DATE	CH / 17/06/24
CLIENT REF	96011
SCALE @ A3	NTS

REV		BY	DATE
A	FIRST ISSUE FOR APPROVAL	CF	17/06/24

**Client**

**Nationwide Platforms**  
A LOXAM Company

**Site Address**

Uno Hairdressers,  
Lee Lane,  
Bolton,  
BL6 7AE

**Co-ordinates, Latitude - Longitude**  
53.599724969, -2.5459478240

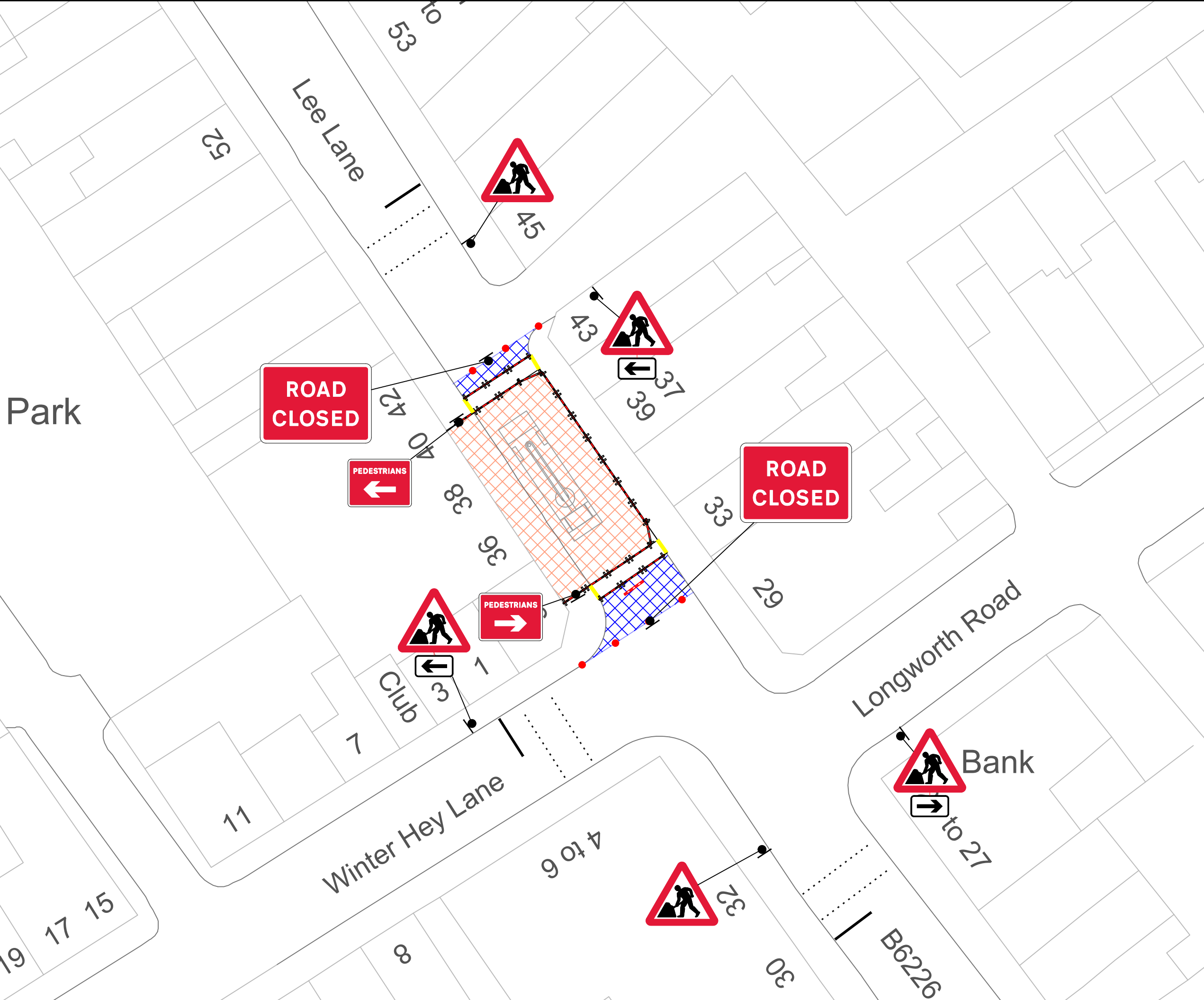

Park

Bank