

# ROAD CLOSURE

**Bolton  
Council**

## NOTIFICATION OF TEMPORARY ROAD CLOSURE ROAD TRAFFIC REGULATION ACT 1984

STREET

**Parkfield Road**

DATES

**25 NOV 2024 for 6 days approx**

(end date and duration are subject to change)

REASON / WORKS

**Gas works**

**Advertised public notice below  
Diversion plans (if available) are attached**

THE BOROUGH COUNCIL OF BOLTON  
ROAD TRAFFIC REGULATION ACT 1984 S.14  
PARKFIELD ROAD - TEMPORARY CLOSURE

The Council intends to make an order, operative from 25 November 2024 for 6 days approx, the effect of which will be to prohibit all traffic from proceeding on Parkfield Road from Bradford Rd to Back Bradford Rd West, to allow gas works to take place. Alternate route for traffic will be via Crescent Rd, Weston St, Rishton Lane. The Order will end after 18 months or on completion of the works whichever first occurs.

Bolton Council. 4 November 2024.



If your waste or recycling bins are due to be emptied during road or resurfacing works, please present them at the nearest accessible point. This will ensure that your bins can be emptied on the usual collection day.

**closures online at [bolton.gov.uk/trafficorders](https://bolton.gov.uk/trafficorders)**

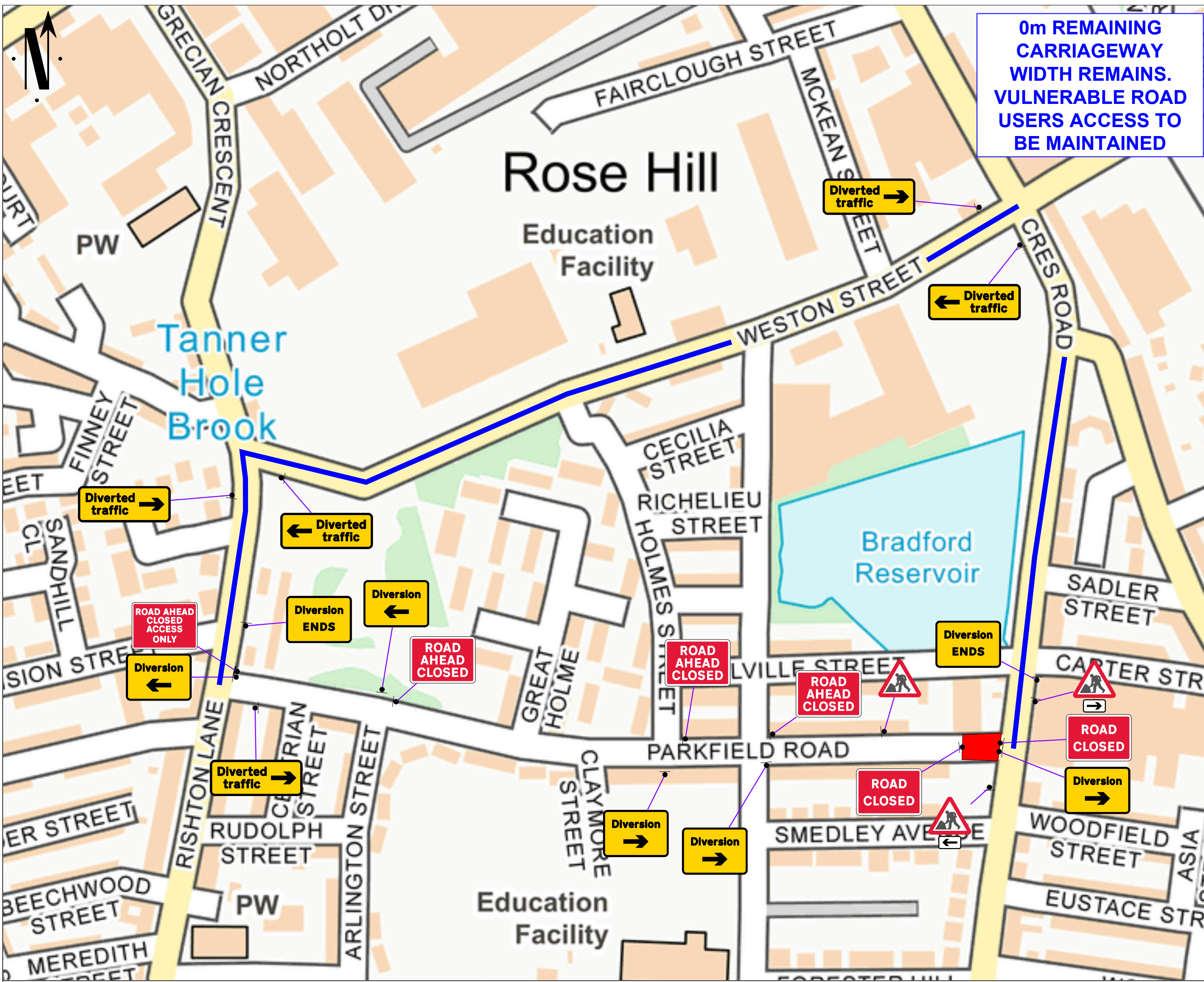

**0m REMAINING CARRIAGEWAY WIDTH REMAINS. VULNERABLE ROAD USERS ACCESS TO BE MAINTAINED**

Go Traffic Management

This drawing has been produced for a specific client & project identified below and is not intended for use by any other person or for any other purpose. © Go Traffic Management

**Risks**

- Design completed from information provided + google maps desktop risk assessment
- Cone lamps must be used on all roads with a speed limit of 40mph or more.

**Notes**

- All signs as per Chapter 8. Distances between cones to be 9m maximum unless otherwise noted.
- Distances between signs NOT to scale for purpose of clarity.
- All sign placement subject to available safe working space.
- The purpose of the Traffic Management Plan is for it to be used only as a guide and all traffic management equipment should be put out according to the 'Safety at Street Works and Road Works - Code of Practice', i.e. Red Book & the 'Traffic Signs Manual Chapter 8', i.e. Yellow Book.
- Signs must be placed in accordance with TSM and the scheme RAMS pack.
- Site conditions may have changed since the design of the drawing any changes which subsequently affect the design need to be reported by the Traffic Management Operative & any changes implemented must comply with Chapter 8.

**Key**

- Sign position and aspect of vision
- Road Closure
- Diversion Route
- Works Space

**Diversion Route**

Bradford Road <- Crescent Road <- Weston Street <- Rishton Lane And Vice Versa.

Traffic Management must comply with The Safety at Street Works and Road Works Code of Practice

ROAD SPEED

**30**

DO NOT SCALE FROM THIS DRAWING.		ROAD CLOSURE
REV.	DATE	DESCRIPTION
A		

**GTM**  
Go Traffic Management

Head Office: Go Traffic Management, Chaddock Lane, Worsley, Manchester, M28 1XW  
Tel: 0161 351 5370  
www.gtm.co.uk

CERTIFIED  
ISO 9001:2015  
ONAS 18001

TRAFFIC MANAGEMENT PLAN

Client: **Cadent**  
Your Gas Network

Drawing Number: 1179552

Drawing Title: Parkfield Road, Bolton, BL3 2BG

Design:	Technical Officer:	REV:
Name: D. Thomas	J. McNamara	A
Date: 10/10/2024		