

# ROAD CLOSURE

**Bolton  
Council**

## NOTIFICATION OF TEMPORARY ROAD CLOSURE ROAD TRAFFIC REGULATION ACT 1984

STREET

**Back Cloister Street**

DATES

**19 NOV 2024 for 3 days approx**

(end date and duration are subject to change)

REASON / WORKS

**Water works**

**Advertised public notice below  
Diversion plans (if available) are attached**

THE BOROUGH COUNCIL OF BOLTON  
ROAD TRAFFIC REGULATION ACT 1984 S.14  
BACK CLOISTER STREET - TEMPORARY CLOSURE

The Council intends to make an order, operative from 19 November 2024 for 3 days approx, the effect of which will be to prohibit all traffic from proceeding on Back Cloister Street from Ainsworth St to Back Ainsworth St to allow water works to take place. The Order will end after 18 months or on completion of the works whichever first occurs.

Bolton Council. 29 October 2024.



If your waste or recycling bins are due to be emptied during road or resurfacing works, please present them at the nearest accessible point. This will ensure that your bins can be emptied on the usual collection day.

**closures online at [bolton.gov.uk/trafficorders](https://bolton.gov.uk/trafficorders)**

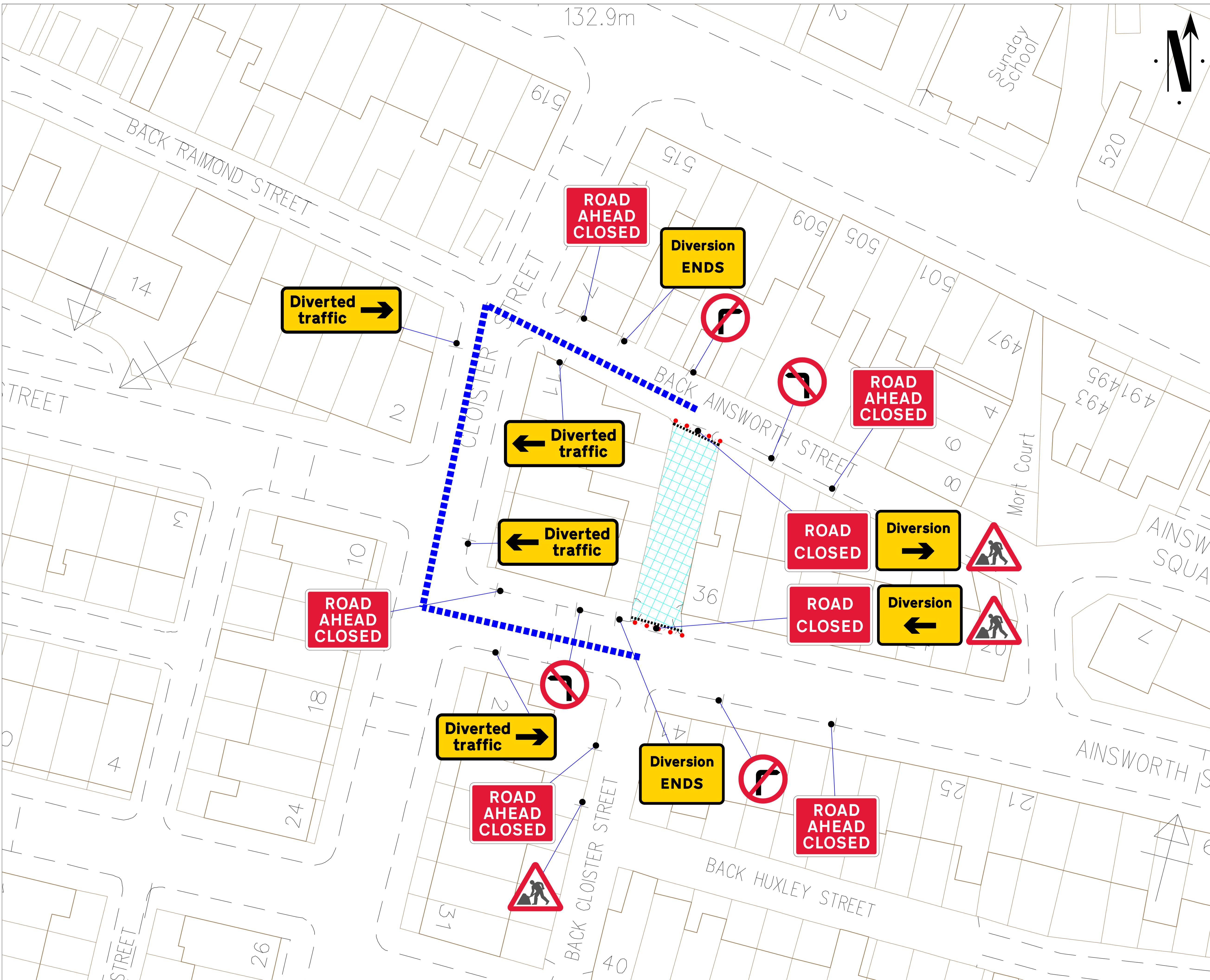

**Go Traffic Management**

This drawing has been produced for a specific client & project identified below and is not intended for use by any other person or for any other purpose. © Go Traffic Management

**Risks**

- Design completed from information provided + google maps desktop risk assessment
- Cone lamps must be used on all road with A speed limit of 40mph or more.

**Notes**

- All signs as per Chapter 8. Distances between cones to be 9m maximum unless otherwise noted.
- Distances between signs NOT to scale for purpose of clarity.
- All sign placement subject to available safe working space.
- The purpose of the Traffic Management Plan is for it to be used only as a guide and all traffic management equipment should be put out according to the 'Safety at Street Works and Road Works - Code of Practice', i.e. Red Book & the 'Traffic Signs Manual Chapter 8', i.e. Yellow Book.
- Lane width past the works to be 3.5m maximum, 3.25m desirable minimum and 3.0m absolute minimum.
- Stop & Go boards must be available and utilised in the event of permanent signal failure in accordance with Code of Practice.
- Signs must be placed in accordance with TSM and the scheme RAMS pack.
- Site conditions may have changed since the design of the drawing, any changes which subsequently affect the design need to be reported by the Traffic Management Operative & any changes implemented must comply with Chapter 8.

**Key**

- Sign position and aspect of vision
- Barriers
- Safety Zone
- Cones
- No Parking Cones
- Diversion Route 1
- Working space

**WRITTEN DIVERSION ROUTE**

BACK AINSWORTH STREET ↔ CLOISTER STREET ↔ AINSWORTH STREET

Traffic Management must comply with The Safety at Street Works and Road Works Code of Practice

**ROAD SPEED**

**30**

**CROSS SECTION**

DO NOT SCALE FROM THIS DRAWING.	Road Closure
REV: 17/08/2024	AS DRAWN
DATE	DESCRIPTION

**GTM**  
**Go Traffic Management**

Head Office: Go Traffic Management, Chaddock Lane, Worsley, Manchester, M28 1XW  
Tel: 0161 351 5370  
www.gtm.co.uk

**TRAFFIC MANAGEMENT PLAN**

Client: **United Utilities**  
**Water for the North West**

Drawing Number: 1120198.001

Drawing Title: 17, CLOISTER STREET, BOLTON, BL1 3JX

Design:	Technical Officer:	REV:
Name: M.A	L. Corcoran	
Signature:		
Date: 17/08/2024	17/08/2024	

BASED UPON THE ORDNANCE SURVEY MAP WITH THE PERMISSION OF THE CONTROLLER OF H.M. STATIONERY OFFICE.