

ROAD CLOSURE

**Bolton
Council**

NOTIFICATION OF TEMPORARY ROAD CLOSURE ROAD TRAFFIC REGULATION ACT 1984

STREET

Tempest Road

DATES

21 OCT 2024 for 2 weeks approx

(end date and duration are subject to change)

REASON / WORKS

Gas works

**Advertised public notice below
Diversion plans (if available) are attached**

THE BOROUGH COUNCIL OF BOLTON
ROAD TRAFFIC REGULATION ACT 1984 S.14
TEMPEST ROAD - TEMPORARY CLOSURE

The Council intends to make an order, operative from 21 October 2024 for 2 weeks approx, the effect of which will be to prohibit all traffic proceeding on Tempest Road from St Johns Wood to New Tempest Rd to allow gas works to take place. Alternate route will be via New Tempest Rd. The Order will end after 18 months or on completion of the works whichever first occurs.

Bolton Council. 30 September 2024.



If your waste or recycling bins are due to be emptied during road or resurfacing works, please present them at the nearest accessible point. This will ensure that your bins can be emptied on the usual collection day.

closures online at bolton.gov.uk/trafficorders

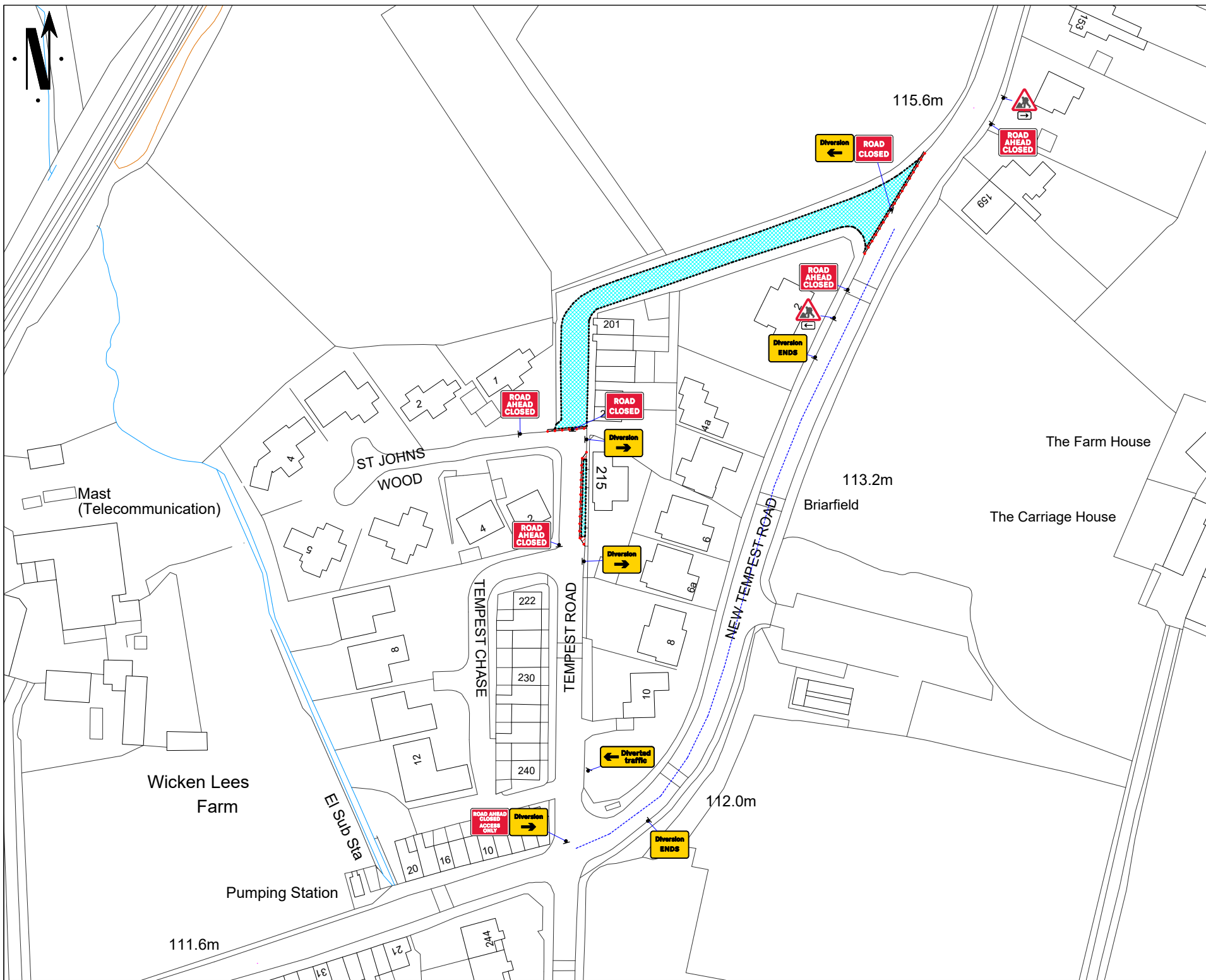

Go Traffic Management

This drawing has been produced for a specific client & project identified below and is not intended for use by any other person or for any other purpose. © Go Traffic Management

Risks

- Design completed from information provided + google maps desktop risk assessment
- Cone lamps must be used on all road with A speed limit of 40mph or more.

Notes

- All signs as per Chapter 8. Distances between cones to be 9m maximum unless otherwise noted.
- Distances between signs NOT to scale for purpose of clarity.
- All sign placement subject to available safe working space.
- The purpose of the Traffic Management Plan is for it to be used only as a guide and all traffic management equipment should be put out according to the 'Safety at Street Works and Road Works - Code of Practice', i.e. Red Book & the 'Traffic Signs Manual Chapter 8', i.e. Yellow Book.
- Signs must be placed in accordance with TSM and the scheme RAMS pack.
- Site conditions may have changed since the design of the drawing any changes which subsequently affect the design need to be reported by the Traffic Management Operative & any changes implemented must comply with Chapter 8.

Key

Sign position and aspect of vision	Work area
Cones	Diversion Route 1

WRITTEN DIVERSION ROUTE:
TEMPEST ROAD <=> NEW TEMPEST ROAD

9m REMAINING CARRIAGEWAY WIDTH REMAINS VULNERABLE ROAD USERS MUST FOLLOW DIVERSION

MINIMUM SAFETY ZONE OF 0.5M MUST BE ADHERED TO

Traffic Management must comply with The Safety at Street Works and Road Works Code of Practice

ROAD SPEED

30

CROSS SECTION

Road Closure

DO NOT SCALE FROM THIS DRAWING

REV.	DATE	DESCRIPTION
A	14/01/24	AS DRAWN

GTM

Go Traffic Management

Head Office: Go Traffic Management, Chaddock Lane, Worsley, Manchester, M28 1XW
Tel: 0161 351 5370
www.gtm.co.uk

CERTIFIED
ISO 9001:2015
ISO 14001:2015

TRAFFIC MANAGEMENT PLAN

Client: **Cadent**
Your Gas Network

Drawing Number: 870211.0002

Drawing Title: 215 Tempest Rd, Lostock, Bolton BL6 4ER

Design:	Technical Officer:	REV.
Name: M. Gardiner	J. Jones	
Signature:		A
Date: 14/01/24	14/01/24	