

ROAD CLOSURE

**Bolton
Council**

NOTIFICATION OF TEMPORARY ROAD CLOSURE ROAD TRAFFIC REGULATION ACT 1984

STREET

Streets rear of Knowsley Street

DATES

30 SEP 2024 for 5 months approx

(end date and duration are subject to change)

REASON / WORKS

Construction

**Advertised public notice below
Diversion plans (if available) are attached**

THE BOROUGH COUNCIL OF BOLTON
ROAD TRAFFIC REGULATION ACT 1984 S.14
STREETS REAR OF KNOWSLEY STREET - TEMPORARY CLOSURES AND REVOCATION OF
ONE-WAY TRAFFIC

The Council has made an order, operative from 30 September 2024 for 5 months approx, the effect of which will be to prohibit traffic from proceeding on Ridgway Gates, Brook Street and Back Knowsley Street, to allow construction works to take place.

The Order will also temporarily revoke the one-way traffic restriction on Palatine Street. The Order will end after 18 months or on completion of the works whichever first occurs.

Bolton Council. 27 September 2024.



If your waste or recycling bins are due to be emptied during road or resurfacing works, please present them at the nearest accessible point. This will ensure that your bins can be emptied on the usual collection day.

closures online at bolton.gov.uk/trafficorders

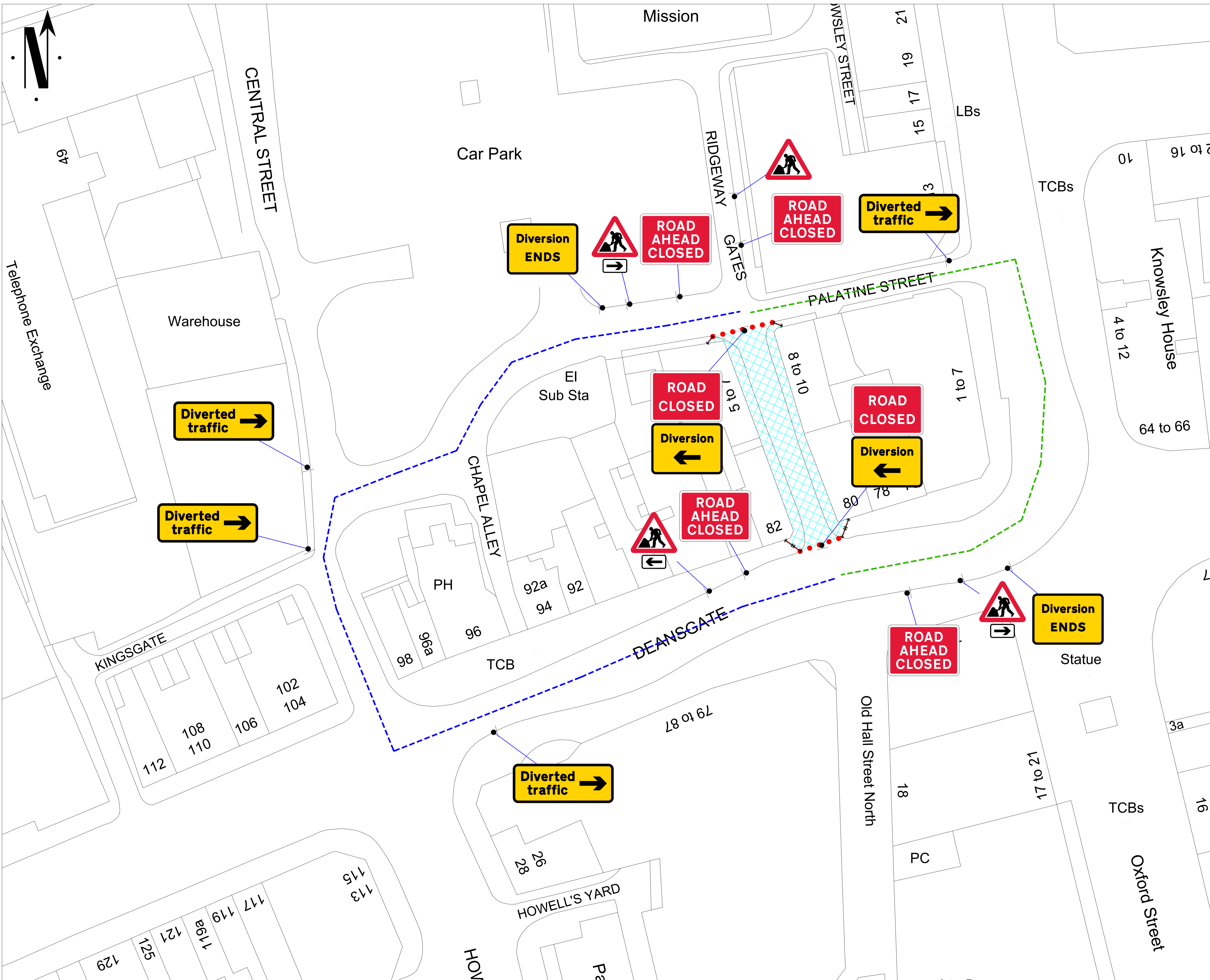

Go Traffic Management

This drawing has been produced for a specific client & project identified below and is not intended for use by any other person or for any other purpose. © Go Traffic Management

Risks

- Design completed from information provided + google maps desktop risk assessment
- Cone lamps must be used on all road with A speed limit of 40mph or more.

Notes

- All signs as per Chapter 8. Distances between cones to be 9m maximum unless otherwise noted.
- Distances between signs NOT to scale for purpose of clarity.
- All sign placement subject to available safe working space.
- The purpose of the Traffic Management Plan is for it to be used only as a guide and all traffic management equipment should be put out according to the 'Safety at Street Works and Road Works - Code of Practice', i.e. Red Book and the 'Traffic Signs Manual Chapter 8', i.e. Yellow Book.
- Signs must be placed in accordance with TSM and the scheme RAMS pack.
- Site conditions may have changed since the design of the drawing; any changes which subsequently affect the design need to be reported by the Traffic Management Operative & any changes implemented must comply with Chapter 8.

DETAILS

1. Single Dual carriageway closed in both directions with one-way traffic flow in both directions to the north of the road.

2. Single Dual carriageway closed in both directions with one-way traffic flow in both directions to the south of the road.

3. All signs as per Chapter 8. Distances between cones to be 9m maximum unless otherwise noted.

4. Distances between signs NOT to scale for purpose of clarity.

5. All sign placement subject to available safe working space.

Key

- Sign position and aspect of vision
- OS Work area
- Diversion Route 1
- Diversion Route 2

ROAD SPEED

30

ROAD CLOSURE

DO NOT SCALE FROM THIS DRAWING.

REV.	DATE	DESCRIPTION
A	25/06/24	AS DRAWN

GTM
Go Traffic Management

Head Office: Go Traffic Management,
Chaddock Lane, Worsley, Manchester, M28 1XW
Tel: 0161 351 5370
www.gtm.co.uk

CERTIFIED
R
ISO 9001:2015 - ISO 14001
OHSAS 18001

TRAFFIC MANAGEMENT PLAN

Client: **Network Plus**

Drawing Number: 1025302

Drawing Title:
5 Ridgeway Gates,
Bolton
BL1 2AQ

Name:	Design:	Technical Officer:	REV:
Signature:	V. Fanukov	L. Whittingham	A
Date:	25/06/2024	25/06/2024	

BASED UPON THE ORDNANCE SURVEY MAP WITH THE PERMISSION OF THE CONTROLLER OF H.M. STATIONERY OFFICE.