

# ROAD CLOSURE

**Bolton  
Council**

## NOTIFICATION OF TEMPORARY ROAD CLOSURE ROAD TRAFFIC REGULATION ACT 1984

### STREET

**Greensmith Way**

### DATES

**26 JUL 2024 for 1 day approx**

(end date and duration are subject to change)

### REASON / WORKS

**Utility works**

**Advertised public notice below  
Diversion plans (if available) are attached**

THE BOROUGH COUNCIL OF BOLTON  
ROAD TRAFFIC REGULATION ACT 1984 S.14  
GREENSMITH WAY - TEMPORARY CLOSURE

The Council intends to make an order, operative from 26 July 2024 between the hours of 9.30am and 3.00pm for 1 day approx. the effect of which will be to prohibit all traffic when proceeding on Greensmith Way at its junction with Church St, to allow utility works to take place. The Order will end after 18 months or on completion of the works whichever first occurs.

Bolton Council. 12 July 2024.



If your waste or recycling bins are due to be emptied during road or resurfacing works, please present them at the nearest accessible point. This will ensure that your bins can be emptied on the usual collection day.

**closures online at [bolton.gov.uk/trafficorders](https://bolton.gov.uk/trafficorders)**

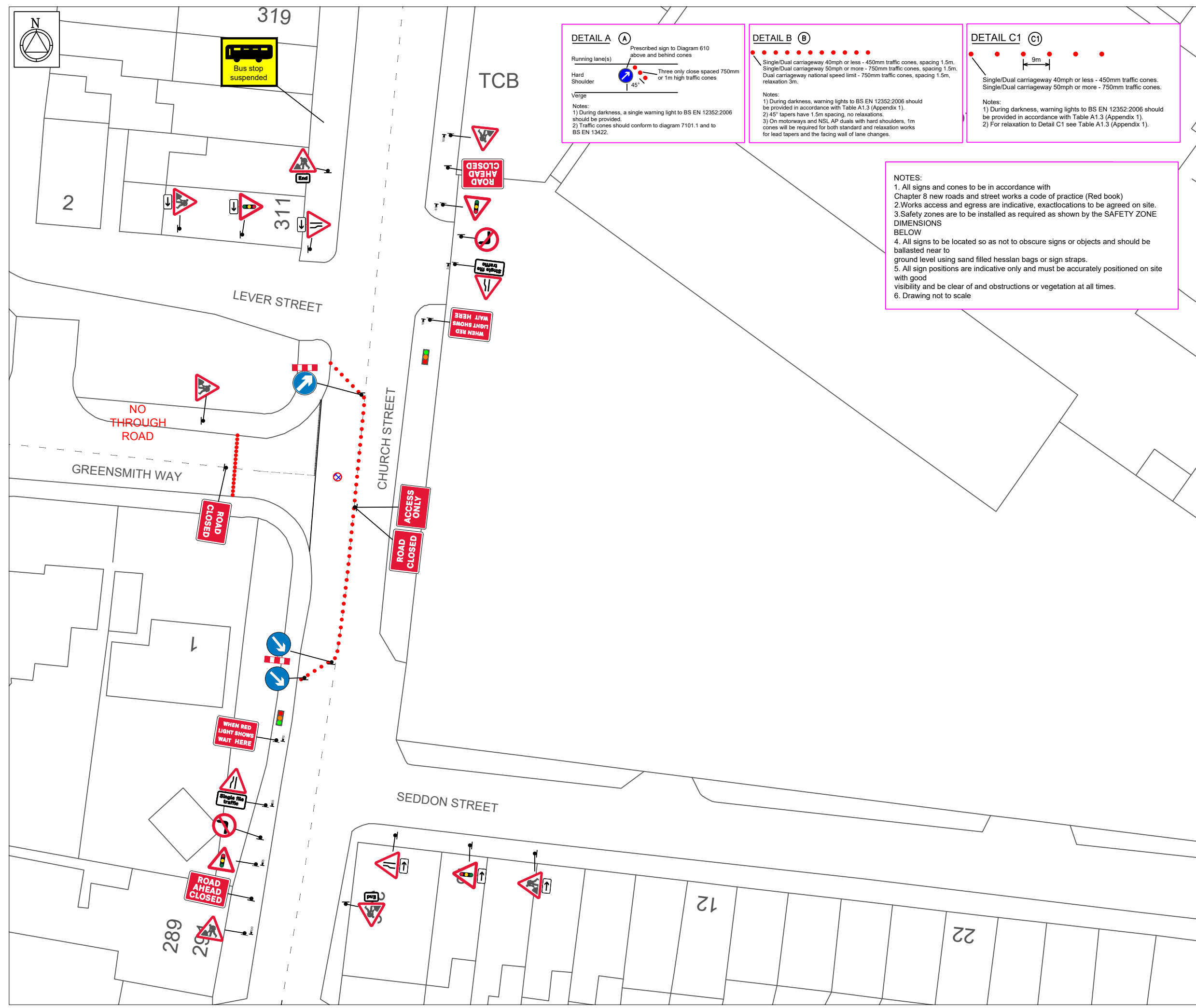

**DETAIL A (A)**

Prescribed sign to Diagram 610 above and behind cones

Running lane(s)

Hard Shoulder

Verge

Notes:

- During darkness, a single warning light to BS EN 12352:2006 should be provided.
- Traffic cones should conform to diagram 7101.1 and to BS EN 13422.

**DETAIL B (B)**

Single/Dual carriageway 40mph or less - 450mm traffic cones, spacing 1.5m.

Single/Dual carriageway 50mph or more - 750mm traffic cones, spacing 1.5m.

Dual carriageway national speed limit - 750mm traffic cones, spacing 1.5m, relaxation 3m.

Notes:

- During darkness, warning lights to BS EN 12352:2006 should be provided in accordance with Table A1.3 (Appendix 1).
- 45° tapers have 1.5m spacing, no relaxations.
- On motorways and NSL AP duals with hard shoulders, 1m cones will be required for both standard and relaxation works for lead tapers and the facing wall of lane changes.

**DETAIL C1 (C1)**

Single/Dual carriageway 40mph or less - 450mm traffic cones.

Single/Dual carriageway 50mph or more - 750mm traffic cones.

Notes:

- During darkness, warning lights to BS EN 12352:2006 should be provided in accordance with Table A1.3 (Appendix 1).
- For relaxation to Detail C1 see Table A1.3 (Appendix 1).

**NOTES:**

- All signs and cones to be in accordance with Chapter 8 new roads and street works a code of practice (Red book)
- Works access and egress are indicative, exact locations to be agreed on site.
- Safety zones are to be installed as required as shown by the SAFETY ZONE DIMENSIONS BELOW
- All signs to be located so as not to obscure signs or objects and should be ballasted near to ground level using sand filled hessian bags or sign straps.
- All sign positions are indicative only and must be accurately positioned on site with good visibility and be clear of and obstructions or vegetation at all times.
- Drawing not to scale

cadrequest@sus.co.uk tmbookings@sus.co.uk

**NOTES:**

⬇ Traffic sign      ➡ Diversion

● Cone

Work Area

Safety Zone

**WORKS ACCESS** **WORKS EXIT**

Works access/works exit to be risk assessed on site for suitability of location

**TRAFFIC MANAGEMENT NOTES**

2 WAY TRAFFIC SIGNALS :

**NOTES**

- All traffic signs shall comply with Chapter 8 of the Traffic Signs Manual
- Maximum distance between any two temporary traffic signals to be 240m. Minimum distance between any two temporary traffic signals to be 30m.
- Temporary traffic signals shall not occur within 150m of an existing level crossing. Pelican crossing or signalised junction without the consent of the Engineer. The Engineer shall consult with the authority responsible for any of these types of facility prior to traffic management being installed in adjacent areas.
- Coning shall be installed at 45° to the edge of carriageway, as generally indicated.
- Cable crossing protectors and P7010/P7013 signs shall be provided whenever control cables cross a section of carriageway open to traffic.
- The signal control mechanism shall normally be placed in a location from which it is possible to view all approaches to the site.
- Duplicate primary signal to be installed as instructed.
- Lane width past the works to be 3.7m maximum, 3.25m desirable minimum, 3.0m absolute minimum.

ROAD CLOSURE :

**NOTES**

- All traffic signs shall comply with Chapter 8 of the Traffic Signs Manual
- All traffic management equipment shall be provided by the Contractor, unless otherwise specified.
- All signs shall be positioned so as not to be obscured by any other objects and shall not obstruct any other sign, permanent or temporary as much as is reasonably practicable.
- All traffic signs shall meet the reflectorisation requirements of BS 673 - Part 6 : 1963, Table 1.
- Works Access/Egress to be positioned to suit ongoing works.

<b>SPEED OF ROAD:</b>			
LONGWAYS:	0.5		
SIDEWAYS:	0.5		
A	35	A	10
B	35	B	10
C	35	C	10
D	35	D	10

**CLIENT:**

Water for the North West

**SITE:**

1, GREENSMITH WAY, WESTHOUGHTON, BOLTON, BL5 3BR

**GRID REF:** -----

**TITLE:** 2 WAY TEMPORARY TRAFFIC SIGNALS AND ROAD CLOSURE

SCALE AT A3:	DATE:	DRAWN:	CHECKED:
NTS	17/06/2024	JD	JB

DWG NO:	REV NO:
SUS8064	001