

# ROAD CLOSURE

**Bolton  
Council**

## NOTIFICATION OF TEMPORARY ROAD CLOSURE ROAD TRAFFIC REGULATION ACT 1984

STREET

**Bar Lane**

DATES

**22 JUL 2024 for 3 weeks approx**

(end date and duration are subject to change)

REASON / WORKS

**Gas**

**Advertised public notice below  
Diversion plans (if available) are attached**

THE BOROUGH COUNCIL OF BOLTON  
ROAD TRAFFIC REGULATION ACT 1984 S.14  
BAR LANE - TEMPORARY CLOSURE

The Council intends to make an order, operative from 22 July 2024 for 3 weeks approx. the effect of which will be to prohibit all traffic when proceeding on Bar Lane from Blackburn Rd to Hawarden St, to allow gas works to take place. Alternate route will be via Westminster Rd, Belmont Rd. The Order will end after 18 months or on completion of the works whichever first occurs.

Bolton Council. 1 July 2024.



If your waste or recycling bins are due to be emptied during road or resurfacing works, please present them at the nearest accessible point. This will ensure that your bins can be emptied on the usual collection day.

**closures online at [bolton.gov.uk/trafficorders](https://bolton.gov.uk/trafficorders)**



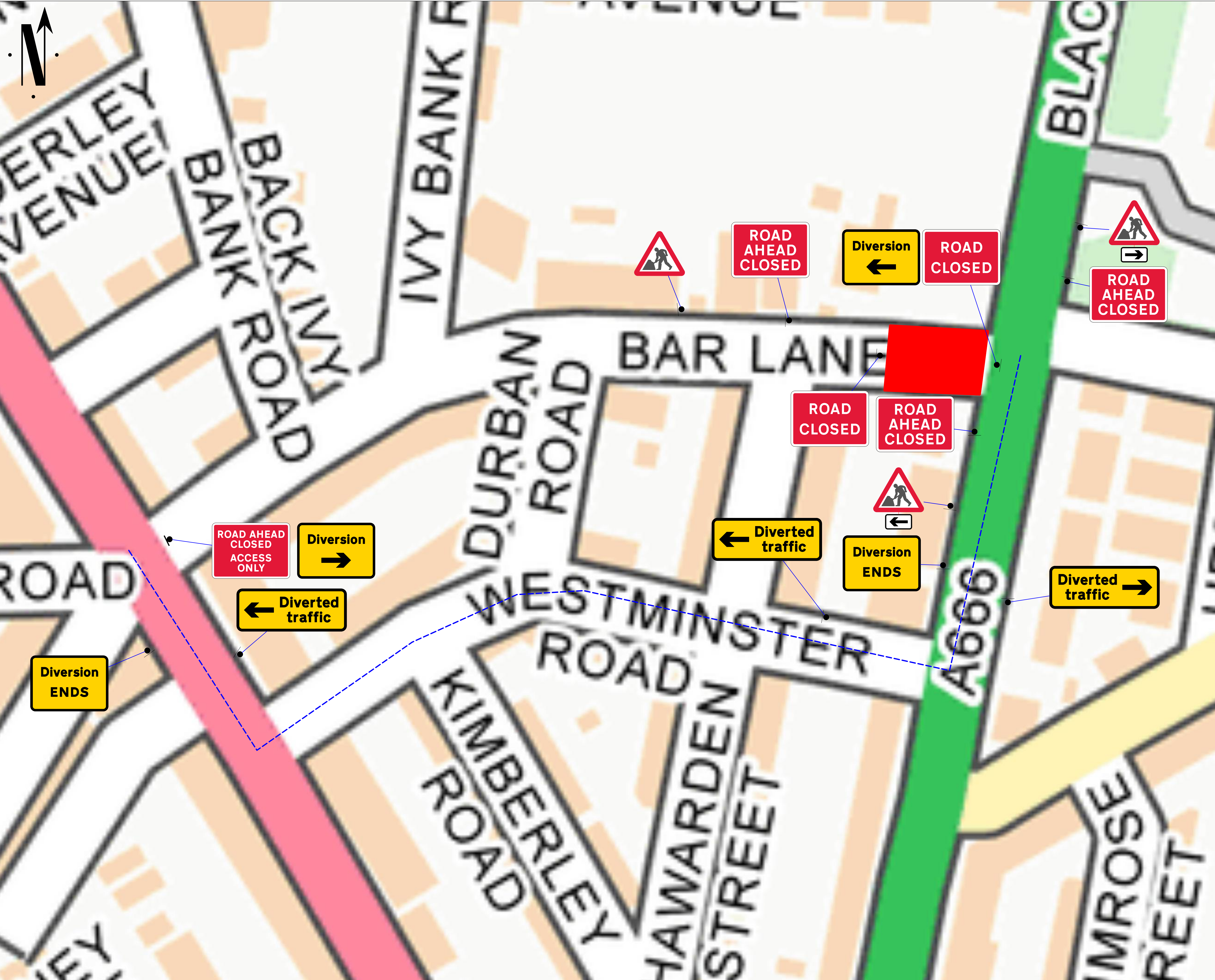

Go Traffic Management

This drawing has been produced for a specific client & project identified below and is not intended for use by any other person or for any other purpose. © Go Traffic Management

Risks

1. Design completed from information provided + google maps desktop risk assessment

2. Cone lamps must be used on all road with A speed limit of 40mph or more.

Notes

1. All signs as per Chapter 8. Distances between cones to be 9m maximum unless otherwise noted.

2. Distances between signs NOT to scale for purpose of clarity.

3. All sign placement subject to available safe working space.

4. The purpose of the Traffic Management Plan is for it to be used only as a guide and all traffic management equipment should be put out according to the 'Safety at Street Works and Road Works - Code of Practice', i.e. Red Book & the 'Traffic Signs Manual Chapter 8', i.e. Yellow Book.

5. Signs must be placed in accordance with TSM and the scheme RAMS pack.

6. Site conditions may have changed since the design of the drawing any changes which subsequently affect the design need to be reported by the Traffic Management Operative & any changes implemented must comply with Chapter 5.

Key

Sign position and aspect of vision

Cones

Work area

Diversion Route 1

WRITTEN DIVERSION ROUTE.

A666 ⇄ Westminster Road ⇄ Belmont Rd

Traffic Management must comply with The Safety at Street Works and Road Works Code of Practice

ROAD SPEED

30

CROSS SECTION

2 cones

2 cones

DO NOT SCALE FROM THIS DRAWING.

ROAD CLOSURE

A

07.05.24

AS DRAWN

REV.

DATE

DESCRIPTION

GTM

Go Traffic Management

Head Office: Go Traffic Management,  
Chaddock Lane, Worsley, Manchester, M28 1XW  
Tel: 0161 351 5370  
www.gtm.co.uk

CERTIFIED

R

ISO 9001: ISO 14001  
01545 18901

TRAFFIC MANAGEMENT PLAN

Client:

Cadent

Your Gas Network

Drawing Number: 972795

Drawing Title:

Bar Ln, Bolton, BL1 8RP

Design:

Technical Officer:

REV:

Name:

C.R

J.McNamara

Signature:

Date:

07.05.24

07.05.24

A

BASED UPON THE ORDNANCE SURVEY MAP WITH THE PERMISSION OF THE CONTROLLER OF H.M. STATIONERY OFFICE.