

# ROAD CLOSURE

**Bolton  
Council**

## NOTIFICATION OF TEMPORARY ROAD CLOSURE ROAD TRAFFIC REGULATION ACT 1984

STREET

**Lynstock Way**

DATES

**13 JUL 2024 for 2 days approx**

(end date and duration are subject to change)

REASON / WORKS

**Tree maintenance**

**Advertised public notice below  
Diversion plans (if available) are attached**

THE BOROUGH COUNCIL OF BOLTON  
ROAD TRAFFIC REGULATION ACT 1984 S.14  
LYNSTOCK WAY - TEMPORARY CLOSURE

The Council intends to make an order, operative from 13 July 2024 for 2 days, the effect of which will be to prohibit all traffic when proceeding on Lynstock Way from Lostock Ln for 100m. The Order will end after 18 months or on completion of the works whichever first occurs.

Bolton Council. 21 June 2024.



If your waste or recycling bins are due to be emptied during road or resurfacing works, please present them at the nearest accessible point. This will ensure that your bins can be emptied on the usual collection day.

**closures online at [bolton.gov.uk/trafficorders](https://bolton.gov.uk/trafficorders)**

**Key**

<b>01A</b> ADVANCED WARNING ACCESS TO ROAD AHEAD CLOSED ON ___ TO ___ FOR ___ DAY(S) FROM ___ TO ___	<b>01</b> ROAD CLOSED P7105 750mm	<b>02</b> Diverion ENDS	<b>04</b> Diverted traffic →	<b>06</b> Diverted traffic ↑	<b>08</b> Diversion ←	<b>10</b> ROAD AHEAD CLOSED	<b>12</b> Diverted traffic ↻	<b>14</b> Diverted traffic ↻	<b>15</b> ACCESS ONLY
		<b>03</b> Diverion ENDS	<b>05</b> Diverted traffic ←	<b>07</b> Diversion →	<b>09</b> Diversion ↑	<b>11</b> Diverted traffic ↻	<b>13</b> Diverted traffic ↻		

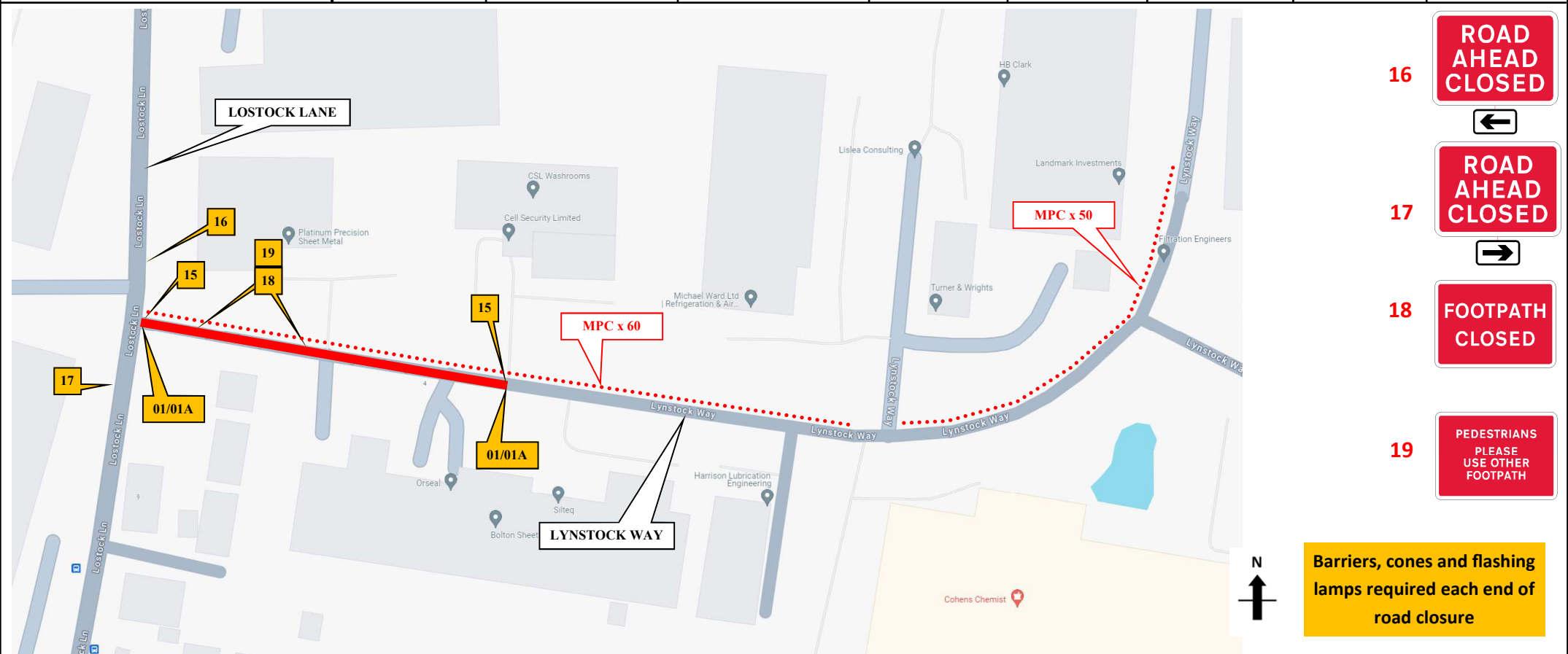

© Contains OS data Crown copyright and database rights 2024

**SUNBELT RENTALS**

Sunbelt Rentals UK (Traffic Management)  
Kemble Airfield Enterprise Park  
Cirencester Road  
Kemble  
GL7 6BQ  
☎ 03700 500 792  
📠 0845 004 7105

**Note**

- All equipment shall be approved and shall comply with the Department Of Transport specification MCE0111. This drawing does not show the normal road works signage that will be required as per Chapter 8.
- All signs to be in accordance with TSRGD 2016 and to minimum class retroreflective.
- Minimum height of lettering to be 60mm and sign boards to be 1000mm (750mm where appropriate).

This drawing is protected by copyright and the information contained therein is confidential.  
This drawing may not be copied and the information therein may not be used, or disclosed to a third party, wholly or in part with the written permission of Sunbelt Rentals UK (Traffic Management).

CROWN COPYRIGHT DATA REPRODUCED BY PERMISSION OF THE CONTROLLER OF HMSO

<b>CLIENT DETAILS</b> OPENREACH		<b>REP/DEPOT</b> SR/186	<b>DRAWN BY</b> SG/864	<b>ADDRESS</b> NR LOSTOCK COURT LYNSTOCK WAY BOLTON BL6 4SG
<b>DATE</b> 15/04/2024	<b>SHEET No</b> 1 OF 1	<b>VERSION NUMBER</b> XXX		<b>BUS ROUTE AFFECTED</b>
<b>AMENDED DATE</b> XX	<b>AMENDED BY</b> XX	<b>SCALE</b> NOT TO SCALE		
This layout is for installation by NRSWA, Lantra 12A,12B,,12D qualified persons.				

	ROAD CLOSURE		CLOCKWISE DIVERSION
	DIVERSION		ANTI-CLOCKWISE DIVERSION
			ROAD CLOSURE SIGN
<b>ROAD CLOSURE LENGTH (APPROX)</b>		350 M	
<b>ROAD CLOSURE WIDTH (APPROX)</b>		6.5 M	
<b>Contract Number 186-S008179</b>			