

Road Closures

**Bolton
Council**

**ROAD
CLOSED**

**NOTIFICATION OF TEMPORARY ROAD CLOSURE
ROAD TRAFFIC REGULATION ACT 1984**

STREET

Freshfield Avenue

DATES

11 DEC 2023 for 18 months approx

(end date and duration are subject to change)

REASON / WORKS

Construction

Advertised public notice below

Diversion plans (if available) are attached

THE BOROUGH COUNCIL OF BOLTON
ROAD TRAFFIC REGULATION ACT 1984 S.14
FRESHFIELD AVENUE - TEMPORARY CLOSURE

The Council intends to make an order, operative from 11 December 2023 for 18 months approx, the effect of which will be to prohibit all traffic from proceeding on Freshfield Avenue, from West Meade to East Meade, to allow construction works to take place. The Order will end after 18 months or on completion of the works whichever first occurs.

Bolton Council. 4 December 2023.



If your waste or recycling bins are due to be emptied during road or resurfacing works, please present them at the nearest accessible point. This will ensure that your bins can be emptied on the usual collection day.

[bolton.gov.uk/trafficorders](https://www.bolton.gov.uk/trafficorders)

Qty: 2 Ref: 13-9 Schedule 13-9 - Temporary Information	
Qty: 1 Ref: 2702 Start of temporary diversion route	
Qty: 2 Ref: 2702 End of temporary diversion route	
Qty: 1 Ref: 2702 Start of temporary diversion route	
Qty: 4 Ref: 2703 Direction of temporary diversion route from junction ahead	
Qty: 1 Ref: 573 Direction to hazard right	
Qty: 4 Ref: 7001 Road works ahead	
Qty: 3 Ref: 7010-FP-13-9 Nature of temporary hazard ahead - Road Ahead Closed	
Qty: 3 Ref: 7010-FP-13-9 Nature of temporary hazard ahead - Road Closed	

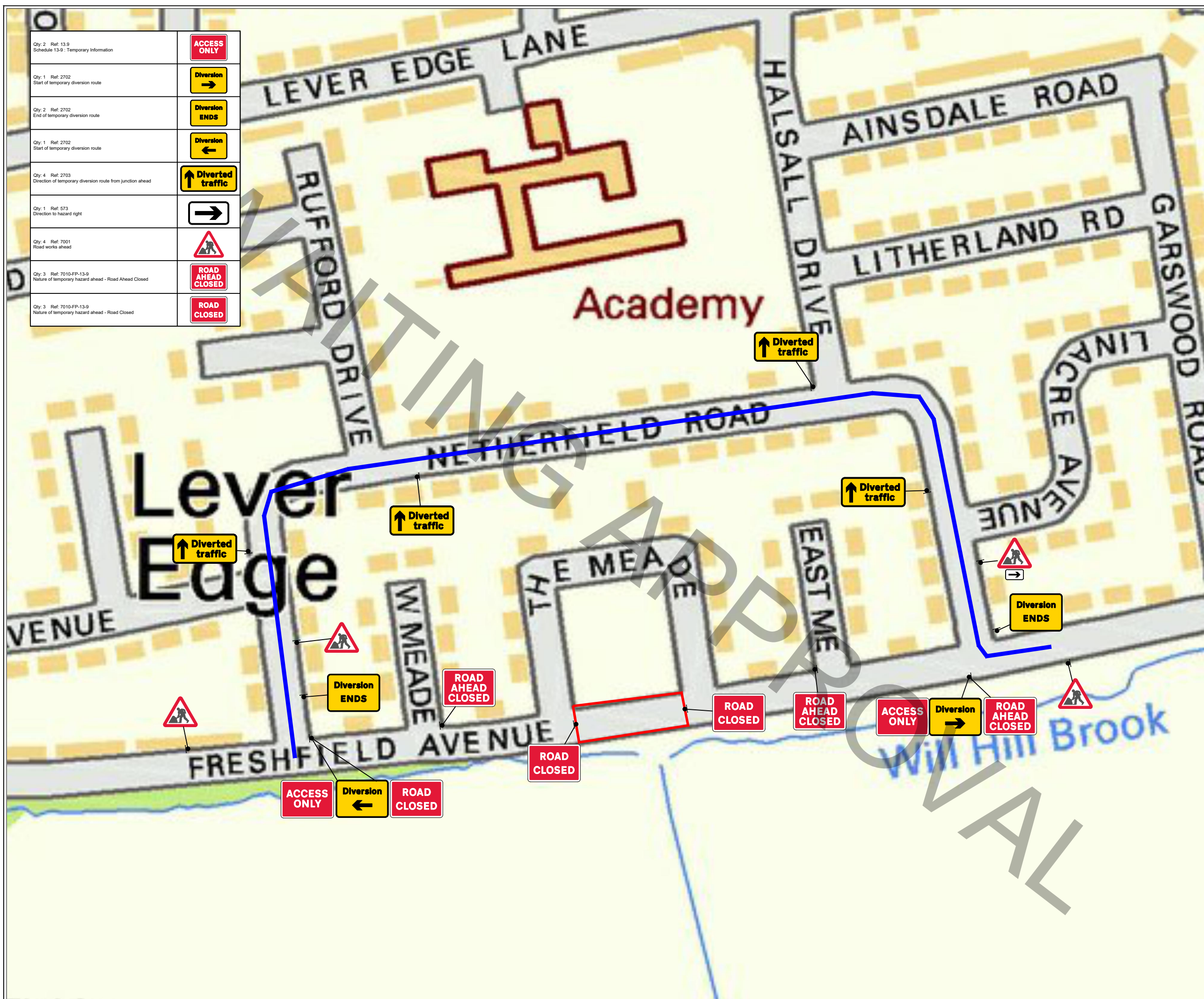

Notes:

THIS DRAWING MAY BE USED ONLY FOR THE PURPOSE INTENDED AND ONLY WRITTEN DIMENSIONS SHALL BE USED

- All dimensions in metres.
- Sign locations indicative only, exact sign locations to be determined on site.
- Refer to Chapter 8 TSM for key to detail.
- All TM will be installed in Accordance with Chapter 8 of the Traffic signs Manual
- Workforce In Road SLOW to be risk assessed in advance of the Initial man at work sign



KEY

	Traffic sign		Road Closure
	Traffic cone/cylinder		Work Vehicles
	Traffic signals to Diagram 3000.1		Diversion Route
	Pedestrian crossing signal		
	Pedestrian barrier		
	Stop/Go board		

N

Amberon SAFE SITE HOME TONIGHT REMEMBER SAFETY TACTICS

Customer Name
Gallifordtry

Project Name
Freshfield Ave, Bolton, BL3 3EZ

Drawing Title
Road Closure Diversion

Requested:	R.CRAWFORD	15/03/22
Drawn:	ELIOT.SHEA	15/03/22
Approved:	R.CRAWFORD	15/03/22
Revision:	Approved By:	Date:

Details:

Revision:	Approved By:	Date:
-----------	--------------	-------

Drawing Number:
MAR22.090

Original Drawing Size : NTS
Scale : **Not To Scale** Dimensions : DIMS
Contract/ Advice Note Number: **M123456**