

PUBLIC NOTICE

**THE BOROUGH COUNCIL OF BOLTON
ROAD TRAFFIC REGULATION ACT 1984
THE BOLTON (Chulsey Gate; Public Rights of Way)
(TEMPORARY EMERGENCY CLOSURE) (No.1Bol343) NOTICE 2024**

The Borough Council of Bolton hereby enacts the temporary closure of Restricted Byway Bolton 343 from this date and for approximately 5 days, in exercise of its powers under Section 14(2) of The Road Traffic Regulation Act 1984.

The effect of this Notice will be to prohibit all traffic using:

Restricted Byway Bolton 343 commencing from a point on Chulsey Gate Lane point A at grid reference SD 66835 07731 in a generally west by north direction to point B on Chulsey Gate Lane at grid reference SD 66660 07770; as shown by the bold black line on the Order plan 1Bol349 over a total distance of approximately 176 metres.

An alternative route will be made available, details of the route will be published on site.

The closure is necessary because of the likelihood of danger to the public and to facilitate the demolition and construction of a bridge.

Dated this 21st June 2024

Jon Dyson, Director of Place Services,
Town Hall, Bolton,
BL1 1RU

[bolton.gov.uk/highways](https://www.bolton.gov.uk/highways)

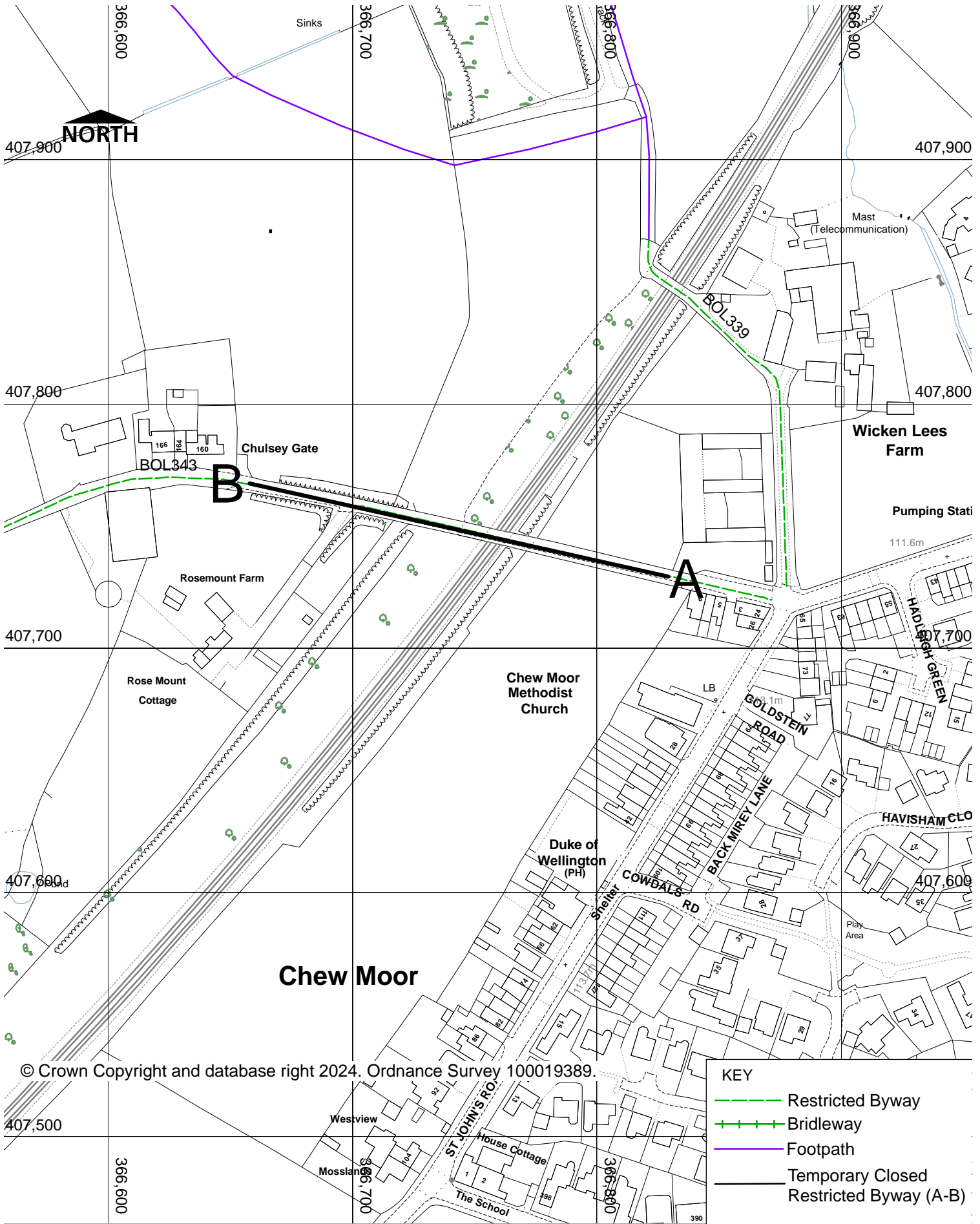

© Crown Copyright and database right 2024. Ordnance Survey 100019389.

KEY	
	Restricted Byway
	Bridleway
	Footpath
	Temporary Closed Restricted Byway (A-B)



HIGHWAY AND ENGINEERING DIVISION
PUBLIC RIGHTS OF WAY

THE BOROUGH COUNCIL OF BOLTON
Public Right of Way Bolton 343
Temporary Emergency Closure Notice Section 14 RTA 1984

DIRECTORATE OF PLACE

Jon Dyson
Director of Place
Town Hall, Victoria Square, Bolton, BL1 1RU

Date
20/06/2024

Scale
1:2000

Drawn
AS

Drg. No.
1Bol343