

ANTI-SOCIAL BEHAVIOUR, CRIME AND POLICING ACT 2014
BOROUGH COUNCIL OF BOLTON
NOTICE OF INTENTION TO MAKE A PUBLIC SPACES PROTECTION ORDER
DUCKSHAW LANE & FLETCHER STREET, FARNWORTH

1. Notice is hereby given that Borough Council of Bolton (“the Council”) intends to make the above Public Spaces Protection Order under Sections 59, 64 and 72 of the Anti-Social, Behaviour, Crime and Policing Act 2014 (“the Act”).
2. The Proposed Order would restrict, by erecting barriers, the use of the public right of way over Duckshaw Lane from its junction with Fletcher Street for a distance of 50m in a northerly direction across its full width & Fletcher Street from its junction with Duckshaw Lane for a distance of 50m in an easterly direction across its full width for all times and dates (including Bank Holidays) except the following:
 - Monday – Friday: 8.00am – 6.00pm.
 - Saturday: 8.00am – 12.00pm.
3. The Order will contain exemptions for any registered owner of, or any person who lives in, occupies or works in premises adjoining the Restricted Area, emergency services personnel, statutory undertakers and utility providers.
4. The Order and plan are available for inspection on the Council’s website at www.bolton.gov.uk/alleygating and also at the Community Safety Services, Third Floor, Town Hall, Bolton during office hours.
5. Objections/representations must state the grounds on which they are made and sent:
 - via the online survey at www.bolton.gov.uk/consultations (just click on ‘Active Consultations’ and select ‘Duckshaw Lane / Fletcher Street proposed alley gating scheme 2020’);
 - by e-mail to Community.Safety.Services@bolton.gov.uk; or
 - in writing to Community Safety Services, Third Floor, Town Hall, Bolton, BL1 1RU

not later than **23rd December 2020**.

Dated 23/11/2020

H Gorman, Borough Solicitor
Chief Executive's Department
Town Hall, Bolton, BL1 1RU

ANTI-SOCIAL BEHAVIOUR, CRIME AND POLICING ACT (2014)

BOROUGH COUNCIL OF BOLTON

THE DUCKSHAW LANE / FLETCHER STREET, FARNWORTH
PUBLIC SPACES PROTECTION ORDER (202X)

The Borough Council of Bolton in exercise of its powers under Sections 59, 64 and 72 of the Anti-Social Behaviour, Crime and Police Act 2014 (“the Act”) hereby make the following Order: -

1. This Order shall come into operation on the **XXXX** and shall have effect for three years thereafter, unless extended by further Orders under the Council’s statutory powers.

2. This Order relates to

- Duckshaw Lane – from its junction with Fletcher Street for a distance of 50m in a northerly direction across its full width;
- Fletcher Street – from its junction with Duckshaw Lane for a distance of 50m in an easterly direction across its full width.

(the Restricted Area / PSPO Gated Area) as specified on the Order Plan.

3. Except as provided in Article 4 of this Order the effect will be to restrict the public right of way over the Restricted Area, for all times and dates (including Bank Holidays) except the following:

- Monday – Friday: 8.00am – 6.00pm
- Saturday: 8.00am – 12.00pm

Barriers may be installed, operated, and maintained to enforce the restriction over the Restricted Area.

4. The restriction in Article 3 of this Order shall not apply to any registered owner of, or person who lives or works in, land or premises adjoining the Restricted Area, or to any police, ambulance or fire service personnel, acting in pursuance of statutory powers or duties or to any statutory undertaker, gas, electricity, water or communications provider requiring access to their apparatus situated in the Restricted Area, or persons and/or vehicles required, where necessary, in connection with maintenance work or other function of the Council.

5. The Council is satisfied that the conditions set out in Sections 59, 64 and 72 of the Act of 2014 have been satisfied and that it is in all the circumstances expedient to make this Order for the purposes of combatting, within the Restricted Area, crime and anti-social behaviour including fly tipping or the illegal dumping of waste which have had a detrimental effect on the quality of life of those in the locality. The effect or likely effect of this is of a persistent or continuing nature such as to make this unreasonable and justifies the restrictions imposed by this Order.

6. A person found in breach of this Order shall be liable on summary conviction to a fine not exceeding level 3 on the standard scale.

7. If any interested person desires to question the validity of this Order on the grounds that the Council has no power to make it or that any requirement of the Act has not been complied with in relation to this Order, he or she may apply to the High Court within six weeks from the date on which this Order is made.

8. The alternative route for pedestrians and vehicular traffic is as follows: north along Duckshaw Lane from rear of 8 Albert Grove to the junction with St Germain Street; north-east along St Germain Street (from number 7 St Germain Street to the north of 74 Albert Road); south along Albert Road to its junction with Fletcher Street; west along Fletcher Street (south of 108 Fletcher Street).

**THE COMMON SEAL of THE
BOROUGH COUNCIL OF**

BOLTON was hereto affixed
on the **DATE**
in the presence of: -

Authorised Sealing Officer

DRAFT

NORTH

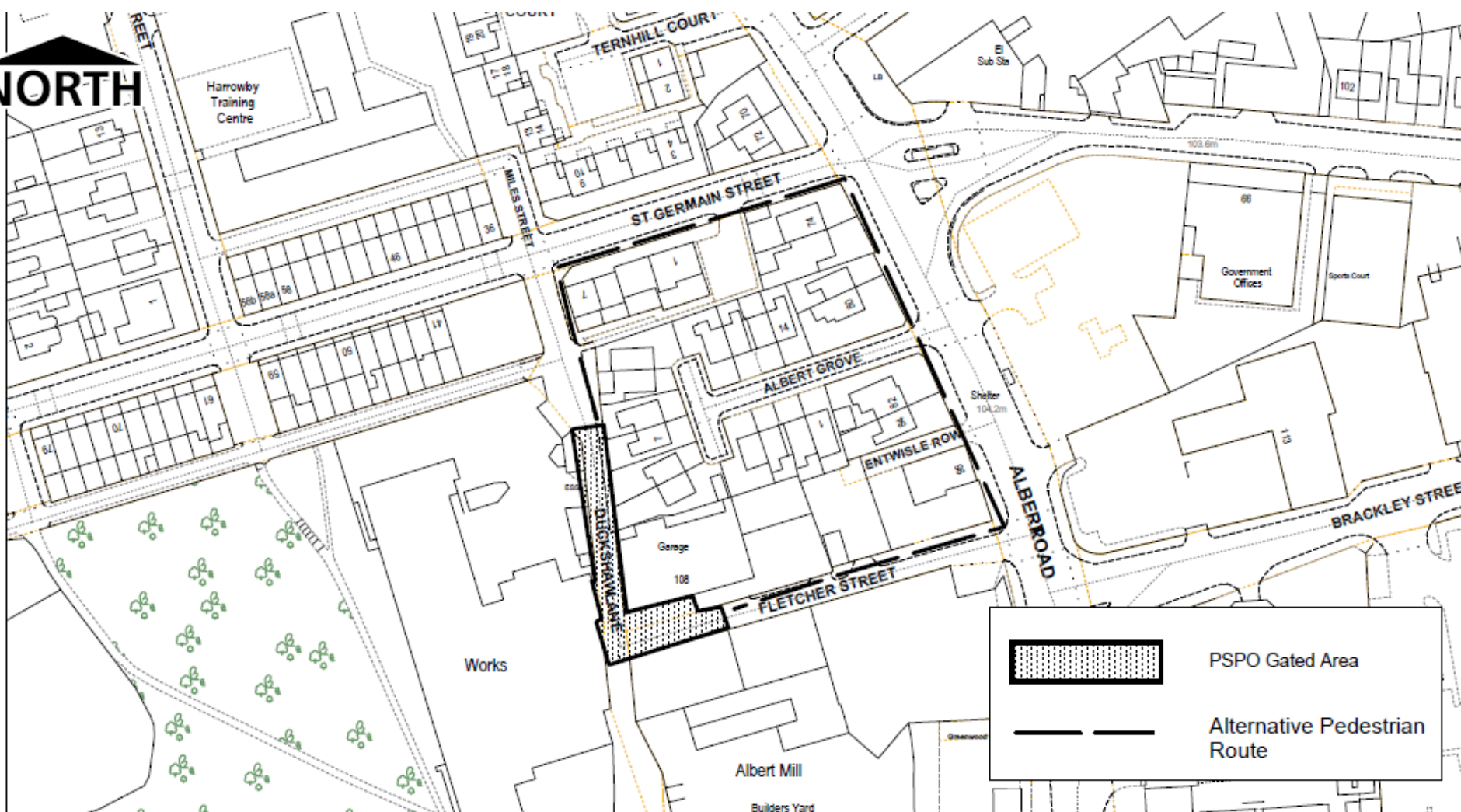

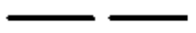
	PSPO Gated Area
	Alternative Pedestrian Route

Bolton Council

Highways & Engineering Division
Paderborn House
Bolton BL1 1UA
www.bolton.gov.uk/highways

Duckshaw Lane/Fletcher Street - Public Space Protection Order - Gated Area Plan

Page 1 of 1

SCALE	1 : 1250
DATE	15/10/2020
DRAWING No.	DLFS/PSPO
DRAWN BY	JF
CHECKED BY	DL

© Crown copyright and database rights
Bolton Council.
Licence No. 100019389 2020