

**Bolton Council**

**Statutory Public Register for recording applications under Section 53 B of the Wildlife and Countryside Act**

Relevant legislation:

The Highways Act 1980

The Public Rights of Way (Register of Applications under section 53(5) of the Wildlife and Countryside Act 1981) (England) Regulations 2005

**The Register**

Any enquiries relating to the register should be made to: Email: [prow@bolton.gov.uk](mailto:prow@bolton.gov.uk) Telephone No.: 01204 333333

If you wish to inspect the register it is held at the following office:

Bolton Council, Highways & Engineering Division, Public Rights of Way, 3<sup>rd</sup> Floor Paderborn House, Howell Croft North, Bolton, BL1 1UA.

Please make prior arrangements to inspect the register by contacting the public rights of way team on the above telephone number or email address.

Please note that if the inclusion of the applicants name and address is likely to cause damage or substantial distress to the applicant or to another person, the name and address of the applicant recorded on the register shall be removed from the register or shall not be included on the register, and shall be redacted from any documents contained or to be contained on the register:

Index No	File Number	Description of the location of the land (text , Start - OS ref, End - OS ref)	Parish, Ward or District	Nearest Town	Name, Address of person making the Application	Date Received	Intended effect of application	Address of buildings on the land	Date set for determination	Date of determination	Decision of the surveying authority	Where the surveying authority has refused an application, the outcome of any appeal	Terms of any direction by the Secretary of State	Details of whether or not the order was confirmed
95-0701	301041	Darcy Lever Railway				07/1995					??			
95-0702		Snow Hill Road				07/1995					Not progressed due to incomplete / Insufficient evidential forms or failure to serve notice on landowner.			
95-08		Wallsuches FP to BW				08/1995					Not progressed due to incomplete / Insufficient evidential forms or failure to serve notice on landowner.			
97-05		Egerton Barn 87 metres long SD711149 to SD711148				05/1997					Claimant does not want to progress claim at present			
97-03		Ellen Grove Kearsley SD764039 to SD767042				03/1997					Not progressed due to incomplete / Insufficient evidential forms or failure to serve notice on landowner.			
97-07		Unity Brook Kearsley				07/1997					Not progressed due to incomplete / Insufficient evidential forms or failure to serve notice on landowner.			
98-11		Harpers Lane/Moss Bank Way				11/1998					Not progressed due to incomplete / Insufficient evidential forms or failure to serve notice on landowner.			
99-11		Kearsley Moss			Lancashire Wildlife Trust	11/1999					Not Progressed			
01-0401		Fp's/BW's at Moses Gate				04/2001							Direction from GONW to progress claim	Order confirmed
01-0402		Little Stones Road, Egerton, BL7 9UN		Bolton		04/2001					Claim withdrawn / Not progressed - Claimed route no longer blocked			

Index No	File Number	Description of the location of the land (text , Start - OS ref, End - OS ref)	Parish, Ward or District	Nearest Town	Name, Address of person making the Application	Date Received	Intended effect of application	Address of buildings on the land	Date set for determination	Date of determination	Decision of the surveying authority	Where the surveying authority has refused an application, the outcome of any appeal	Terms of any direction by the Secretary of State	Details of whether or not the order was confirmed
	301041	Darcy Lever Railway, Gorses Road to Hollycroft Avenue, Darcy Lever  704 metres from SD734083 to SD741083	Little Lever and Darcy Lever	Bolton		04/2002					Not progressed		The advertised order was invalid and flawed.	Not Confirmed
01-09	301036	Nellies Clough - Footpath to Bridleway  SD651112 to SD649107	Horwich	Horwich	####	09/2002	Upgrading of a footpath to bridleway				Not progressed			
03-12		Forest Road	Smithills	Bolton	####	12/2003					Not progressed due to failure of claimant to serve notice on landowner.			
	301000	Croftside to Fogg Lane  641 metres from SD743079 to SD742074	Little Lever and Darcy Lever	Little Lever	####	12/2003	Addition of a bridleway	Old Hall Farm, Croftside, Bolton BL3 1AP			Not Progressed - path within a Country Park and available for use.			
	301026	Printers Lane, BL2 3DW  382 metres long from SD730128 to SD733128	Bromley Cross	Bolton	####	12/2004	Addition of a footpath	None			Refused			
	301030	Ginnel at 166 Tonge Moor Road  20 metres long from SD728103 to SD728103	Tonge with Haulgh	Bolton	####	03/2005	Addition of a footpath	166 Tonge Moor Road			Refused	Appeal Allowed	To make and advertise an Order	Order Confirmed. Added to map as BOL512.
	301053	29 Rose Hill Close, Bromley Cross, Bolton, BL7 9JW  75 metres long SD724132 to SD725132	Bromley Cross	Bolton	####	09/2007	Addition of a footpath	29 Rose Hill Close			Not progressed due to failure of claimant to serve notice on landowner.			
	301057	Ascot Road, Little Lever, Bolton, BL3 1ED  103 metres long from SD745071 to SD746071	Little Lever and Darcy Lever	Little Lever	####	12/2007	Addition of a footpath between Ascot Road and the Bolton, Bury Canal	None			Not progressed due to failure of claimant to serve notice on landowner.			
	301052	Morris Farm, Pocket Nook Road  92 metres long from SD669072 to SD669071	Westhoughton North and Chew Moor	Westhoughton	####	08/2008	Addition of a footpath	Morris Farm Pocket Nook Road			No Further Action - Dedication agreements received and notice of dedication advertised. Footpath added to map as BOL513.			
	301065	Bryant's Acre, Bolton, BL1 5XJ  187 metres long from SD676093 to SD676091	Heaton and Lostock	Bolton	####	02/2009	Addition of a footpath	None			Not progressed due to failure of claimant to serve notice on landowner.			
09-0901		Former Hilton House Branch Railway Line – Dicconson Lane to Jacks Lane - 2km long from SD631077 to SD634058	Westhoughton North and Chew Moor	Westhoughton	####	09/2009	Addition of a footpath	None			Claim withdrawn by applicant.			

Index No	File Number	Description of the location of the land (text , Start - OS ref, End - OS ref)	Parish, Ward or District	Nearest Town	Name, Address of person making the Application	Date Received	Intended effect of application	Address of buildings on the land	Date set for determination	Date of determination	Decision of the surveying authority	Where the surveying authority has refused an application, the outcome of any appeal	Terms of any direction by the Secretary of State	Details of whether or not the order was confirmed
09-0902		Fern Street to River Croal  154 metres from SD704087 to SD702086	Rumworth	Bolton	####	09/2009	Addition of a footpath	None			Not progressed due to failure of claimant to serve notice on landowner.			
	301077	High Bank Street to Leverhulme Park via Edditch Farm  46 metres long from SD734091 to SD734090	Tonge with Haulgh ward	Bolton	####	03/12/2010	Addition of a footpath	Edditch Farm, High Bank Street, Tonge Fold, Bolton BL2 6BP		06/2012	Refused	Appeal Allowed	To make and advertise an order	Order Confirmed 28/09/2015 Added to map as BOL516
	301082	Druids Close to Chapel Street, Egerton via s/o 22A Druids Close  24 metres long from SD709151 to SD709151	Bromley Cross	Bolton	####	07/2011	Addition of a footpath	None		06/2012	Accepted	N/A	N/A	Order Confirmed. Added to map as TEG059.
201309		Ladybridge High School New York to Wigan Road  Length and grid references unknown	Lostock	Bolton	####	09/2013	Addition of a footpath	Ladybridge High School, New York, Bolton, BL3 4NG			Not progressed due to insufficient evidential forms and failure of claimant to serve notice on landowner. No map showing the walked route attached to claim.			
201403		Regents Park Golf Course – St Andrews Road to the Restricted Byway across the golf course  590 metres long from SD366448 to SD366649	Heaton & Lostock	Bolton	####	03/2014	Addition of a footpath	Regents Park Golf Club, Links Rd, Lostock, Bolton. BL6 4AF			Not Required	N/A	N/A	PROW to be created via agreement
201406		233/235 Leigh Road – Leigh Road to the back street to the rear of 233/235 Leigh Road  23 metres long from SD365896 to SD365919	Westhoughton South	Westhoughton	####	06/2014	Addition of a footpath	233/235 Leigh Road, Westhoughton, Bolton, BL5 2JG		11/2014	Refused	Appeal Refused 17/08/2015	N/A	N/A
201801		Millennium Wood, Longsight Lane to public footpath TBS043  15 metres long from SD374028 411536 to SD374037 411527	Bradshaw	Bolton	####	01/2018	Addition of a footpath	None			Not progressed due to insufficient evidential forms and failure of claimant to serve notice on landowner.			
201808		Lakenheath Drive – Path off Lakenheath Drive to Hill Cot Road Route A-B 338 metres long from SD372087 412521 to SD371919 412289 Route A-C 541 metres long from SD372087 to SD371842 412272 Route A-D 745 metres long from SD372087 412521 to SD371738 412212	Astley Bridge	Bolton	####	08/2018	Addition of three footpaths	Sharples School, Hill Cot Road, Bolton, BL1 8SN			provisionally and in principle a compromise agreement has been reached between the applicant and the school. Claim not being progressed.			



**Copy of Maps Submitted (in date order)**

Date: 04/2002 File No: 301041  
Darcy Lever Railway,  
Gorses Road to Hollycroft Avenue, Darcy Lever

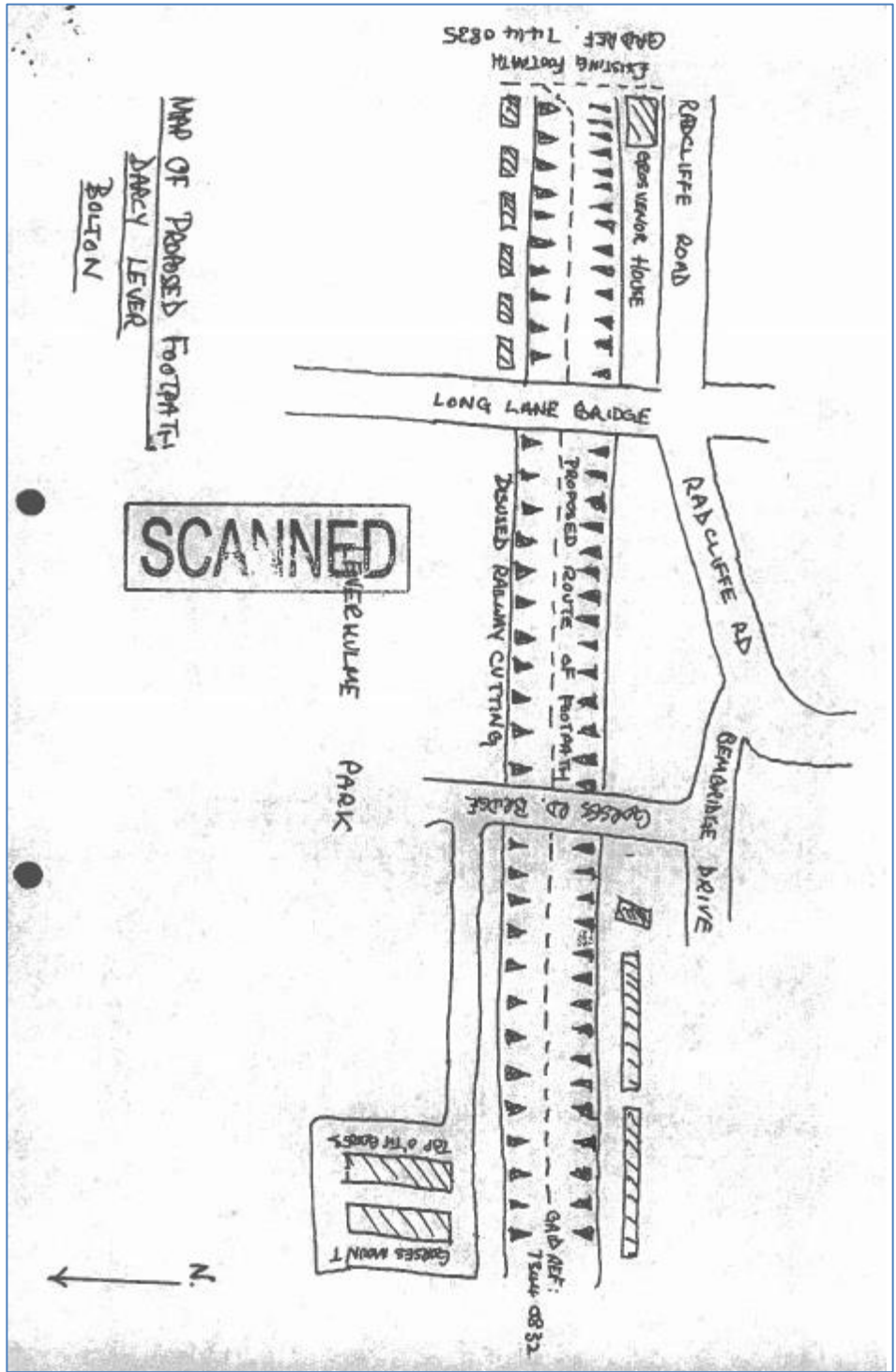

Date: 02/2009

File No: 301036

Nellies Clough, Horwich - Footpath to Bridleway

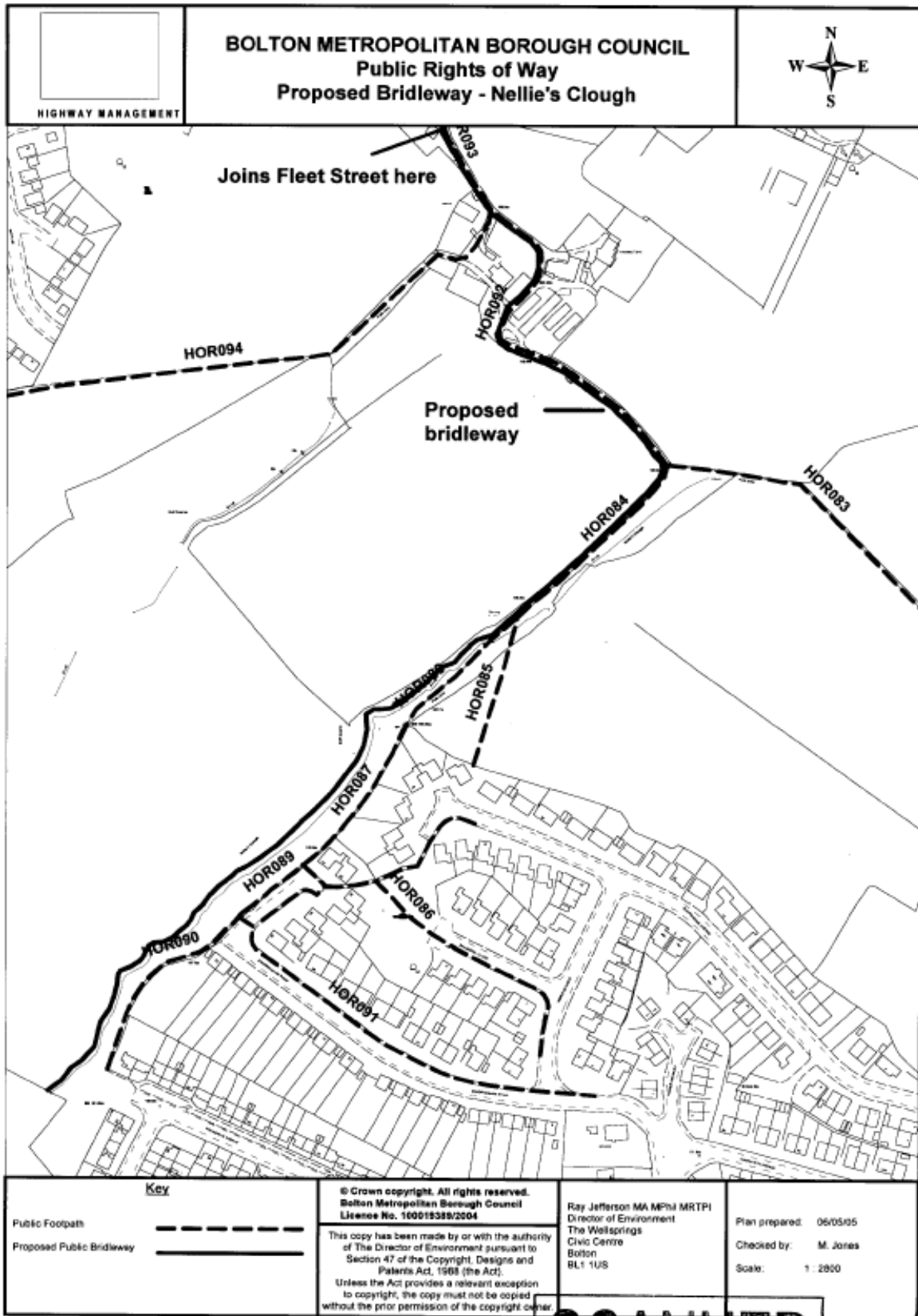

Date: 12/2003

File No 301000

Croftside to Fogg Lane – Bridleway

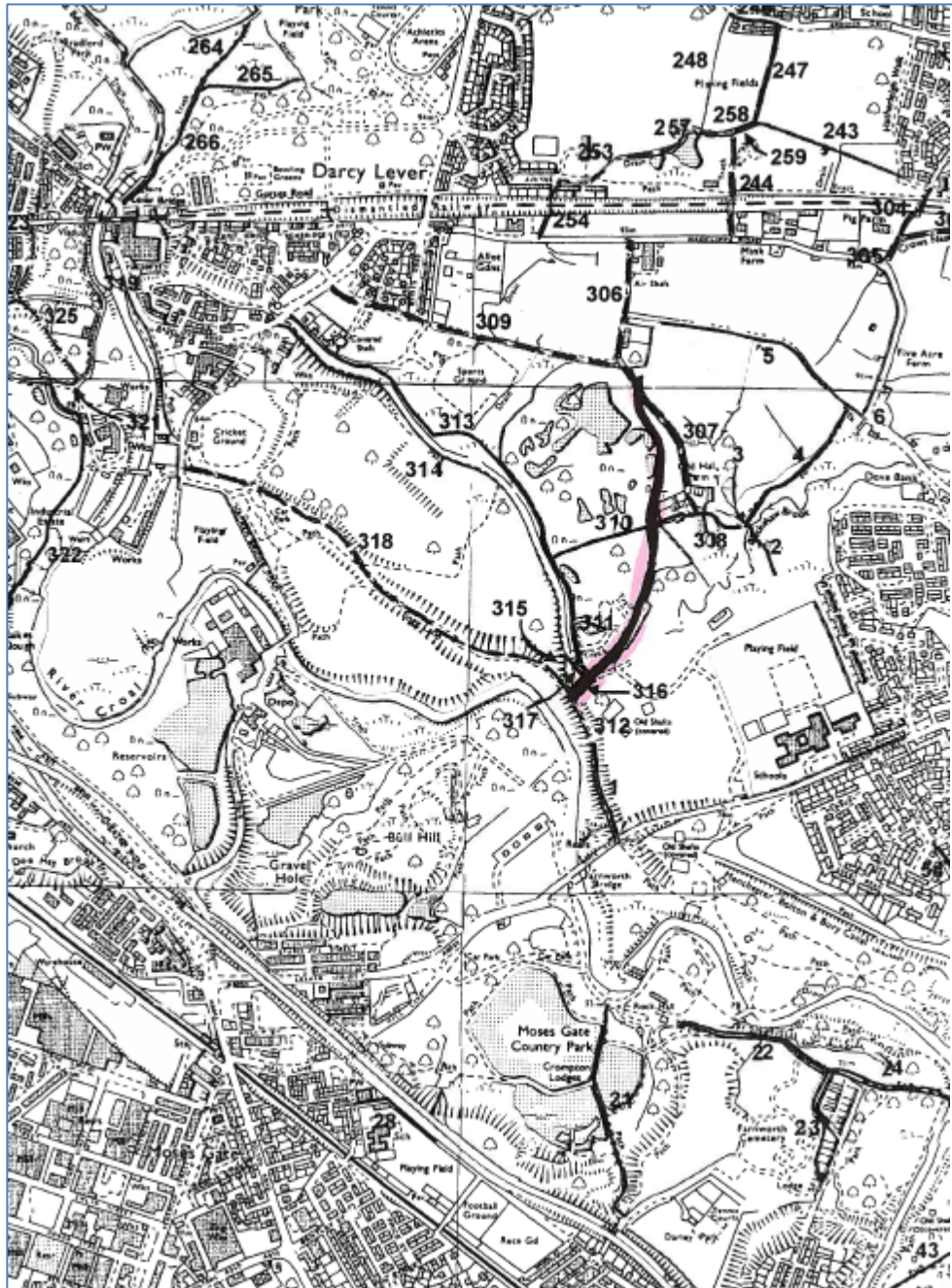

Date: 12/2004

File No 301026

Printers Lane, BL2 3DW

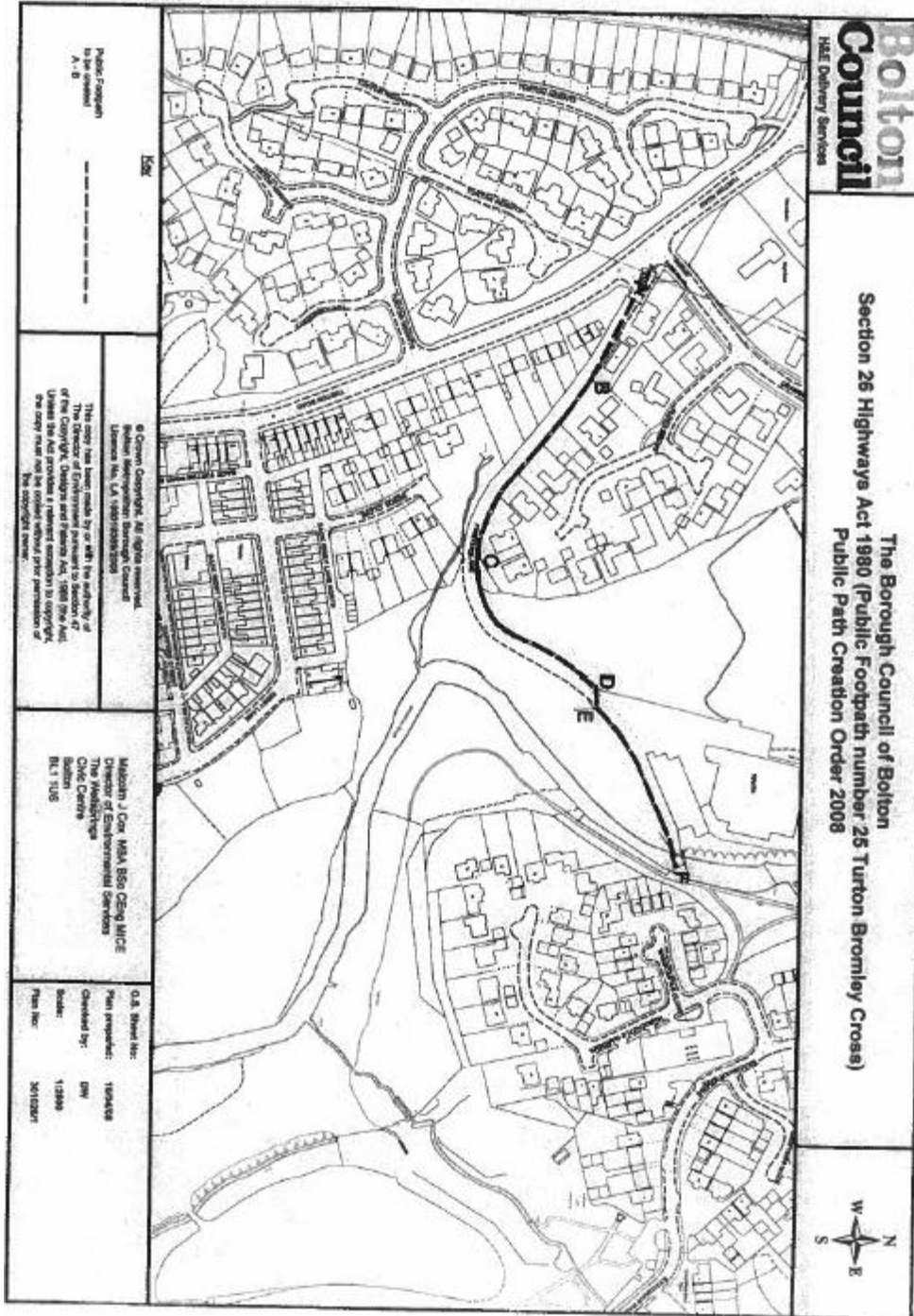



Date: 03/2005

File No 301033

Ginnel at 166 Tonge Moor Road, Bolton



Date: 09/2007

File No: 301053

Rose Hill Close, Bromley Cross, Bolton, BL7 9JW

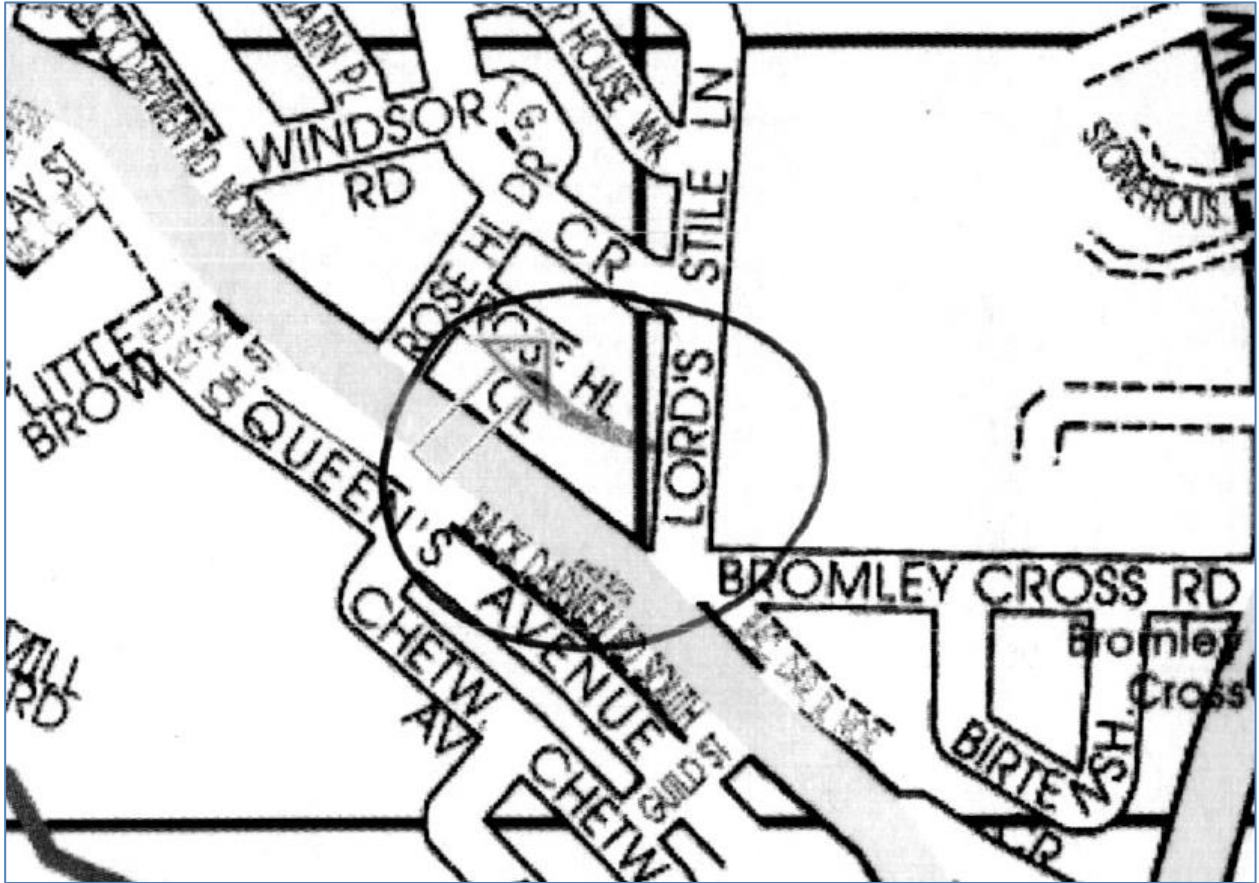

Date: 12/2007

File No: 301057

Ascot Road, Little Lever – Path connecting with canal side.

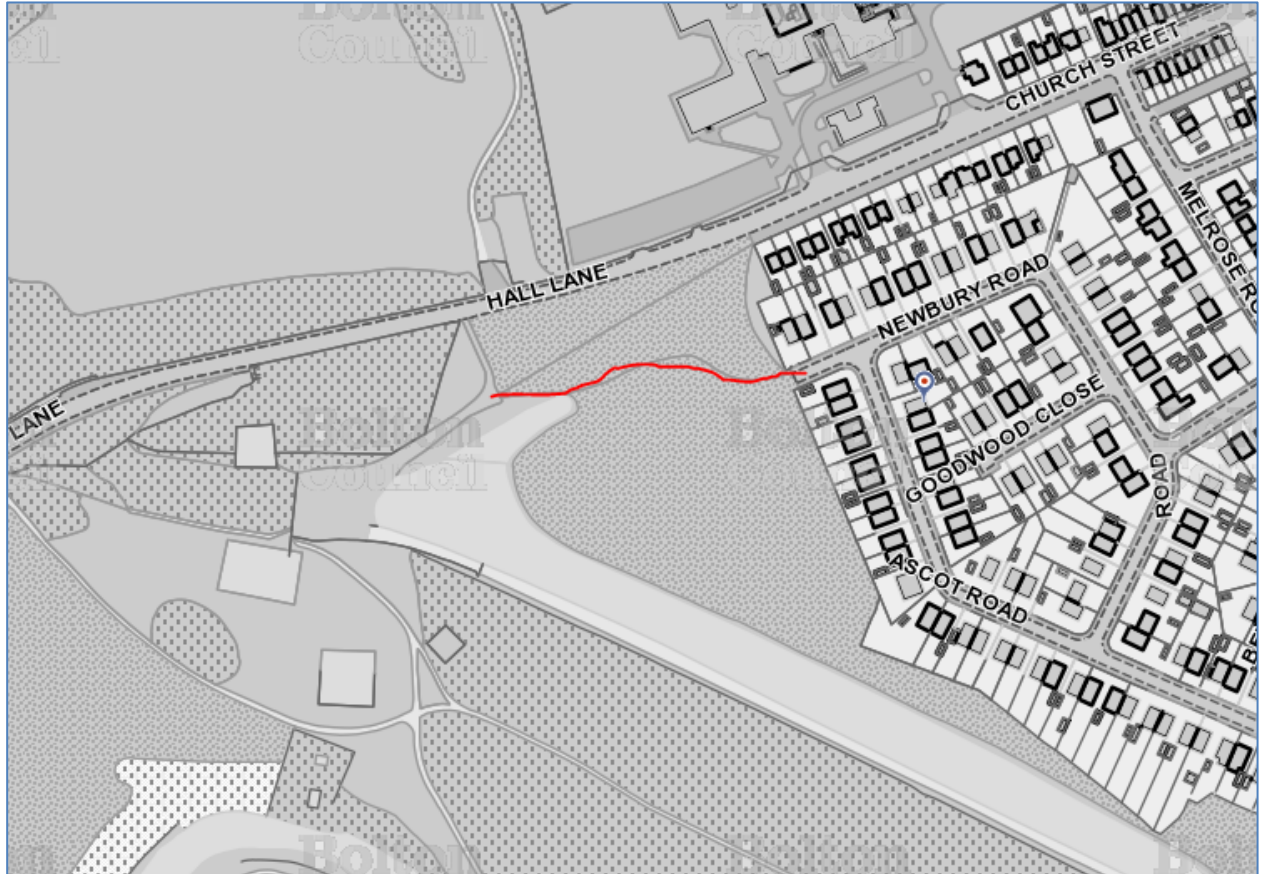

Date: 08/2008

File No

301052

Morris Fold Farm, Pocket Nook Road

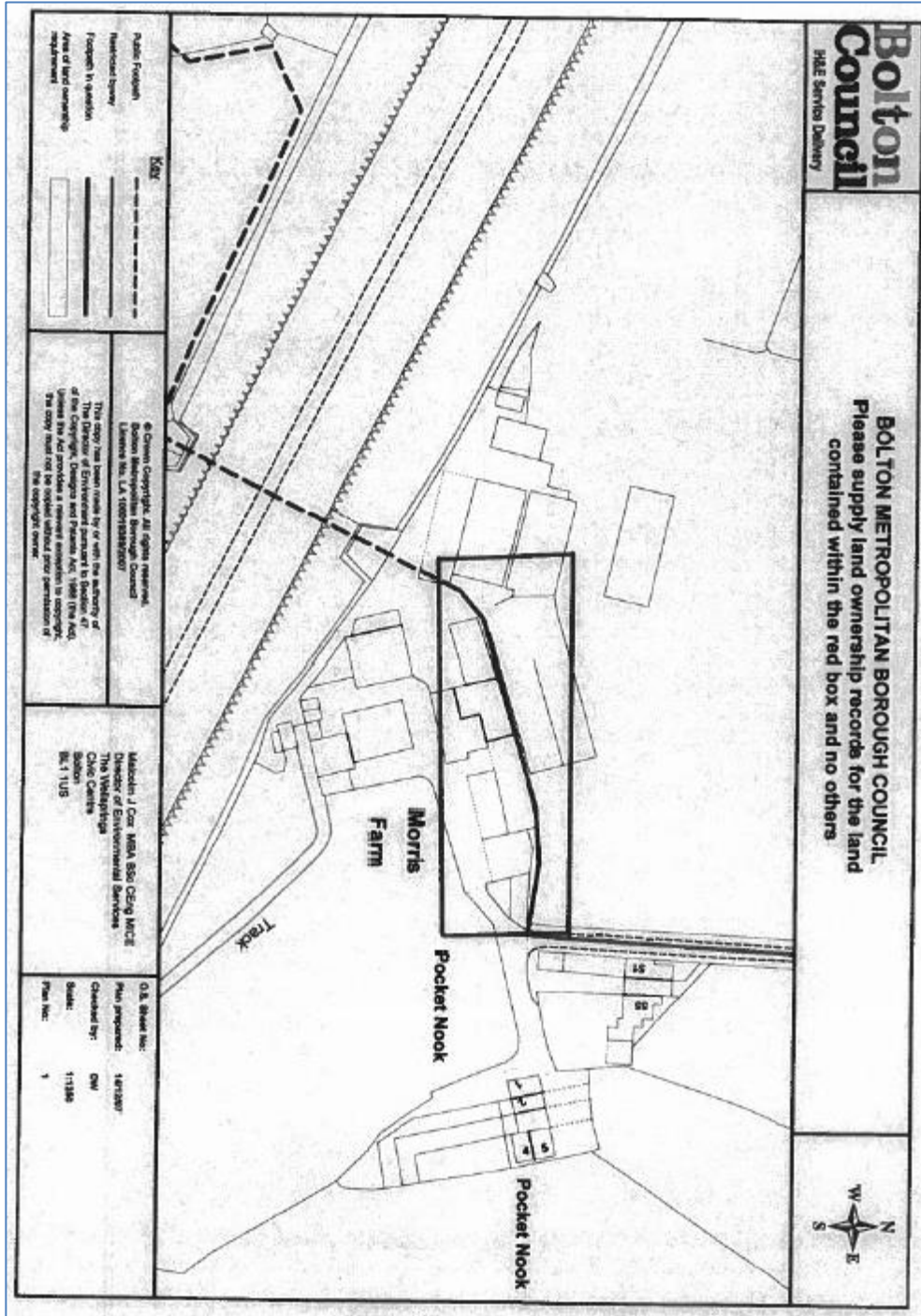

Date: 02/2009

File No: 301065

Bryants Acre to Garsdale Lane

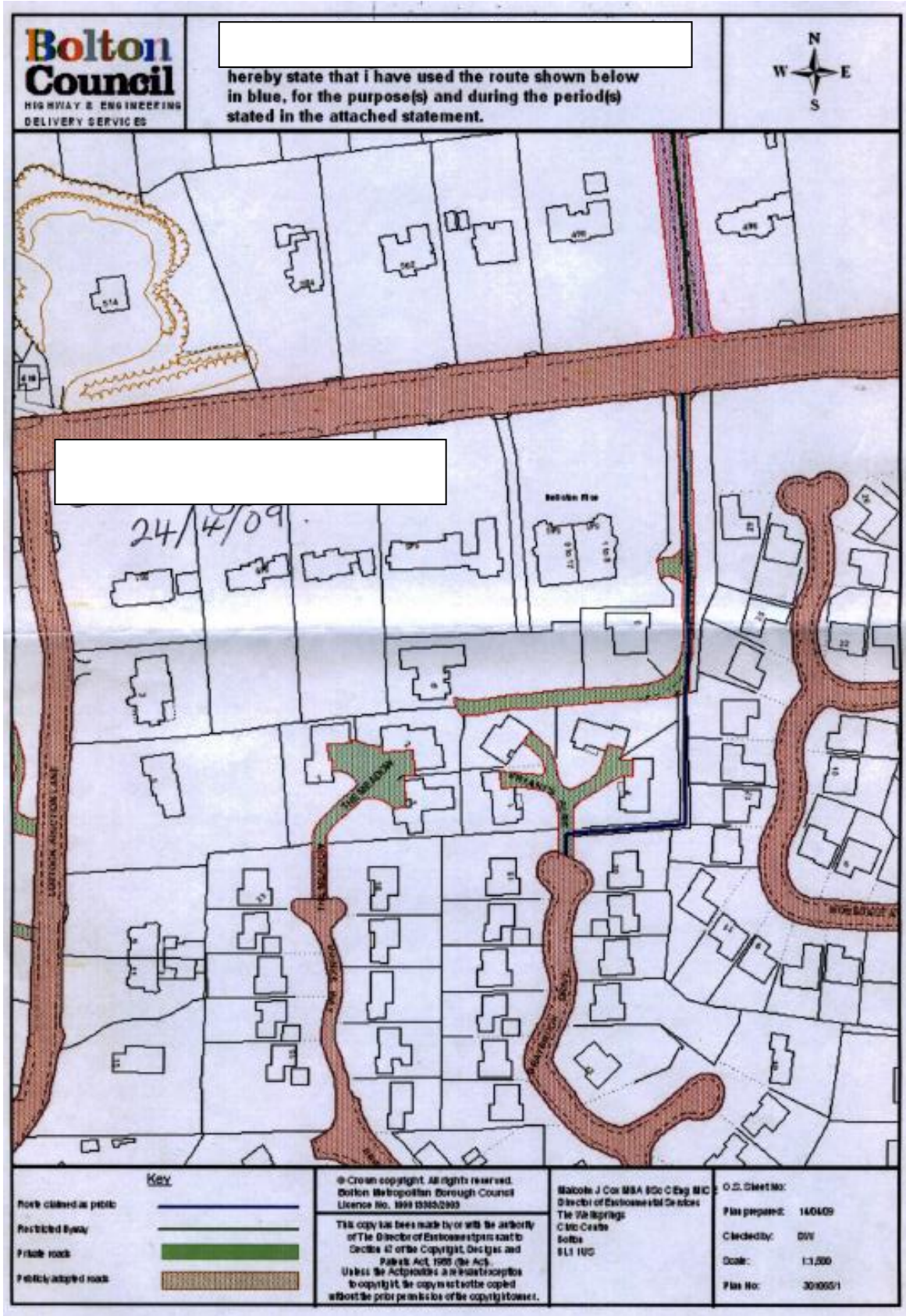

Date: 09/2009

Index No

2009-0901

Former Hilton House Branch Railway Line – footpath from Dicconson Lane to Jacks Lane

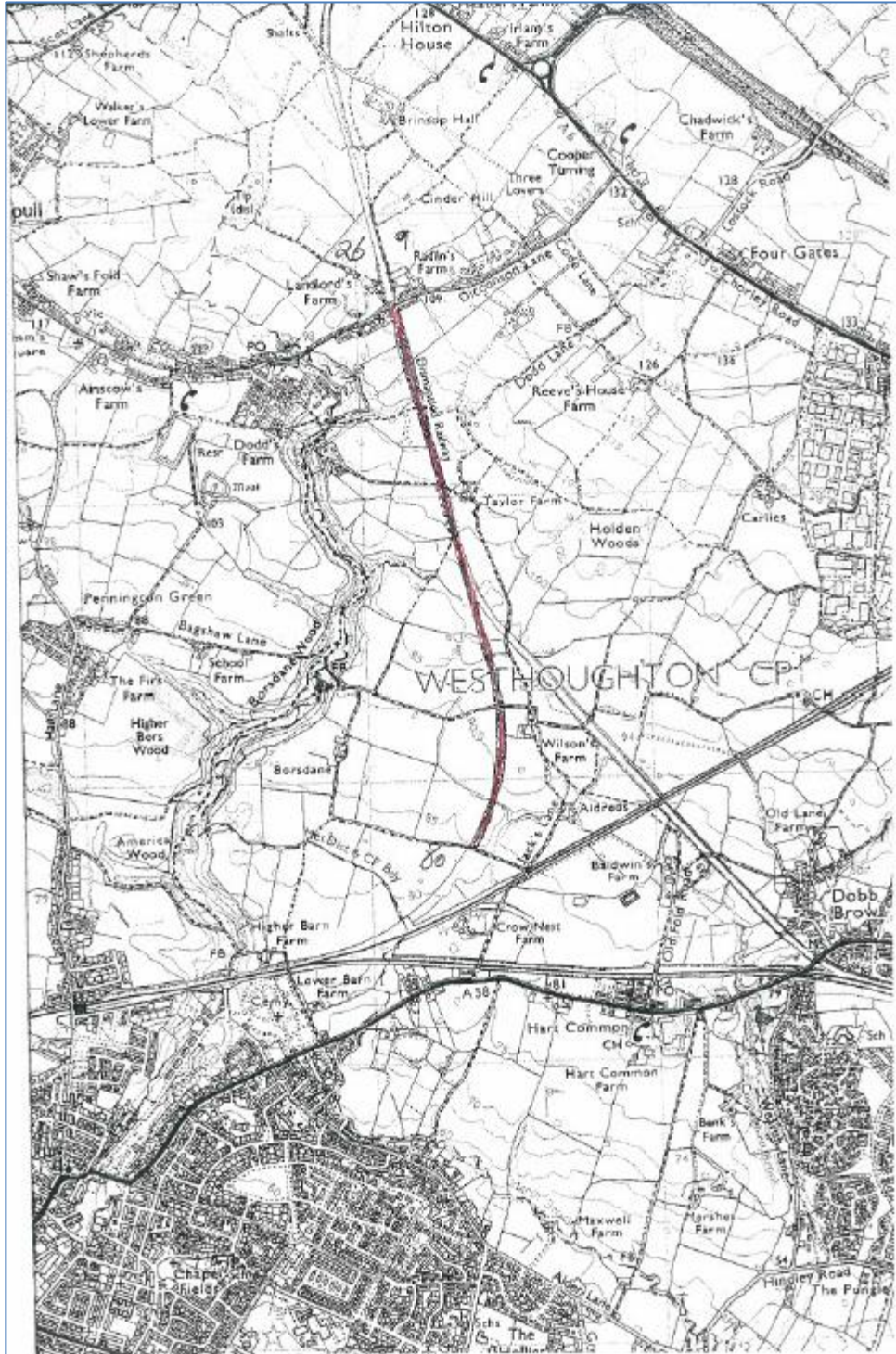

Date: 09/2009

Index Number 2009 0902

Fern Street to River Croal

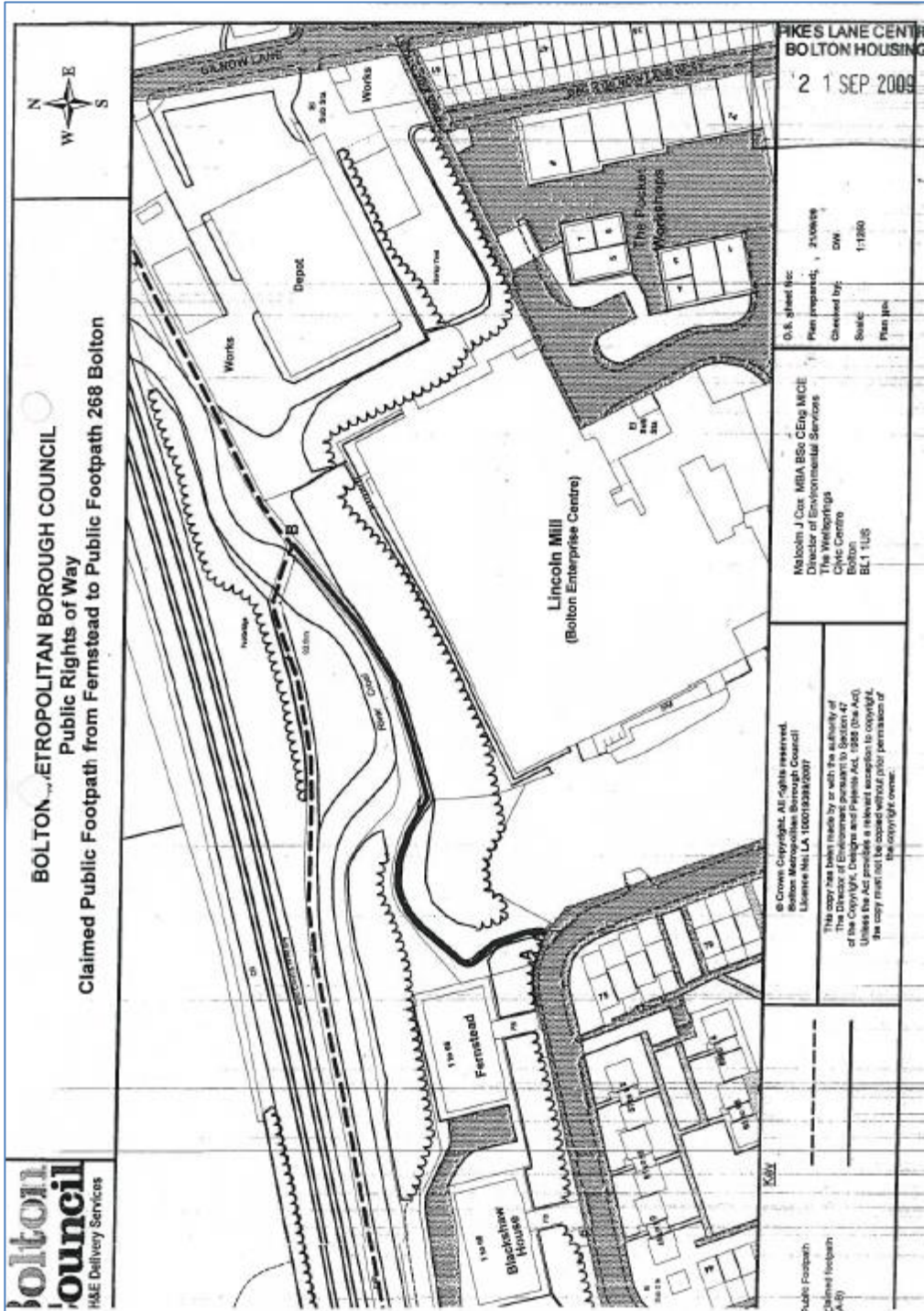

Date: 12/2010

File Number 301077

High Bank Street to Leverhulme Park via Edditch Farm

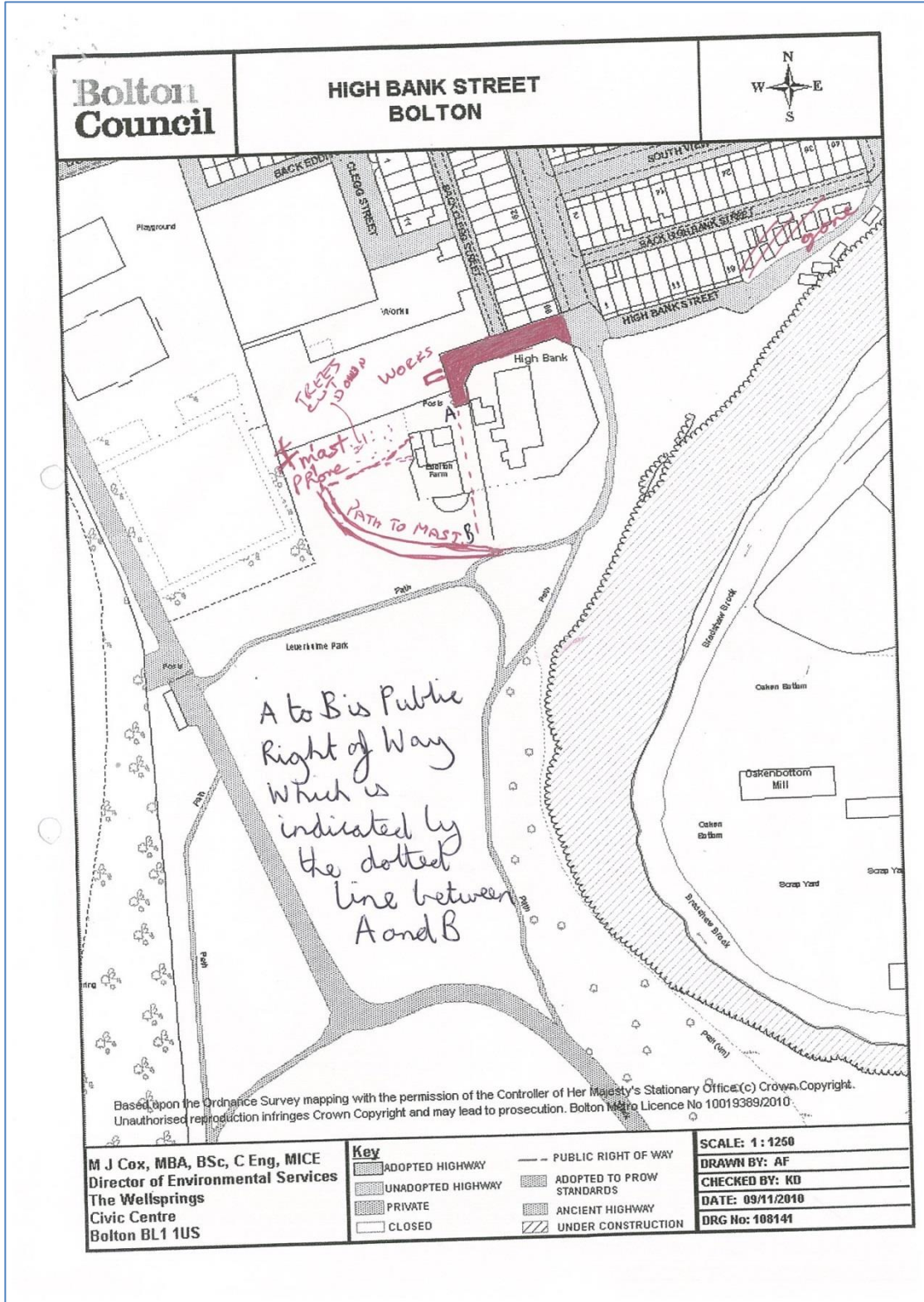



Date: 03/2011

File Number 301082

Druids Close to Chapel Street, Egerton via s/o 22A Druids Close

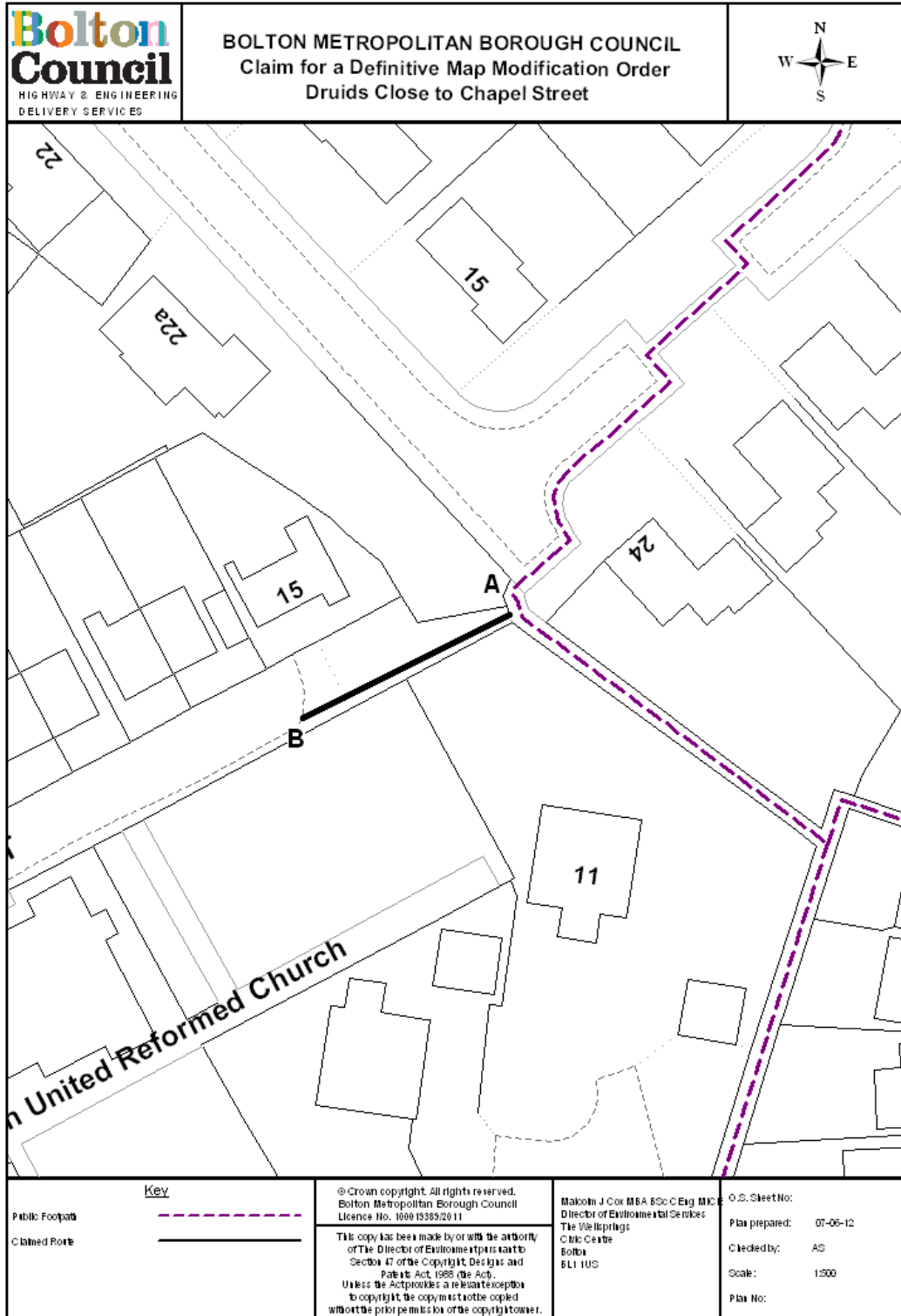

Date: 03/2014

Index Number 201403

Regents Park Golf Course – Footpath from St Andrews Road to the Restricted Byway across the golf course

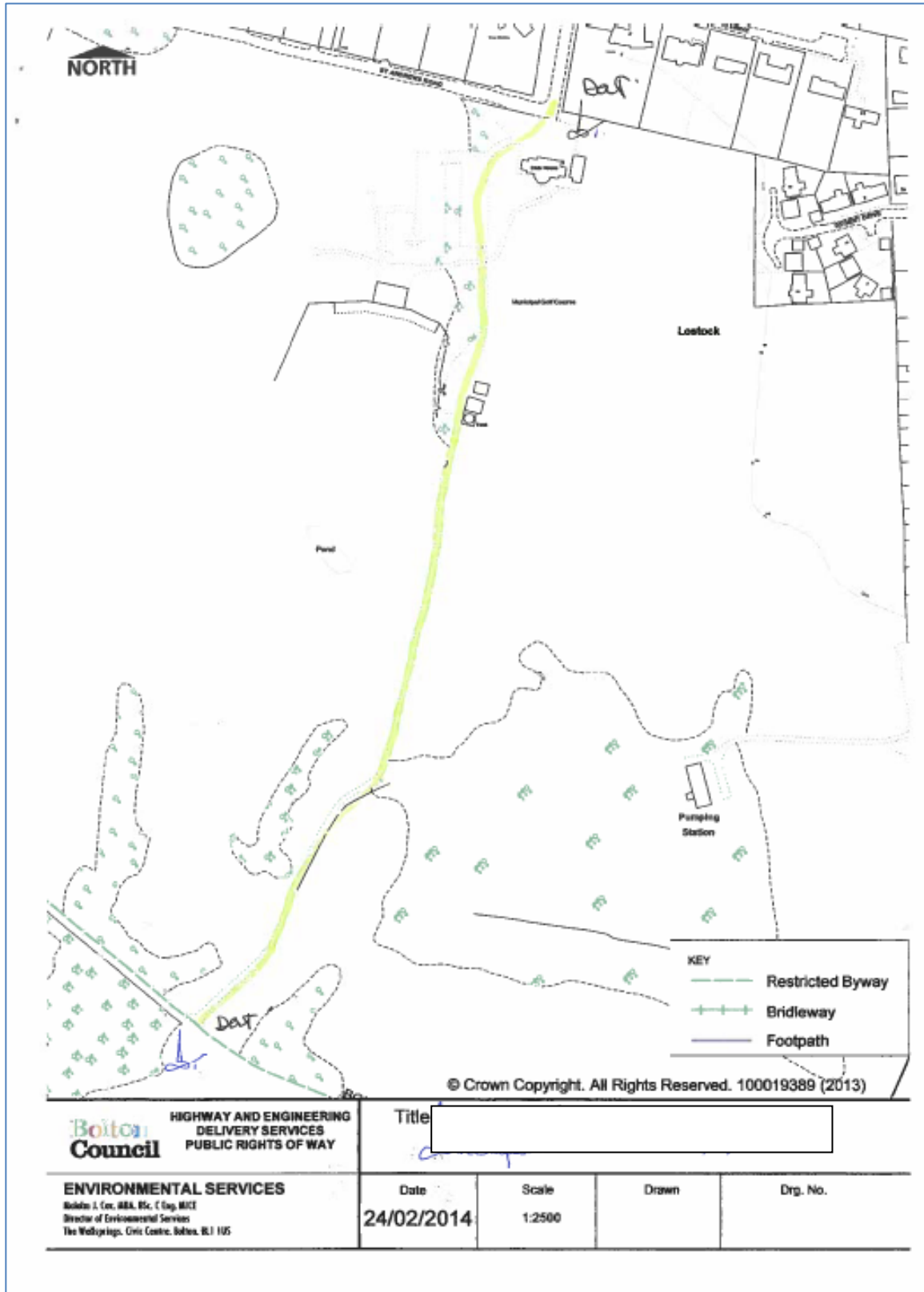

Date: 06/2014

Index Number 201406

233/235 Leigh Road – Leigh Road to the back street at the rear of 233/235 Leigh Road

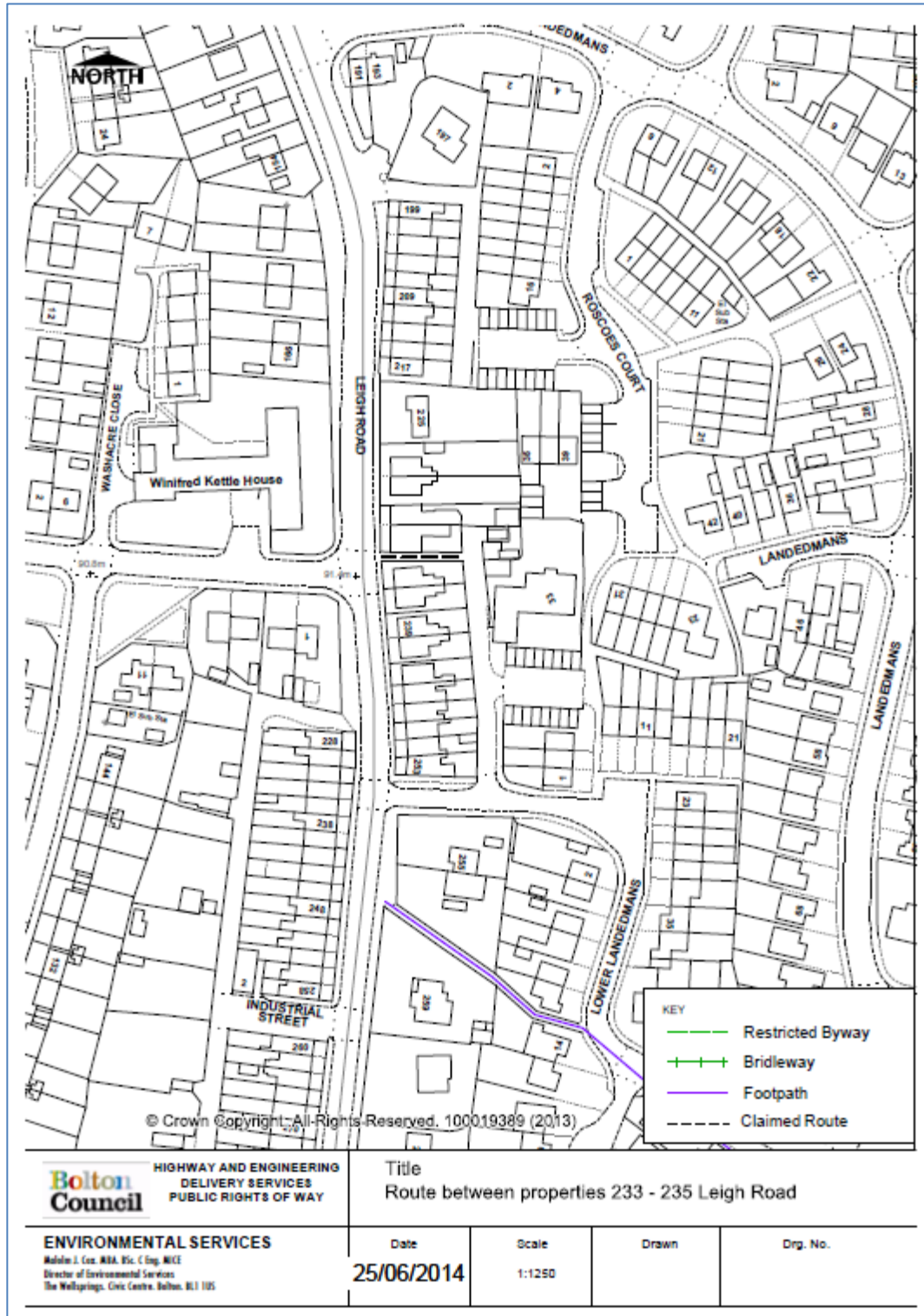

Date: 01/2018

Index Number 201801

Millennium Wood - Longsight Lane to public footpath TBS043

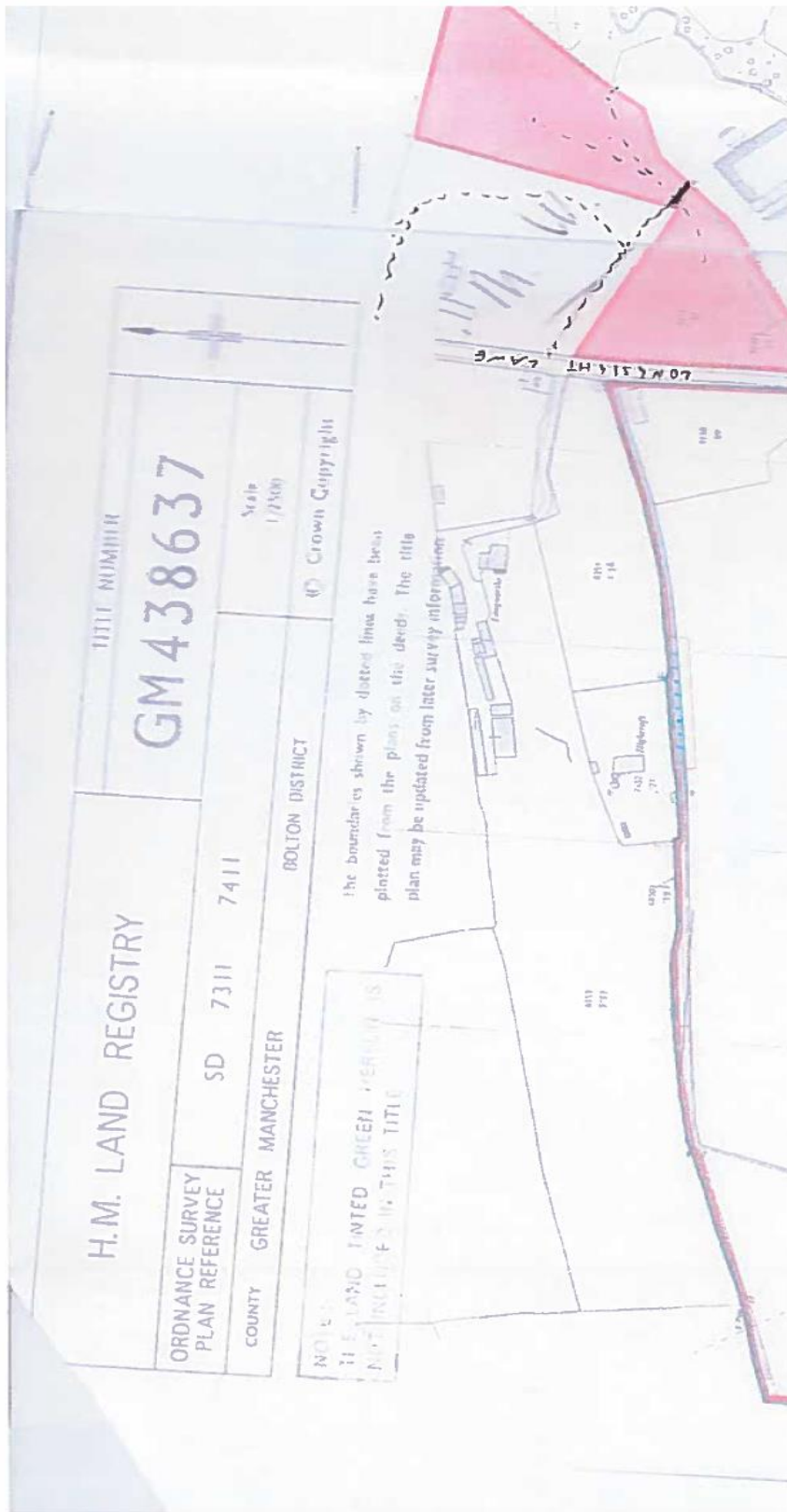

FROM LAND REGISTRY DOC  
I HAVE PUT MW FOR  
MILLENNIUM WOOD & A BACKLINE  
WHICH I THINK RECORDS THE  
MILLENNIUM WOOD PART

Date: 08/2018

Index Number 201808

Lakenheath Drive – Path off Lakenheath Drive to Hill Cot Road Route A-B; Route A-C and Route A-D

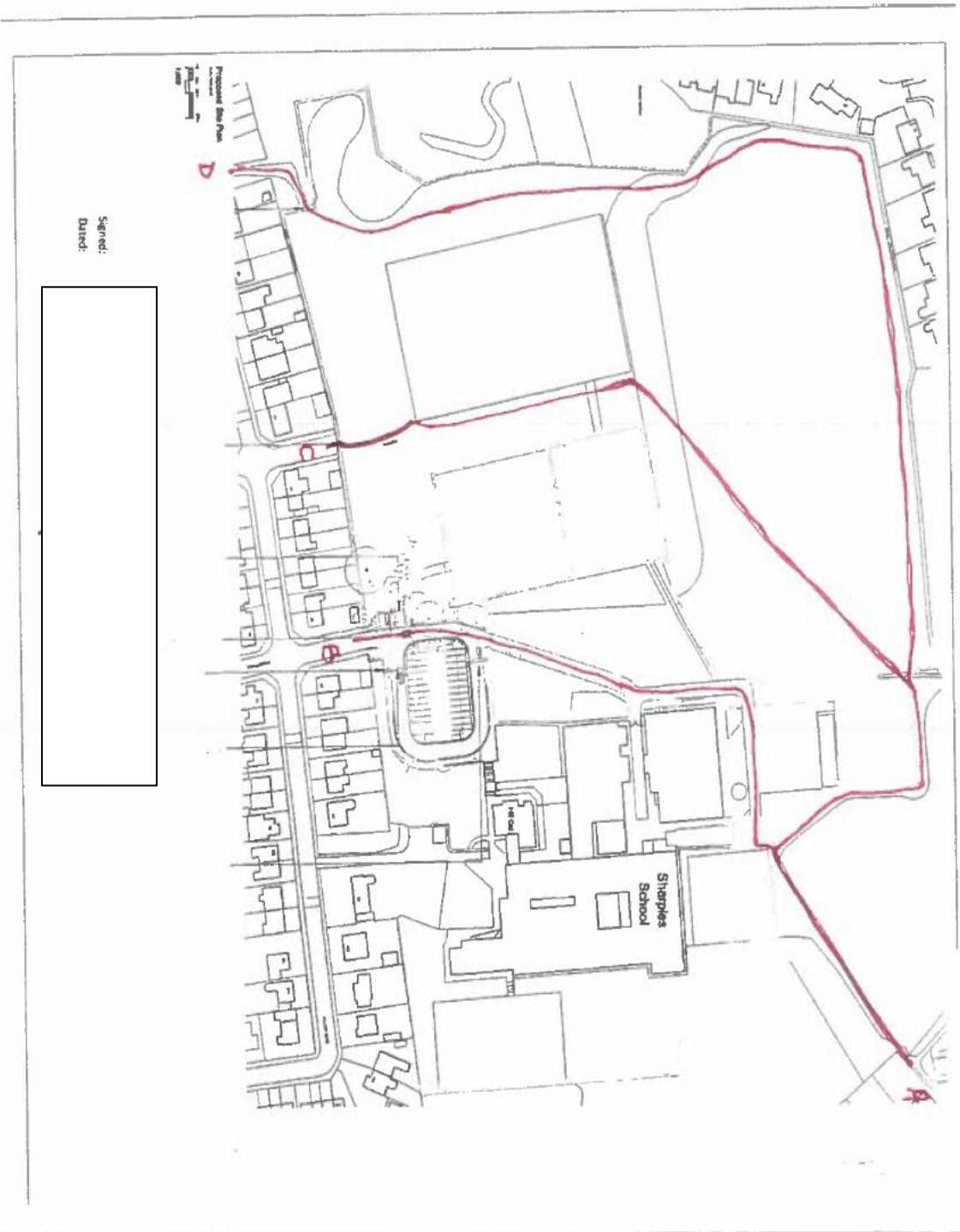

Date: 09/2023

Index Number 231209

Longsight Lane to junction with field and corner of Millenium Wood

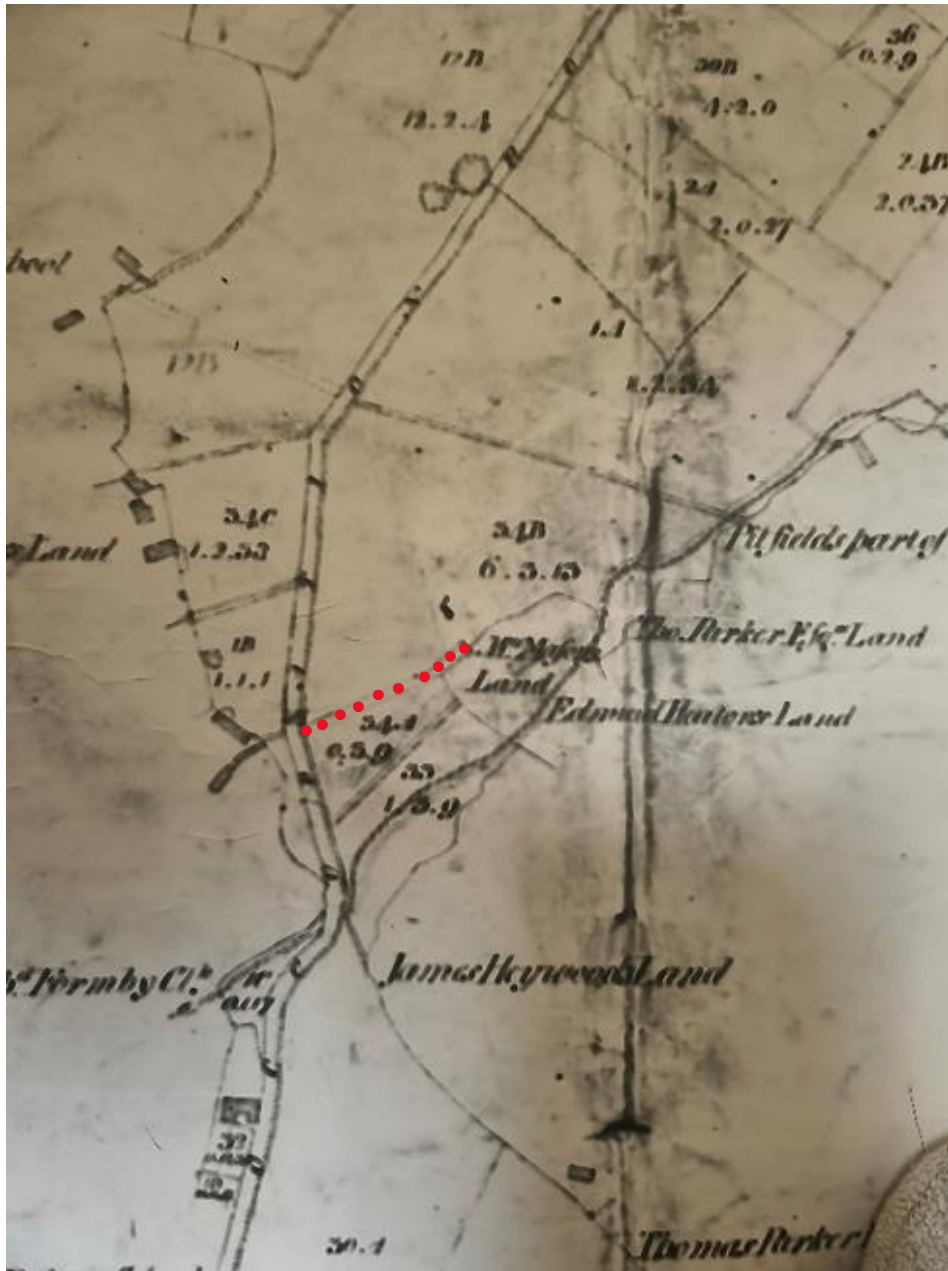

Date: 08/2024

Index Number 240808

Riding Gate to Lower Knotts Cottage

